

EST 25

950g/UN

■ PRODUCT

| | | |
|---------------------------|---------------------------------------------------------------------------|-------|
| Nominal Capacity (litres) | 25,0 | ±2.0% |
| Brimful Capacity (litres) | 27,6 | ±2.0% |
| Nominal Tare Weight (g): | 950 g | ±5.0% |
| Body Material | High Molecular Weight HD Polyethylene | |
| Embossings | Date, Recycling symbol, Manufacturers sign food grade symbol available | |

■ APPROVALS

| | |
|------------|------------------------------|
| UN marking | 3H1/Y1.9/200/**/B/AST-040068 |
|------------|------------------------------|

■ BODY DIMENSIONS

| | | |
|--------------------|-----------------|----------|
| L Length | 296 mm | ± 6.0 mm |
| B Width | 258 mm | ± 6.0 mm |
| H1 Stacking Height | 456 mm | ± 6.0 mm |
| H2 Total Height | 463 mm | ± 6.0 mm |
| Label Panel | 215 mm x 290 mm | ± 6.0 mm |

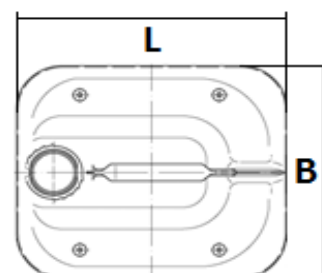
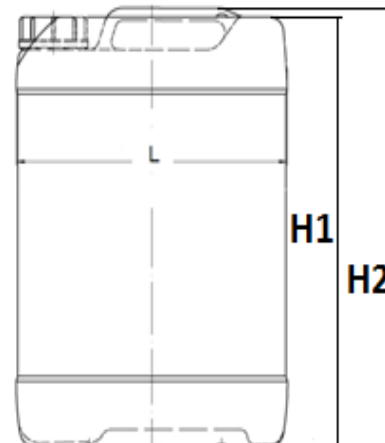

■ NECK TYPE

| | | |
|-----------------------------|---------|---------|
| Height (h1) | 22,4 mm | ±1.0 mm |
| External diameter (d1) | 59,0 mm | ±1,5 mm |
| Internal diameter (d2) | 54,0 mm | ±1,5 mm |
| Internal neck diameter (d3) | 48,5 mm | ±1,5 mm |
| Pitch of Thread | 6 | |

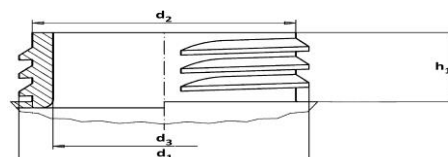

■ CLOSURE SYSTEM

| | |
|-------|---------------------------------------|
| Type: | Screw cap neck no. 61, made from HDPE |
|-------|---------------------------------------|

■ SHIPPING

| | Variante 1 | Variante 2 |
|------------------------------------|------------|----------------------|
| Pallet dimensions | 800 x 1200 | 800 x 1200 |
| Drums quantity on one layer | 12 | 12 |
| Layers of drums on one pallet | 6 | 3 + 2 |
| Drums quantity on one pallet | 72 | 60 |
| Pallets quantity in one full truck | 38 | 76 |
| Palletisation height | ca. 2,90 m | ca. 1,53 m/ca.2,60 m |
| Quantity in one full truck load | 2.736 | 2.280 |

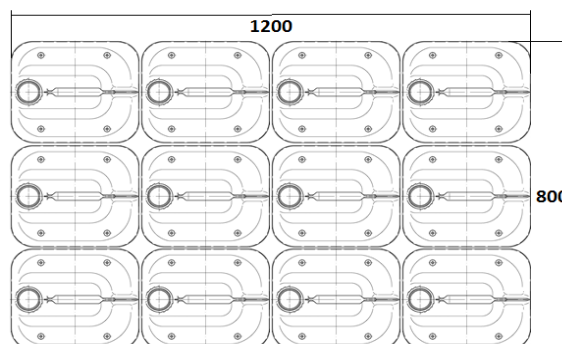

■ ADDITIONAL DETAILS

The statements in this confirmation are based on our present knowledge and experience. They do not free the user of our packaging – systems from own tests. A legally binding assurance cannot be diverted out of our statements. Existing laws and determinations must be minded from customer in own responsibility.

Q- Document

EST 25 950g e.001

Datum:

29.04.2017

Freigabe: D. Strohmann