

CONTACTOR, 55KW/400V/AC-3,
AC(40...60HZ)/DC OPERATION UC 440...480V AUXIL.
CONTACTS 2NO+2NC 3-POLE,
SIZE S6 BAR CONNECTIONS CONVENTIONAL
OPERATING MECHAN. SCREW TERMINAL

General details:		
Product brand name		SIRIUS
product designation		power contactor
Size of the contactor		S6
Protection class IP / on the front		IP00
Degree of pollution		3
Installation altitude / at a height over sea level / maximum	m	2,000
Ambient temperature / during operating	°C	-25 ... +60
Active power loss / per conductor / typical	W	7
Item designation		Q K
<ul style="list-style-type: none"> • according to DIN EN 61346-2 • according to DIN 40719 extendable after IEC 204-2 / according to IEC 750 		
Mechanical operating cycles as operating time		
<ul style="list-style-type: none"> • of the contactor / typical 		10,000,000
<ul style="list-style-type: none"> • of the contactor with added auxiliary switch block / typical 		10,000,000
<ul style="list-style-type: none"> • of the contactor with added electronics-compatible auxiliary switch block / typical 		5,000,000
Main circuit:		
Number of poles / for main current circuit		3
Number of NC contacts / for main contacts		0
Number of NO contacts / for main contacts		3
Operating current / at AC-1 / at 400 V / at 40 °C ambient temperature / rated value	A	160
Operating current / at AC-1 / at 400 V / at 60 °C ambient temperature / rated value	A	140
Operating current		
<ul style="list-style-type: none"> • at AC-3 / at 400 V / rated value • with 1 current path • at DC-1 • at 24 V / rated value 	A	115
	A	160

<ul style="list-style-type: none"> • at 110 V / rated value 	A	18
<ul style="list-style-type: none"> • at DC-3 / at DC-5 	A	160
<ul style="list-style-type: none"> • at 24 V / rated value 	A	2.5
<ul style="list-style-type: none"> • at 110 V / rated value 		
<ul style="list-style-type: none"> • with 2 current paths in series 		
<ul style="list-style-type: none"> • at DC-1 		
<ul style="list-style-type: none"> • at 24 V / rated value 	A	160
<ul style="list-style-type: none"> • at 110 V / rated value 	A	160
<ul style="list-style-type: none"> • at DC-3 / at DC-5 		
<ul style="list-style-type: none"> • at 24 V / rated value 	A	160
<ul style="list-style-type: none"> • at 110 V / rated value 	A	160
<ul style="list-style-type: none"> • with 3 current paths in series 		
<ul style="list-style-type: none"> • at DC-1 		
<ul style="list-style-type: none"> • at 24 V / rated value 	A	160
<ul style="list-style-type: none"> • at 110 V / rated value 	A	160
<ul style="list-style-type: none"> • at DC-3 / at DC-5 		
<ul style="list-style-type: none"> • at 24 V / rated value 	A	160
<ul style="list-style-type: none"> • at 110 V / rated value 	A	160
Service power		
<ul style="list-style-type: none"> • at AC-1 / at 400 V / rated value 	kW	92
<ul style="list-style-type: none"> • at AC-2 / at 400 V / rated value 	kW	64
<ul style="list-style-type: none"> • at AC-3 		
<ul style="list-style-type: none"> • at 400 V / rated value 	kW	55
<ul style="list-style-type: none"> • at 500 V / rated value 	kW	81
<ul style="list-style-type: none"> • at 690 V / rated value 	kW	11.3

Control circuit:

Design of activation		conventional
Design of the surge suppressor		with varistor
Type of voltage / of the controlled supply voltage		AC/DC
Control supply voltage frequency		
<ul style="list-style-type: none"> • 1 / rated value 	Hz	40
<ul style="list-style-type: none"> • 2 / rated value 	Hz	60
Control supply voltage / 1		
<ul style="list-style-type: none"> • for DC 		
<ul style="list-style-type: none"> • initial rated value 	V	440
<ul style="list-style-type: none"> • final rated value 	V	480
<ul style="list-style-type: none"> • at 50 Hz / for AC 		
<ul style="list-style-type: none"> • initial rated value 	V	440
<ul style="list-style-type: none"> • final rated value 	V	480

- at 60 Hz / for AC
 - initial rated value
 - final rated value

V	440
V	480

Auxiliary circuit:

Contact reliability / of the auxiliary contacts		1 faulty switching per 100 million (17 V, 1 mA)
Number of NC contacts / for auxiliary contacts		
<ul style="list-style-type: none"> • instantaneous switching • lagging switching 		2 0
Number of NO contacts / for auxiliary contacts		
<ul style="list-style-type: none"> • instantaneous switching • leading switching 		2 0
Operating current / of the auxiliary contacts		
<ul style="list-style-type: none"> • at AC-12 / maximum • at AC-15 <ul style="list-style-type: none"> • at 230 V • at 400 V • at DC-12 <ul style="list-style-type: none"> • at 60 V • at 110 V • at 220 V • at DC-13 <ul style="list-style-type: none"> • at 24 V • at 60 V • at 110 V • at 220 V 	A A A A A A A A A A	10 6 3 6 3 1 10 2 1 0.3

Short-circuit:

Design of the fuse link		
<ul style="list-style-type: none"> • for short-circuit protection of the auxiliary switch / required • for short-circuit protection of the main circuit <ul style="list-style-type: none"> • with type of assignment 1 / required • at type of coordination 2 / required 		fuse gL/gG: 10 A fuse gL/gG: 355 A fuse gL/gG: 315 A

Installation/mounting/dimensions:

Type of mounting		screw fixing
series installation		Yes
Width	mm	120
Height	mm	172
Depth	mm	170
Distance, to be maintained, to earthed part / sideways	mm	10

Connection type:

Design of the electrical connection

- for main current circuit
- for auxiliary and control current circuit

screw-type terminals

screw-type terminals

Identification number and letter for switching elements

22 E

Certificates/approvals:

General Product Approval

Functional Safety / Safety of Machinery



CQC



CSA

[KETI](#)

[ROSTEST](#)



UL

[SUVA](#)

Test Certificates

Shipping Approval

other

[Manufacturer](#)



ABS



DNV



GL

[Manufacturer](#)

[other](#)

Further information:

Information- and Downloadcenter (Catalogs, Brochures,...)

<http://www.siemens.com/industrial-controls/catalogs>

Industry Mall (Online ordering system)

<http://www.siemens.com/industrial-controls/mall>

CAX-Online-Generator

<http://www.siemens.com/cax>

Service&Support (Manuals, Certificates, Characteristics, FAQs,...)

<http://support.automation.siemens.com/WW/view/en/3RT1054-6AR36/all>

Image database (product images, 2D dimension drawings, 3D models, device circuit diagrams, ...)

http://www.automation.siemens.com/bilddb/cax_en.aspx?mlfb=3RT1054-6AR36

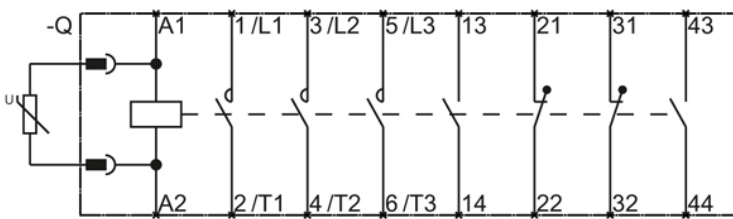
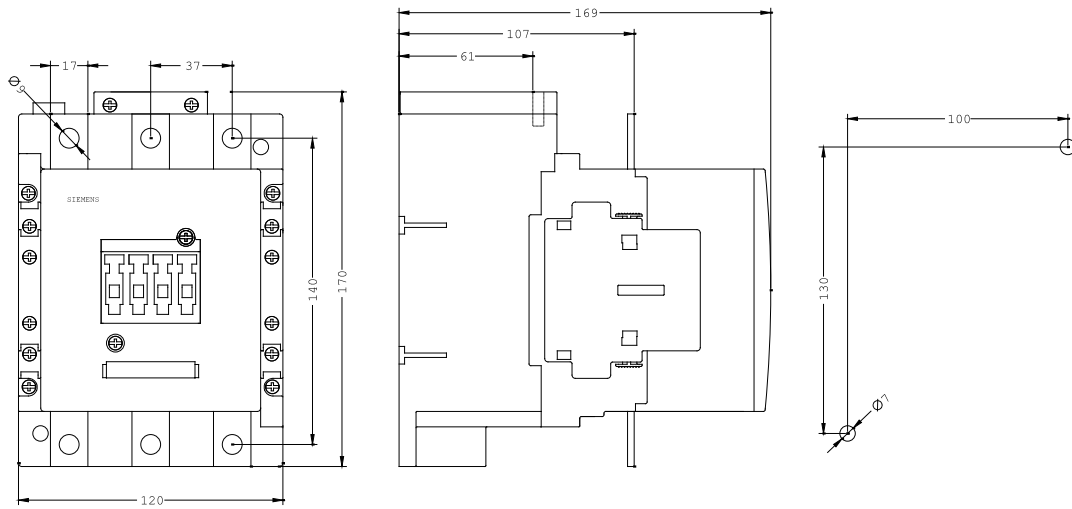

last change:

Sep 30, 2011