



SCANTOOL

Industrivej 3-9
DK-9460 Brovst
Tlf.: +45 98236088
Fax.: +45 98236144

Manual

SCANTOOL PFS1

HAND SHEARER OPERATION MANUAL

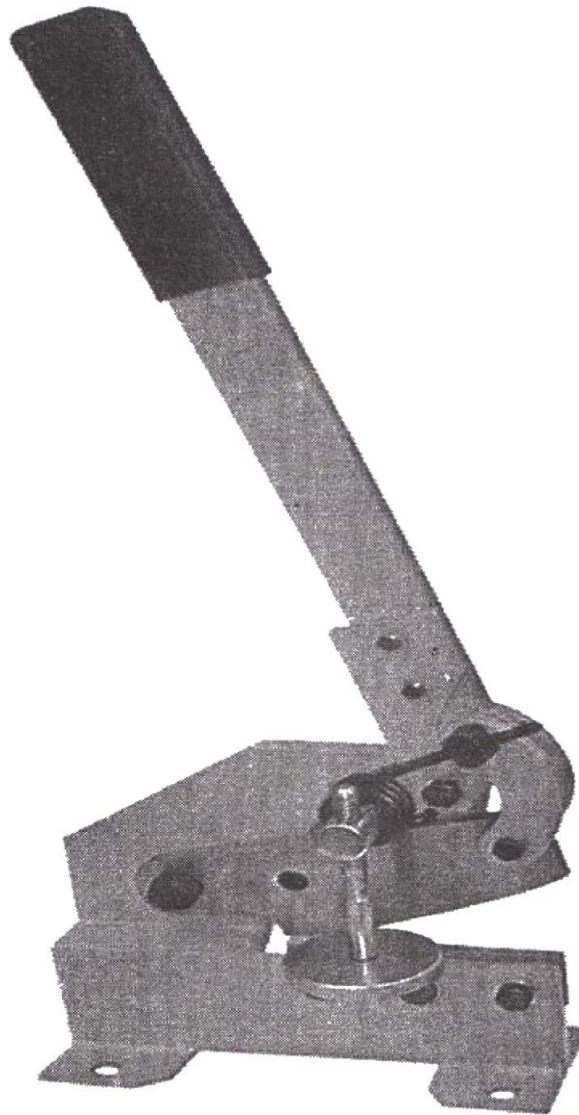

CE

UK

EC declaration of conformity



SCANTOOL A/S

Industrivej 3-9

9460 Brovst

Denmark

www.scantool.com

Ph: +45 98 23 60 88

Fax.: +45 98 23 61 44

hereby declares that

SCANTOOL PFS 1 HAND SHEARER are manufactured in accordance with the provisions of the COUNCIL DIRECTIVE of 17. May 2006 (2006/42/EC) – The Machinery Directive (order no. 561 of 25 June 1994 with subsequent amendments)

2006/42/EC:

Directive on machinery-safety

2004/108/EC:

Directive on Electromagnetic Compatibility

2006/95/EC:

Low Voltage Equipment Safety directive

Also on accordance with:

- The council directive of 19 February 1973 (73/23/EEC) – The Low Voltage Directive – with later amendments (order no. 797 of 30 August 1994)
- The council directive of 3 May 1989 (89/336/EEC) – The EMC Directive – with later amendments (order no. 796 of 5 December 1991 with subsequent amendments)

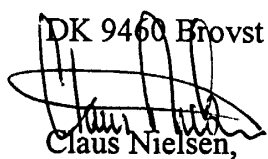
DK 9460 Brovst

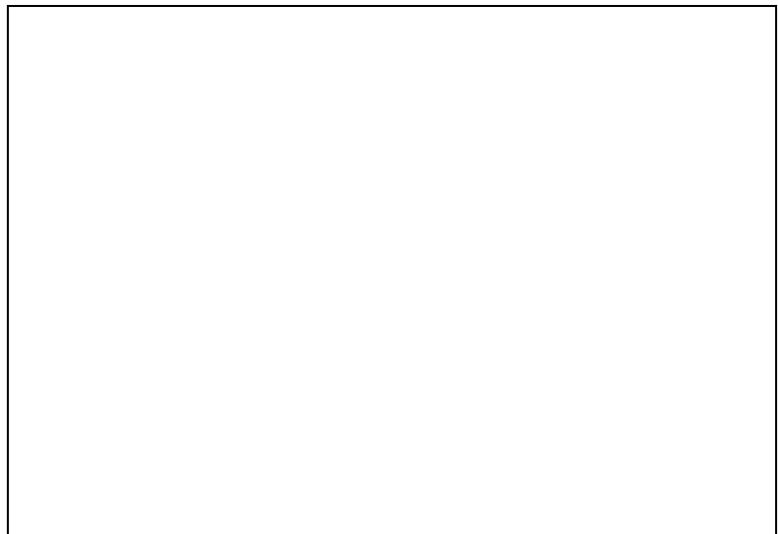
Claus Nielsen,
Producent







Please read this manual carefully before install and operation.

1. Usage

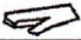
This machine is suitable for shearing carbon steel plate and bar. It can be used to shear non-ferrous metal or plastic and bar.

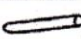
2. Main technical specification

Model	HS-5	HS-6	HS-8	HS-10	HS-12
 mm(in)	6(1/4")	6(1/4")	6(1/4")	6(1/4")	6(1/4")
 mm(in)	70×6 (2 ³ / ₄ "×1/4")	70×6 (2 ³ / ₄ "×1/4")	70×6 (2 ³ / ₄ "×1/4")	70×6 (2 ³ / ₄ "×1/4")	70×6 (2 ³ / ₄ "×1/4")
 mm(in)	11(7/16")	11(7/16")	12(1/2")	13(1/2")	13(1/2")
 mm(in)	125(5')	150(6')	200(8')	250(10')	300(12')
 kg	12	14	18	23	28

3. Installation and caution

3.1 Installation

- 3.1.1 Please check whether the part of this machine are fully equipped and not damaged to the parts list or part figure.
- 3.1.2 This machine should be mounted on hard ground or specific place (not supplied).
- 3.1.3 Please leave plenty room around the machine for your easy operating, in order to avoid injury.
- 3.1.4 Please remove the anti-rust grease on processing surfaces and some parts included with kerosene.

3.2 Caution

- 3.2.1 Please read the manual before operation and make yourself understand its structure and principle completely.
- 3.2.2 Please do not operate the material width and thickness than table list max.range.
- 3.2.3 When you shear the plate or bar which list in above table, you must be used lengthen handle in order to increase force.
- 3.2.4 Please do not touch the blade during operation.

4. Operation and maintenance

This machine is pre-adjusted before out of factory. When you want to shear, please raise handle (9#), the upper blade (4#) will put up, insert the workpiece, then lower the handle (9#) to shear.

Before you shearing, you can adjust disc (12#) to press the workpiece.

5. Lubricate the rotating parts of the machine every day.

6. Parts list

Part#	Description	Qty.	Part#	Description	Qty.
1	shaft	1	12	disc	1
2	spring	1	13	screw	2
3	bolt	1	14	rocker	1
4	upper blade	1	15	bolt	3
5	body	1	16	washer	3
6	nut	2	17	nut	2
7	sleeve	1	18	lower blade	1
8	screw	1	19	rocker	1
9	handle	1	20	nut	2
10	lever	1	21	washer	2
11	bolt	2			

7.Assembly diagram

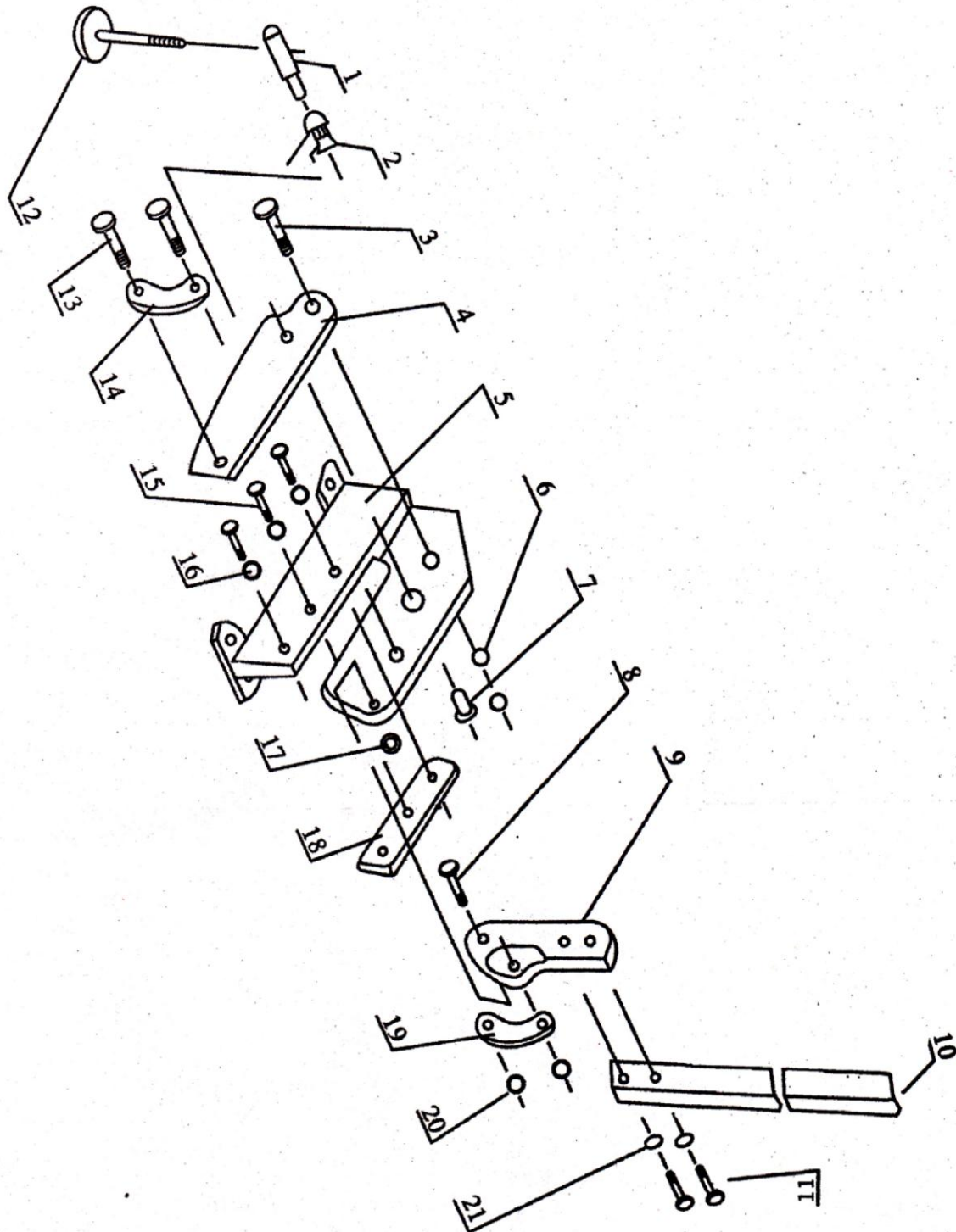

6.0 Guarantee

If within 2 year of purchase this machine supplied by SCANTOOL A/S becomes defective due to faulty materials or workmanship we guarantee to repair or replace the machine or defective part or parts free of charge provided that:

1. The product is returned complete to one of our Service Branches or Official Service Agents.
2. The product has not been misused or carelessly handled and in particular has not been used in a manner contrary to the operating instructions.
3. Repairs have not been made or attempted by other than our own Service Staff or the staff of our Official Service Agents.
4. Documentary proof of purchase date is produced when the goods are handed in or sent for repair.
5. Wear parts are not covered by the warranty