



SIRIUS SOFT STARTER, SIZE S0, 32A,
15KW/400V, 40 DEGREES, 200-480V AC,
110-230V AC/DC, SPRING-LOADED TERMINALS

General details:

| | | |
|--|--|--------|
| Product brand name | | SIRIUS |
| Product equipment | | |
| • integrated bridging contact system | | Yes |
| • thyristors | | Yes |
| Product function | | |
| • intrinsic device protection | | No |
| • motor overload protection | | No |
| • evaluation of thermal resistor motor protection | | No |
| • reset external | | No |
| • adjustable current limitation | | No |
| • inside-delta circuit | | No |
| Product component / outlet for enine brake | | No |
| Item designation | | |
| • according to DIN EN 61346-2 | | Q |
| • according to DIN 40719 extendable after IEC 204-2 / according to IEC 750 | | G |

Power Electronics:

| | | |
|----------------------------|--|---|
| product designation | | soft starters for standard applications |
| Operating current | | |

| | | |
|---|----|-------------|
| • at 40 °C / rated value | A | 32 |
| • at 50 °C / rated value | A | 29 |
| • at 60 °C / rated value | A | 26 |
| Emitted mechanical power / for three-phase servomotors | | |
| • at 230 V / at standard switching / at 40 °C | | |
| • rated value | W | 7,500 |
| • at 400 V / at standard switching / at 40 °C | | |
| • rated value | W | 15,000 |
| yielded mechanical performance (hp) / for three-phase squirrel cage motors / at 200/208 V / at standard circuit / at 50 °C / rated value | hp | 7.5 |
| Operating frequency | | |
| • rated value | Hz | 50 ... 60 |
| Relative negative tolerance / of the operating frequency | % | -10 |
| Relative positive tolerance / of the operating frequency | % | 10 |
| Operating voltage / with standard circuit / rated value | V | 200 ... 480 |
| Relative negative tolerance / of the operating voltage / with standard circuit | % | -15 |
| Relative positive tolerance / of the operating voltage / with standard circuit | % | 10 |
| Minimum load in % of I_M | % | 10 |
| Continuous operating current in % of I_e / at 40°C | % | 115 |
| Active power loss / at operating current / at 40°C / during operating phase / typical | W | 13 |

| Control electronics: | | |
|--|----|-------------|
| Type of voltage / of the controlled supply voltage | | AC/DC |
| Control supply voltage frequency / 1 / rated value | Hz | 50 |
| Control supply voltage frequency / 2 / rated value | Hz | 60 |
| Relative negative tolerance / of the control supply voltage frequency | % | -10 |
| Relative positive tolerance / of the control supply voltage frequency | % | 10 |
| Control supply voltage / 1 / at 50 Hz / for AC | V | 110 ... 230 |
| Control supply voltage / 1 / at 60 Hz / for AC | V | 110 ... 230 |
| Relative negative tolerance / of the control supply voltage / at 60 Hz / for AC | % | -15 |
| Relative positive tolerance / of the control supply voltage / at 60 Hz / for AC | % | 10 |
| Control supply voltage / 1 / for DC | V | 110 ... 230 |
| Relative negative tolerance / of the control supply voltage / for DC | % | -15 |

| | | |
|---|---|-----|
| Relative positive tolerance / of the control supply voltage / for DC | % | 10 |
| Type of display / for fault signal | | red |

Mechanical design:

| | | |
|---|----|--|
| Size of the engine control device | | S0 |
| Width | mm | 45 |
| Height | mm | 150 |
| Depth | mm | 150 |
| Type of mounting | | screw and snap-on mounting |
| Built in orientation | | With vertical mounting surface +/-10° rotatable, with vertical mounting surface +/- 10° tiltable to the front and back |
| Distance, to be maintained, to the ranks assembly | | |
| • upwards | mm | 60 |
| • sideways | mm | 15 |
| • downwards | mm | 40 |
| Altitude of installation site / at a height over sea level | m | 5,000 |
| Cable length / maximum | m | 300 |
| Number of poles / for main current circuit | | 3 |

Electrical connections:

| | | |
|---|--|--|
| Design of the electrical connection | | |
| • for main current circuit | | spring-loaded terminals |
| • for auxiliary and control current circuit | | spring-loaded terminals |
| Number of NC contacts / for auxiliary contacts | | 0 |
| Number of NO contacts / for auxiliary contacts | | 1 |
| Number of change-over switches / for auxiliary contacts | | 0 |
| Type of the connectable conductor cross section / for main contacts / for box terminal / when using the front clamping point | | |
| • solid | | 2x (1 ... 2.5 mm²), 2x (2.5 ... 6 mm²) |
| • finely stranded / with conductor end processing | | 2x (1 ... 2.5 mm²), 2x (2.5 ... 6 mm²) |
| Type of the connectable conductor cross-section / for AWG conductors / for main contacts / for box terminal | | |
| • when using the front clamping point | | 1x 8, 2x (16 ... 10) |
| Type of the connectable conductor cross-section | | |
| • for main contacts | | |
| • solid | | 1 ... 10 mm² |
| • finely stranded / with conductor end processing | | 1 ... 6 mm² |
| • for AWG conductors / for main contacts | | 16 ... 8 |
| Type of the connectable conductor cross-section | | |

- for auxiliary contacts
 - solid
 - finely stranded / with conductor end processing
- for AWG conductors / for auxiliary contacts

| |
|-----------------------|
| 2x (0.25 ... 2.5 mm²) |
| 2x (0.25 ... 1.5 mm²) |
| 2x (24 ... 14) |

Ambient conditions:

Ambient temperature

- during operating
- during storage

| | |
|----|------------|
| °C | -25 ... 60 |
| °C | -40 ... 80 |

Derating temperature

| | |
|----|----|
| °C | 40 |
|----|----|

Protection class IP

| |
|------|
| IP20 |
|------|

Certificates/approvals:

General Product Approval



CQC



CSA

[ROSTEST](#)



UL

Test Certificates

[Manufacturer](#)

Shipping Approval



DNV



GL

other

[Manufacturer](#)

UL/CSA ratings

yielded mechanical performance (hp) / for three-phase squirrel cage motors

- at 220/230 V / at standard circuit
 - at 50 °C / rated value
- at 460/480 V / at standard circuit
 - at 50 °C / rated value

| | |
|----|-----|
| hp | 7.5 |
| hp | 20 |

Further information:

Information- and Downloadcenter (Catalogs, Brochures,...)

<http://www.siemens.com/industrial-controls/catalogs>

Industry Mall (Online ordering system)

<http://www.siemens.com/industrial-controls/mall>

CAX-Online-Generator

<http://www.siemens.com/cax>

Service&Support (Manuals, Certificates, Characteristics, FAQs,...)

<http://support.automation.siemens.com/WW/view/en/3RW3027-2BB14/all>

Image database (product images, 2D dimension drawings, 3D models, device circuit diagrams, ...)

http://www.automation.siemens.com/bilddb/cax_en.aspx?mlfb=3RW3027-2BB14

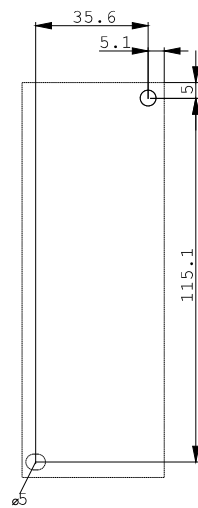
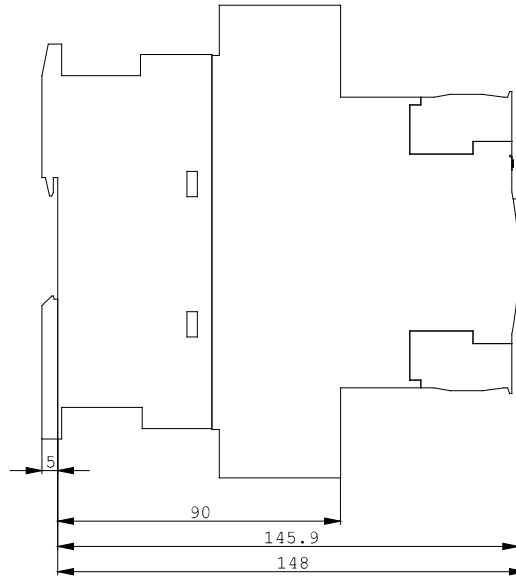
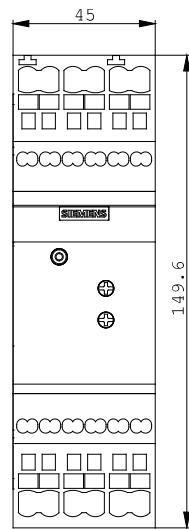

last change:

Oct 24, 2011