

SITOR SET OF FUSES DUTY CLASS GR,  
DIN 43620 850A, 400V AC (SIZE 3)



Similar to image

### Technical data:

product brand name		SETRON
Current / for AC / rated value	A	850
Operating class of the fuse link		gR
Size of the fallback-system / acc. to DIN EN 60269-1		NH3
Supply voltage		
• for AC / rated value	V	690
Switching capacity current		
• in accordance with IEC 60947-2 / rated value	kA	100
Design of the fuse link		SITOR, LV HRC design
Design of an identification indicator		others
mounting position		Any, preferably vertical
Climatic class		-20 to +50 at 95% relative humidity
Ambient temperature	°C	-20 ... +50
Varying load factor (WL)		1
Resistive loss	W	76
Active power loss / at rated value current / with AC / in warm operating state / per pole	W	76
Item designation / according to DIN EN 61346-2		F

Item designation / according to DIN EN 81346-2

F

#### Certificates/approvals:

##### General Product Approval

##### Declaration of Conformity



#### Further information:

##### Information- and Downloadcenter (Catalogs, Brochures,...)

<http://www.siemens.com/lowvoltage/catalogs>

##### Industry Mall (Online ordering system)

<http://www.siemens.de/lowvoltage/mall>

##### Service&Support (Manuals, Certificates, Characteristics, FAQs,...)

<http://support.automation.siemens.com/WW/view/en/3NE1448-2/all>

##### Image database (product images, 2D dimension drawings, 3D models, device circuit diagrams, ...)

[http://www.automation.siemens.com/bilddb/cax\\_en.aspx?mlfb=3NE1448-2](http://www.automation.siemens.com/bilddb/cax_en.aspx?mlfb=3NE1448-2)

##### CAX-Online-Generator

<http://www.siemens.com/cax>

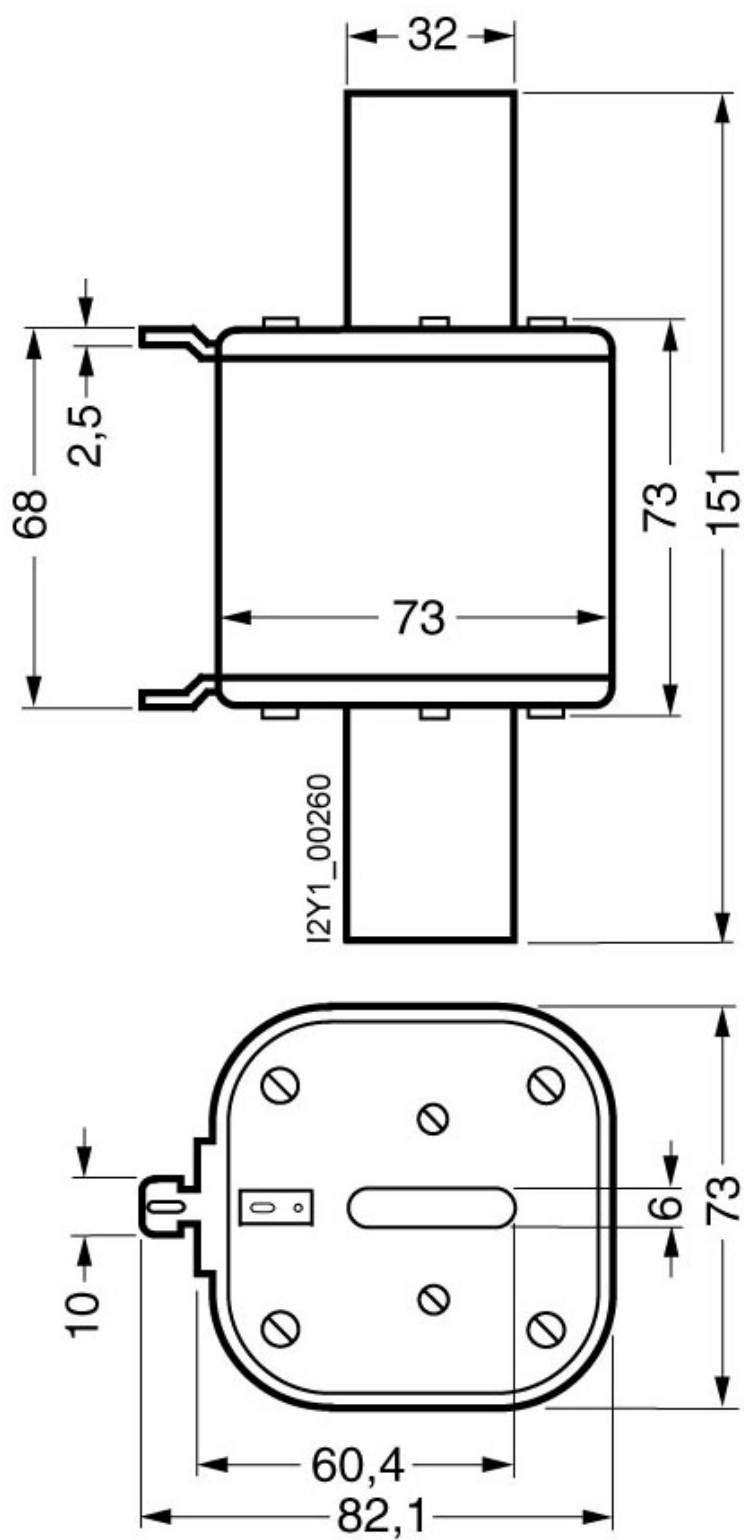

last change:

Feb 24, 2014