



SURGE SUPPRESSOR,
SUPPRESSION DIODE WITH LED,
DC 150...250V,
F. CONT. RELAYS A. MOTOR CONT. SZ S00,

General technical data:

product brand name		SIRIUS
product designation		surge suppressor
Size of the contactor		S00
Design of the surge suppressor		with diode
Ambient temperature		
• during storage	°C	-40 ... +80
• during operating	°C	-25 ... +60

Control circuit:

Type of voltage / of the controlled supply voltage		DC
Control supply voltage / 1		
• for DC		
• initial rated value	V	150
• final rated value	V	250

Installation/mounting/dimensions:

mounting position		any
Type of mounting		clip-on
Width	mm	28
Height	mm	46

Depth	mm	9
-------	----	---

Certificates/approvals:

Verification of suitability

CE / UL / CSA / CCC

General Product Approval

Declaration of Conformity

Test Certificates



[Special Test Certificate](#)

Shipping Approval



Shipping Approval

other



[Confirmation](#)



Further information:

Information- and Downloadcenter (Catalogs, Brochures,...)

<http://www.siemens.com/industrial-controls/catalogs>

Industry Mall (Online ordering system)

<http://www.siemens.com/industrial-controls/mall>

CAX-Online-Generator

<http://www.siemens.com/cax>

Service&Support (Manuals, Certificates, Characteristics, FAQs,...)

<http://support.automation.siemens.com/WW/view/en/3RT2916-1LP00/all>

Image database (product images, 2D dimension drawings, 3D models, device circuit diagrams, ...)

http://www.automation.siemens.com/bilddb/cax_en.aspx?mlfb=3RT2916-1LP00

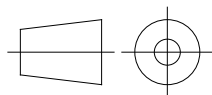
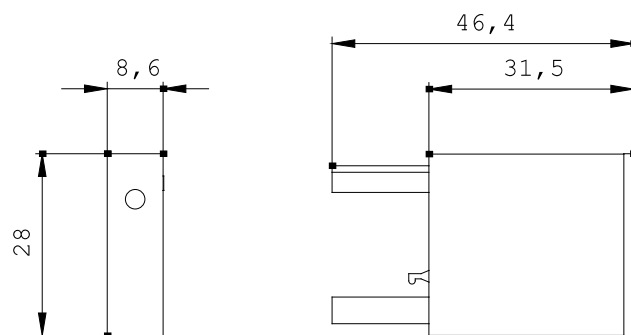

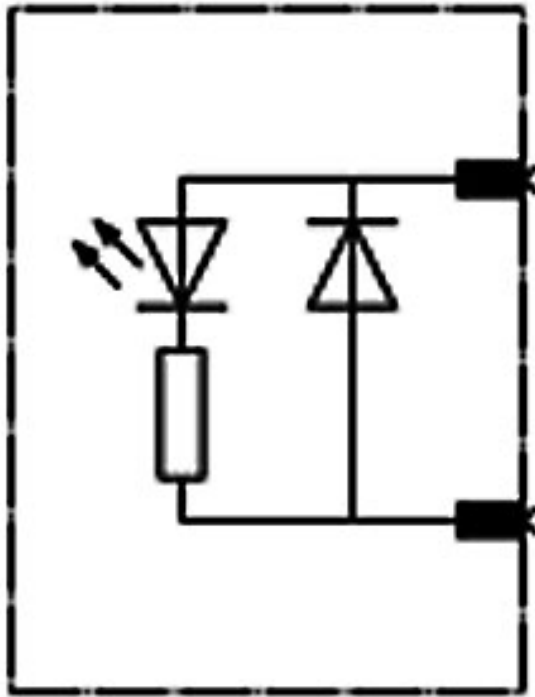

last change:

Apr 5, 2013