

DOUBLE EXTENSION BLOCK,
CONNECTION MAIN CIRCUIT: SPRING-LOADED
TERMINAL,
2 SLOTS FOR COMPACT LOAD FEEDERS

General technical data:

| | | |
|--|----------------|--|
| Product brand name | | SIRIUS |
| product designation | | 2-expansion block |
| Protection class IP | | IP20 |
| Degree of pollution | | 3 |
| Number of slots • for compact feeder | | 2 |
| Installation altitude / at a height over sea level • maximum | m | 2,000 |
| Ambient temperature • during transport • during storage • during operating | °C °C °C | -55 ... 80 -55 ... 80 -20 ... 60 |
| Item designation • according to DIN EN 61346-2 • according to DIN 40719 extendable after IEC 204-2 / according to IEC 750 | | K K |

Main circuit:

| | | |
|---|---|----|
| Operating current / at 400 V / for AC • rated value | A | 63 |
|---|---|----|

| | | |
|--|-----------------|---|
| Operating voltage / at AC-3 / rated value | | |
| • maximum | V | 690 |
| Installation/mounting/dimensions: | | |
| Type of mounting | | screw and snap-on mounting |
| Width | mm | 90 |
| Height | mm | 197 |
| Depth | mm | 100 |
| Connections: | | |
| Design of the electrical connection | | |
| • for main current circuit | | spring-loaded terminals |
| Wire stripping length / for main contacts | mm | 10 |
| Conductor cross-section that can be connected / for main contacts / for motor outgoing line | | |
| • unifilar | mm ² | 1.5 ... 10 |
| • stranded wire | mm ² | 1.5 ... 10 |
| • finely stranded | | |
| • with conductor end processing | mm ² | 1.5 ... 6 |
| • without conductor final cutting | mm ² | 1.5 ... 6 |
| AWG number / as coded connectable conductor cross section / for main contacts | | |
| • for motor outgoing line | | 14 ... 8 |
| Type of the connectable conductor cross-section / for main contacts / for motor outgoing line | | |
| • solid | | 2x (1.5 ... 6 mm ²), 1x (1.5 ... 10 mm ²) |
| • stranded | | 2x (1.5 ... 6 mm ²), 1x (1.5 ... 10 mm ²) |
| • stranded wire | | |
| • with conductor end processing | | 2 x (1.5 ... 6) mm ² |
| • without conductor final cutting | | 2 x (1.5 ... 6) mm ² |
| Type of the connectable conductor cross-section / for AWG-conductors / for main contacts | | |
| • for motor outgoing line | | 2 x (16 ... 10), 1 x (16 ... 8) |

General Product Approval



CSA

[ROSTEST](#)



UL

Shipping Approval



other

[Manufacturer](#)

[other](#)

Safety:

Protection against electrical shock

finger-safe

Further information:

Information- and Downloadcenter (Catalogs, Brochures,...)

<http://www.siemens.com/industrial-controls/catalogs>

Industry Mall (Online ordering system)

<http://www.siemens.com/industrial-controls/mall>

CAX-Online-Generator

<http://www.siemens.com/cax>

Service&Support (Manuals, Certificates, Characteristics, FAQs,...)

<http://support.automation.siemens.com/WW/view/en/3RA6822-0AC/all>

Image database (product images, 2D dimension drawings, 3D models, device circuit diagrams, ...)

http://www.automation.siemens.com/bilddb/cax_en.aspx?mlfb=3RA6822-0AC

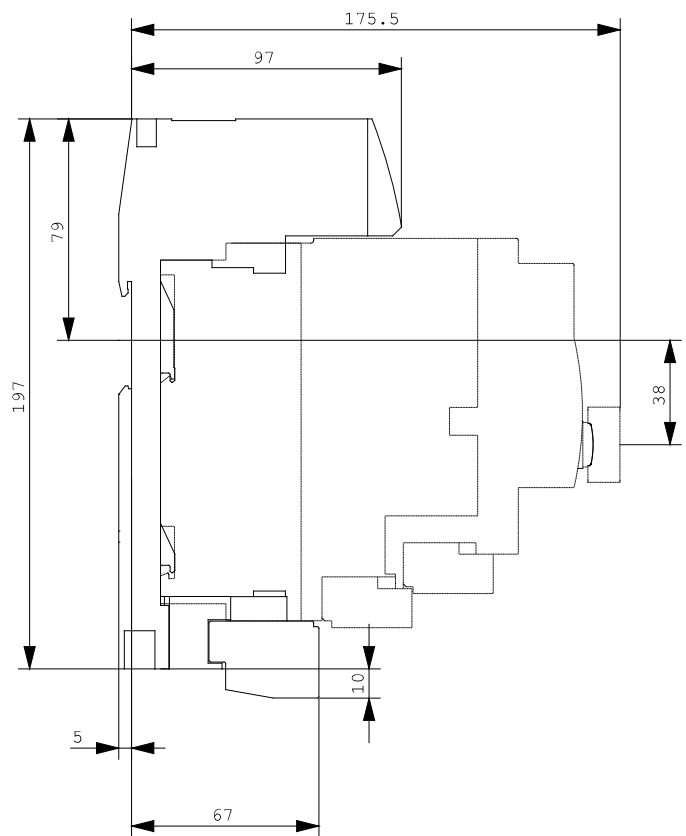
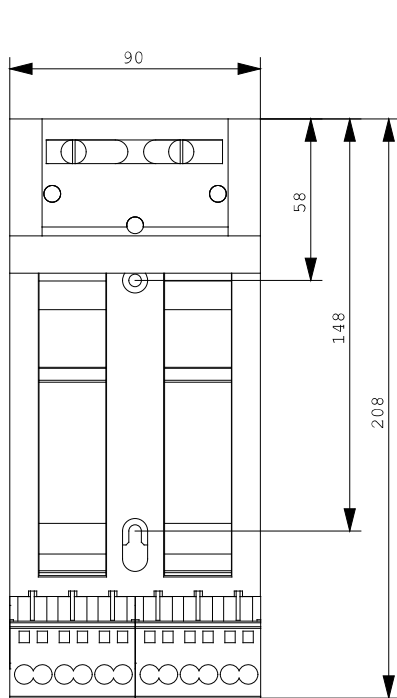

last change:

Oct 24, 2011