

REV. COMB. W./O-LINK, AC3, 3KW/400V,
DC24V 3-POLE,
SZ S00 SPRING-LOADED TERMINAL ELECTR. AND
MECH. INTERLOCK

General technical data:

Product brand name		SIRIUS
product designation		reversing contactor assembly 3RA23
Product function		reversing contactor
Size of the contactor		S00
Protection class IP / on the front		IP20
Degree of pollution		3
Insulation voltage / with degree of pollution 3 / rated value	V	690
Installation altitude / at a height over sea level / maximum	m	2,000
Ambient temperature <ul style="list-style-type: none"> during transport during storage during operating 	°C °C °C	-55 ... 80 -55 ... 80 -25 ... 60
Resistance against shock		9.8g / 5 ms and 5.9g / 10 ms
Impulse voltage resistance / rated value	kV	6
Active power loss / per conductor / typical	W	0.4
Item designation <ul style="list-style-type: none"> according to DIN 40719 extendable after IEC 204-2 / according to IEC 750 according to DIN EN 61346-2 		K Q

<ul style="list-style-type: none"> • at 110 V / rated value 	A	0.1
<ul style="list-style-type: none"> • with 2 current paths in series / at DC-3 / at DC-5 		
<ul style="list-style-type: none"> • at 24 V / rated value 	A	15
<ul style="list-style-type: none"> • at 110 V / rated value 	A	0.25
<ul style="list-style-type: none"> • with 3 current paths in series / at DC-3 / at DC-5 		
<ul style="list-style-type: none"> • at 24 V / rated value 	A	15
<ul style="list-style-type: none"> • at 110 V / rated value 	A	15
Service power		
<ul style="list-style-type: none"> • at AC-2 / at 400 V / rated value 	kW	3
<ul style="list-style-type: none"> • at AC-3 		
<ul style="list-style-type: none"> • at 400 V / rated value 	kW	3
<ul style="list-style-type: none"> • at 500 V / rated value 	kW	3.5
<ul style="list-style-type: none"> • at 690 V / rated value 	kW	4
<ul style="list-style-type: none"> • at AC-4 / at 400 V / rated value 	kW	1.15
Off-load operating frequency	1/h	15
Frequency of operation		
<ul style="list-style-type: none"> • at AC-1 / according to IEC 60947-6-2 / maximum 	1/h	1,000
<ul style="list-style-type: none"> • at AC-2 / according to IEC 60947-6-2 / maximum 	1/h	750
<ul style="list-style-type: none"> • at AC-3 / according to IEC 60947-6-2 / maximum 	1/h	750
<ul style="list-style-type: none"> • at AC-4 / according to IEC 60947-6-2 / maximum 	1/h	250

Control circuit:		
Design of activation		conventional
Design of the surge suppressor		with varistor
Type of voltage / of the controlled supply voltage		DC
Control supply voltage frequency		
<ul style="list-style-type: none"> • 1 / rated value 	Hz	50
<ul style="list-style-type: none"> • 2 / rated value 	Hz	60
Control supply voltage / 1		
<ul style="list-style-type: none"> • for DC / rated value 	V	24
Operating range factor control supply voltage rated value / of the solenoid		
<ul style="list-style-type: none"> • for DC 		0.85 ... 1.1
Pull-in power / of the solenoid / for DC	W	4
Holding power / of the solenoid / for DC	W	4
Resistive loss / of the magnet coil / for DC		
<ul style="list-style-type: none"> • typical 	W	4

Auxiliary circuit:		
Product extension / auxiliary switch		Yes
Contact reliability / of the auxiliary contacts		< 1 error per 100 million operating cycles

Number of NC contacts / for auxiliary contacts		
• per direction of rotation		0
• instantaneous switching		0
• lagging switching		0
Number of NO contacts / for auxiliary contacts		
• per direction of rotation		0
• instantaneous switching		0
• leading switching		0
Operating current / of the auxiliary contacts		
• at AC-12 / maximum	A	10
• at AC-15		
• at 230 V	A	6
• at 400 V	A	3
• at DC-12		
• at 48 V	A	6
• at 60 V	A	6
• at 110 V	A	3
• at 220 V	A	1
• at DC-13		
• at 24 V	A	10
• at 48 V	A	2
• at 60 V	A	2
• at 110 V	A	1
• at 220 V	A	0.3

Short-circuit:

Design of the fuse link

- for short-circuit protection of the main circuit
 - with type of assignment 1 / required
- at type of coordination 2 / required
- for short-circuit protection of the auxiliary switch / required

gL/gG LV HRC 3NA, DIAZED 5SB, NEOZED 5SE: 35 A

gL/gG LV HRC 3NA, DIAZED 5SB, NEOZED 5SE: 20 A

fuse gL/gG: 10 A

Installation/mounting/dimensions:

Built in orientation		any
Type of mounting		screw and snap-on mounting onto 35 mm standard mounting rail
Width	mm	90
Height	mm	84
Depth	mm	83
Distance, to be maintained, to the ranks assembly		

• forwards	mm	6
• backwards	mm	0
• upwards	mm	6
• downwards	mm	6
• sideways	mm	6
Distance, to be maintained, to earthed part		
• forwards	mm	6
• backwards	mm	0
• upwards	mm	6
• downwards	mm	6
• sideways	mm	6
Distance, to be maintained, conductive elements		
• forwards	mm	6
• backwards	mm	0
• upwards	mm	6
• downwards	mm	6
• sideways	mm	6

Connections:

Design of the electrical connection		
• for main current circuit		spring-loaded terminals
• for auxiliary and control current circuit		spring-loaded terminals
Type of the connectable conductor cross-section		
• for main contacts		
• solid		2x (0.5 ... 4 mm ²)
• stranded		2x (0.5 ... 4 mm ²)
• finely stranded		
• with conductor end processing		2x (0.5 ... 2.5 mm ²)
• without conductor final cutting		2x (0.5 ... 2.5 mm ²)
• for AWG conductors / for main contacts		1x (20 ... 12)
• for auxiliary contacts		
• solid		2x (0.5 ... 2.5 mm ²)
• finely stranded		
• with conductor end processing		2x (0.5 ... 1.5 mm ²)
• without conductor final cutting		2x (0.5 ... 1.5 mm ²)
• for AWG conductors / for auxiliary contacts		2x (20 ... 14)

Certificates/approvals:

Verification of suitability	CE / UL / CSA / CCC
------------------------------------	---------------------

General Product Approval



[ROSTEST](#)



Test Certificates

[Manufacturer](#)

Shipping Approval



GL



LRS



PRS



RINA

Shipping Approval other



[other](#)

UL/CSA ratings

yielded mechanical performance (hp)

- for single-phase squirrel cage motors
 - at 110/120 V / rated value
 - at 230 V / rated value
- for three-phase squirrel cage motors
 - at 200/208 V / rated value
 - at 220/230 V / rated value
 - at 460/480 V / rated value
 - at 575/600 V / rated value

hp	0.25
hp	0.75
hp	1.5
hp	2
hp	3
hp	5

Operating current (FLA) / for three-phase squirrel cage motors

- at 480 V / rated value
- at 600 V / rated value

A	4.8
A	6.1

Contact rating designation / for auxiliary contacts / according to UL

A600 / Q600

Safety:

B10 value / with high demand rate

- according to SN 31920

1,000,000

Failure rate (FIT value) / with low demand rate

- according to SN 31920

FIT 100

Proportion of dangerous failures

- with low demand rate / according to SN 31920
- with high demand rate / according to SN 31920

%	40
%	75

T1 value / for proof test interval or service life

- according to IEC 61508

a 20

Protection against electrical shock

finger-safe

Further information:

Information- and Downloadcenter (Catalogs, Brochures,...)

<http://www.siemens.com/industrial-controls/catalogs>

Industry Mall (Online ordering system)

<http://www.siemens.com/industrial-controls/mall>

CAX-Online-Generator

<http://www.siemens.com/cax>

Service&Support (Manuals, Certificates, Characteristics, FAQs,...)

<http://support.automation.siemens.com/WW/view/en/3RA2315-8XE30-2BB4/all>

Image database (product images, 2D dimension drawings, 3D models, device circuit diagrams, ...)

http://www.automation.siemens.com/bilddb/cax_en.aspx?mlfb=3RA2315-8XE30-2BB4

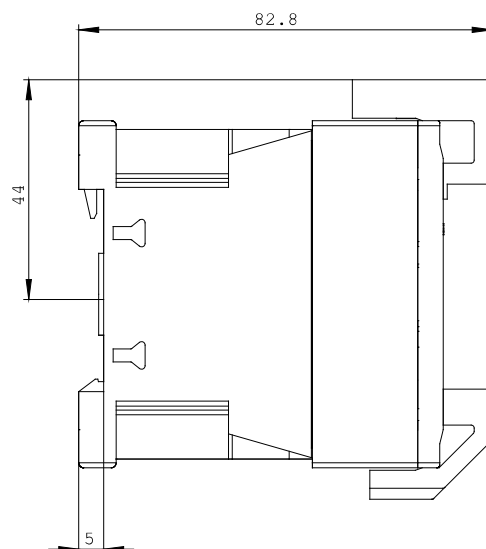
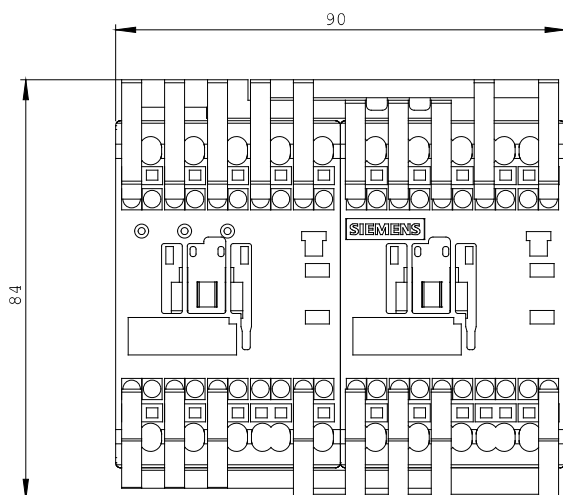

last change:

Oct 24, 2011