

Number of poles

3



FUSE-SWITCH-DISCONNECTOR 3-POLE, NH2,
400A 60MM BUSBAR SYSTEM COVER LEVEL 32/70 MM
FLAT CONNECTOR FUSE MONITORING ELECTRONIC,
EFM 20

Similar to image

General technical details:

product brand name	SENTRON
Product designation	Fuse switch disconnecter
Fuse system	LV HRC fuse
Installation size of fuse-link	NH1. NH2
Installation size of disconnecting link	2 and 1
Type from device	Zum Aufsnappen auf Sammelschienensystem Siemens 8US 60 mm
Design of the product	3-pole
Busbar design	Sammelschienendicke 5 oder 10 mm
Design of the operating mechanism	handle unit
Type of the driving mechanism / motor drive	No
Design of the safety monitoring	elektronisch EFM20
Number of NC contacts / for auxiliary contacts	0
Number of NO contacts / for auxiliary contacts	0
Number of changeover contacts / for auxiliary contacts	0
Design of the load switch / Strip form	No
Product equipment / interlock	Yes

Product feature / sealable		Yes
Product component		
• phase failure monitoring		Yes
• undervoltage release mechanism		No
• undervoltage release with leading contact		No
• trip indicator		Yes
Acceptability for application		
• switch disconnecter		Yes
• emergency stop switch		No
• main switch		No
• safety cut-out switch		Yes
• maintenance/repair switch		Yes
Product function		
• fuse monitoring		Yes
• overvoltage protection monitoring		Yes
Product extension		
• auxiliary switch		Yes
• optional		
• voltage trigger		No
• locking capability		Yes
• motor drive		No
Continuous current		
• rated value	A	400
• at 35 °C / rated value	A	400
• at 40 °C / rated value	A	400
• at 45 °C / rated value	A	392
• at 50 °C / rated value	A	372
• at 55 °C / rated value	A	356
Operating current		
• at AC-21 B		
• at 400 V / rated value	A	400
• at 500 V / rated value	A	400
• at 690 V / rated value	A	400
• at AC-22 B		
• at 400 V / rated value	A	400
• at 500 V / rated value	A	400
• at 690 V / rated value	A	400
• at AC-23 B		
• at 400 V / rated value	A	400
• at 500 V / rated value	A	315

• at 690 V / rated value	A	125
• with capacitive load		
• at 400 V / maximum	A	72
• at 500 V / maximum	A	55
Let-through current		
• with speedy activation / maximum permissible	kA	40
• with closed switch / maximum permissible	kA	40
Conditional short-circuit current (I_q)		
• rated value	kA	80
• at 500 V / with AC / with speedy activation / rated value	kA	80
• at 690 V / with AC / with speedy activation / rated value	kA	50
• with closed switch		
• at 500 V / with AC / rated value	kA	100
• at 690 V / with AC / rated value	kA	100
Tension d'emploi		
• for AC / rated value	V	230 ... 690
Power factor		
• at AC-21 B		0.95
• at AC-22 B		0.65
• at AC-23 B		0.35
• with capacitive load		-0.25
Active power loss / maximum	W	34
Insulation voltage / rated value	V	690
Impulse voltage resistance / rated value	kV	8
I_{2t} value / with closed switch / maximum permissible	kA ² ·s	2,150
Item designation		
• according to DIN EN 61346-2		Q
• according to DIN EN 81346-2		Q

Connection elements and terminals:

Design of the electrical connection / for main current circuit		flat connector
Conductor cross section that can be connected / for main contacts		
• single- or multi-stranded	mm ²	25 ... 240
• stranded	mm ²	25 ... 240
Tightening torque		
• with screw-type terminals	N·m	10 ... 12
Arrangement of electrical connectors / for main current circuit		sonstige

Degree of protection and safety class:

IP degree of protection		
--------------------------------	--	--

• open	IP20
• on the front	IP40
• with closed switch	
• without cover or cable lug cover	IP30
• with cover or cable lug cover	IP40
Degree of pollution	3
Mechanical operating cycles as operating time / typical	1,000

Ambient conditions:

Ambient temperature

• during operating	°C	-25 ... +55
• during storage	°C	-50 ... +80

Installation/mounting/dimensions:

Mounting type

• rail mounting	busbar mounting
• front mounting	Yes
• front mounting with central attachment	No
• front mounting with 4-hole attachment	No
• floor mounting	No

mounting position

waagrecht oder senkrecht

Width

mm 209.4

Height

mm 306

Depth

mm 187.6

Largeur

• du jeu de barres	mm	12 ... 30
--------------------	----	-----------

Center line spacing

mm 60

Net weight

kg 4.9

Certificates/approvals:

General Product Approval

Declaration of Conformity

Test Certificates



[Type Test
Certificates/Test
Report](#)

Shipping Approval



Further information:

Information- and Downloadcenter (Catalogs, Brochures,...)

<http://www.siemens.com/lowvoltage/catalogs>

Industry Mall (Online ordering system)

<https://eb.automation.siemens.com/mall/en/WW/Catalog/Product/3NP1153-1BC13>

Service&Support (Manuals, Certificates, Characteristics, FAQs,...)

<http://support.automation.siemens.com/WW/view/en/3NP1153-1BC13/all>

Image database (product images, 2D dimension drawings, 3D models, device circuit diagrams, ...)

http://www.automation.siemens.com/bilddb/cax_en.aspx?mlfb=3NP1153-1BC13

CAX-Online-Generator

<http://www.siemens.com/cax>

Tender specifications

[Datanorm](#) [GAEB81](#) [GAEB83](#) [RTF](#) [TXT](#)

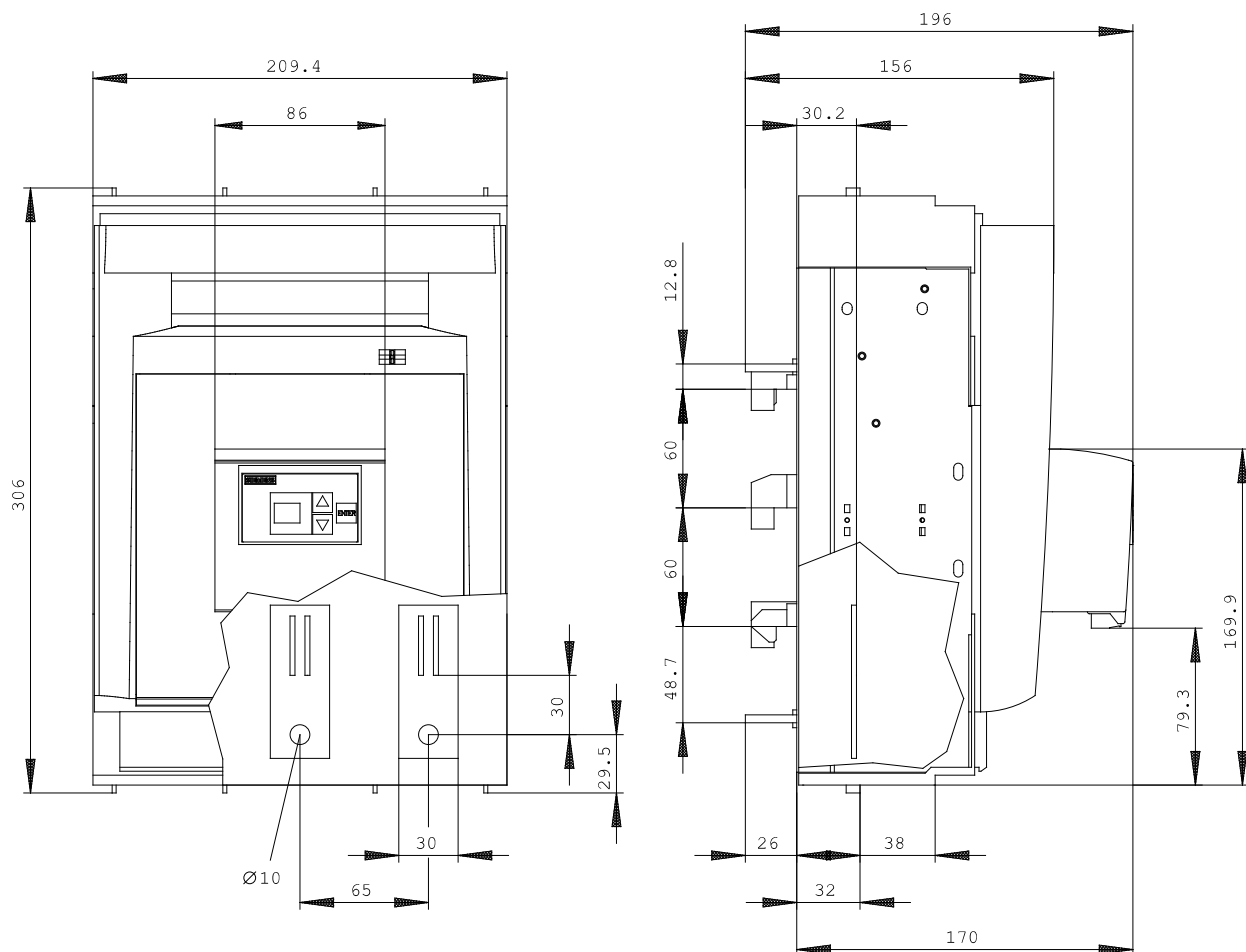

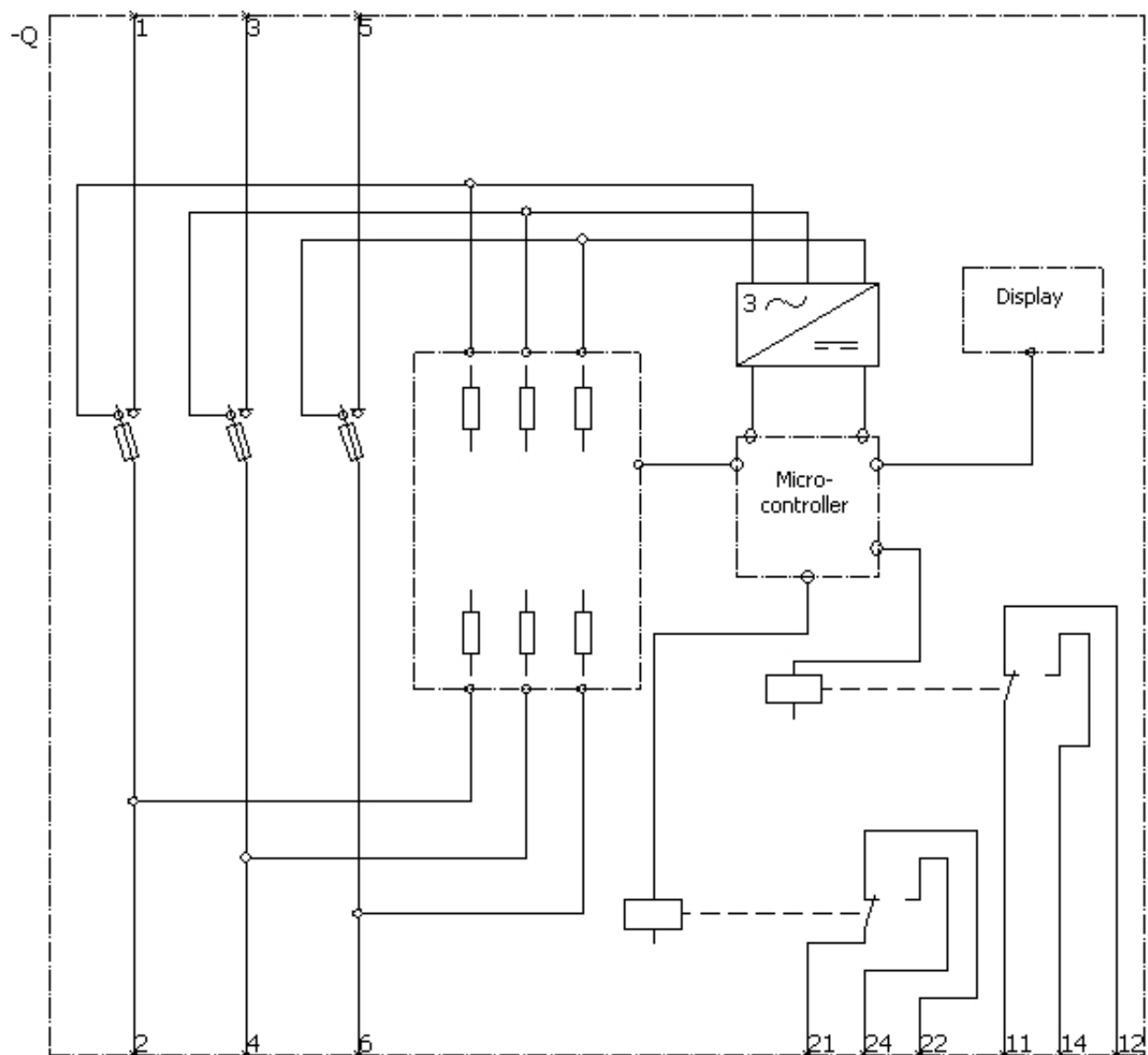

last change:

Mar 31, 2014