

Number of poles

3



FUSE-SWITCH-DISCONNECTOR 3-POLE, NH2,
400A 60MM BUSBAR SYSTEM COVER LEVEL 32/70 MM
BOX TERMINAL FUSE MONITORING ELECTRONIC,
EFM 20

Similar to image

General technical details:

product brand name	SENTRON
Product designation	Fuse switch disconnecter
Fuse system	LV HRC fuse
Installation size of fuse-link	NH1. NH2
Installation size of disconnecting link	2 and 1
Type from device	Zum Aufschrauben auf Sammelschienensystem Siemens 8US 60 mm
Design of the product	3-pole
Busbar design	Sammelschienendicke 5 oder 10 mm
Design of the operating mechanism	handle unit
Type of the driving mechanism / motor drive	No
Design of the safety monitoring	elektronisch EFM20
Number of NC contacts / for auxiliary contacts	0
Number of NO contacts / for auxiliary contacts	0
Number of changeover contacts / for auxiliary contacts	0
Design of the load switch / Strip form	No
Product equipment / interlock	Yes

Product feature / sealable		Yes
Product component		
• phase failure monitoring		Yes
• undervoltage release mechanism		No
• undervoltage release with leading contact		No
• trip indicator		Yes
Acceptability for application		
• switch disconnecter		Yes
• emergency stop switch		No
• main switch		No
• safety cut-out switch		Yes
• maintenance/repair switch		Yes
Product function		
• fuse monitoring		Yes
• overvoltage protection monitoring		Yes
Product extension		
• auxiliary switch		Yes
• optional		
• voltage trigger		No
• locking capability		Yes
• motor drive		No
Continuous current		
• rated value	A	400
• at 35 °C / rated value	A	400
• at 40 °C / rated value	A	400
• at 45 °C / rated value	A	392
• at 50 °C / rated value	A	372
• at 55 °C / rated value	A	356
Operating current		
• at AC-21 B		
• at 400 V / rated value	A	400
• at 500 V / rated value	A	400
• at 690 V / rated value	A	400
• at AC-22 B		
• at 400 V / rated value	A	400
• at 500 V / rated value	A	400
• at 690 V / rated value	A	400
• at AC-23 B		
• at 400 V / rated value	A	400
• at 500 V / rated value	A	315

<ul style="list-style-type: none"> • at 690 V / rated value 	A	125
<ul style="list-style-type: none"> • with capacitive load 		
<ul style="list-style-type: none"> • at 400 V / maximum 	A	72
<ul style="list-style-type: none"> • at 500 V / maximum 	A	55
Let-through current		
<ul style="list-style-type: none"> • with speedy activation / maximum permissible 	kA	40
<ul style="list-style-type: none"> • with closed switch / maximum permissible 	kA	40
Conditional short-circuit current (I_q)		
<ul style="list-style-type: none"> • rated value 	kA	80
<ul style="list-style-type: none"> • at 500 V / with AC / with speedy activation / rated value 	kA	80
<ul style="list-style-type: none"> • at 690 V / with AC / with speedy activation / rated value 	kA	50
<ul style="list-style-type: none"> • with closed switch 		
<ul style="list-style-type: none"> • at 500 V / with AC / rated value 	kA	100
<ul style="list-style-type: none"> • at 690 V / with AC / rated value 	kA	100
Tension d'emploi		
<ul style="list-style-type: none"> • for AC / rated value 	V	230 ... 690
Power factor		
<ul style="list-style-type: none"> • at AC-21 B 		0.95
<ul style="list-style-type: none"> • at AC-22 B 		0.65
<ul style="list-style-type: none"> • at AC-23 B 		0.35
<ul style="list-style-type: none"> • with capacitive load 		-0.25
Active power loss / maximum	W	34
Insulation voltage / rated value	V	690
Impulse voltage resistance / rated value	kV	8
I_{2t} value / with closed switch / maximum permissible	kA ² ·s	2,150
Item designation		
<ul style="list-style-type: none"> • according to DIN EN 61346-2 		Q
<ul style="list-style-type: none"> • according to DIN EN 81346-2 		Q

Connection elements and terminals:

Design of the electrical connection / for main current circuit		box terminals
Conductor cross section that can be connected / for main contacts		
<ul style="list-style-type: none"> • single- or multi-stranded 	mm ²	120 ... 300
<ul style="list-style-type: none"> • stranded 	mm ²	120 ... 300
Type of connectable conductor cross-sections / of laminated conductors		
<ul style="list-style-type: none"> • maximum 		10 x 32 mm
Tightening torque		
<ul style="list-style-type: none"> • with screw-type terminals 	N·m	10 ... 25
Arrangement of electrical connectors / for main current circuit		sonstige

Degree of protection and safety class:**IP degree of protection**

- open
- on the front
- with closed switch
 - without cover or cable lug cover
 - with cover or cable lug cover

IP20

IP40

IP30

IP40

Degree of pollution

3

Mechanical operating cycles as operating time / typical

1,000

Ambient conditions:**Ambient temperature**

- during operating
- during storage

°C

-25 ... +55

°C

-50 ... +80

Installation/mounting/dimensions:**Mounting type**

- rail mounting
- front mounting
- front mounting with central attachment
- front mounting with 4-hole attachment
- floor mounting

busbar mounting

Yes

No

No

No

No

mounting position

waagrecht oder senkrecht

Width

mm

209.4

Height

mm

306

Depth

mm

187.6

Largeur

- du jeu de barres

mm

12 ... 30

Center line spacing

mm

60

Net weight

kg

4.9

Certificates/approvals:**General Product Approval****Declaration of
Conformity****Test Certificates**

CCC



GOST



UL



UR



EG-Konf.

[Type Test
Certificates/Test
Report](#)

Shipping Approval

DNV



GL



LRS

Further information:

Information- and Downloadcenter (Catalogs, Brochures,...)

<http://www.siemens.com/lowvoltage/catalogs>

Industry Mall (Online ordering system)

<https://eb.automation.siemens.com/mall/en/WW/Catalog/Product/3NP1153-1BC23>

Service&Support (Manuals, Certificates, Characteristics, FAQs,...)

<http://support.automation.siemens.com/WW/view/en/3NP1153-1BC23/all>

Image database (product images, 2D dimension drawings, 3D models, device circuit diagrams, ...)

http://www.automation.siemens.com/bilddb/cax_en.aspx?mlfb=3NP1153-1BC23

CAX-Online-Generator

<http://www.siemens.com/cax>

Tender specifications

[Datanorm](#) [GAEB81](#) [GAEB83](#) [RTF](#) [TXT](#)

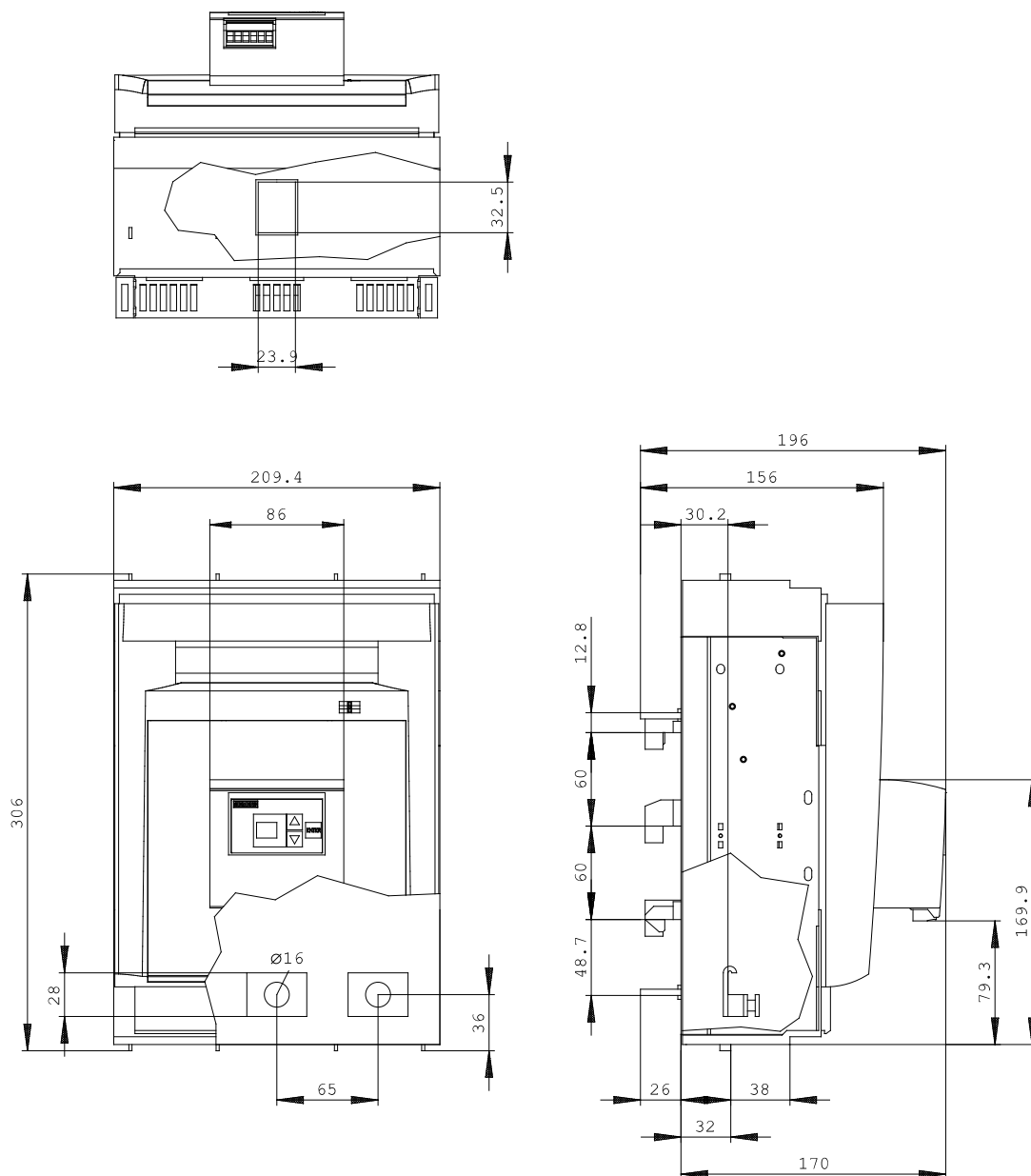

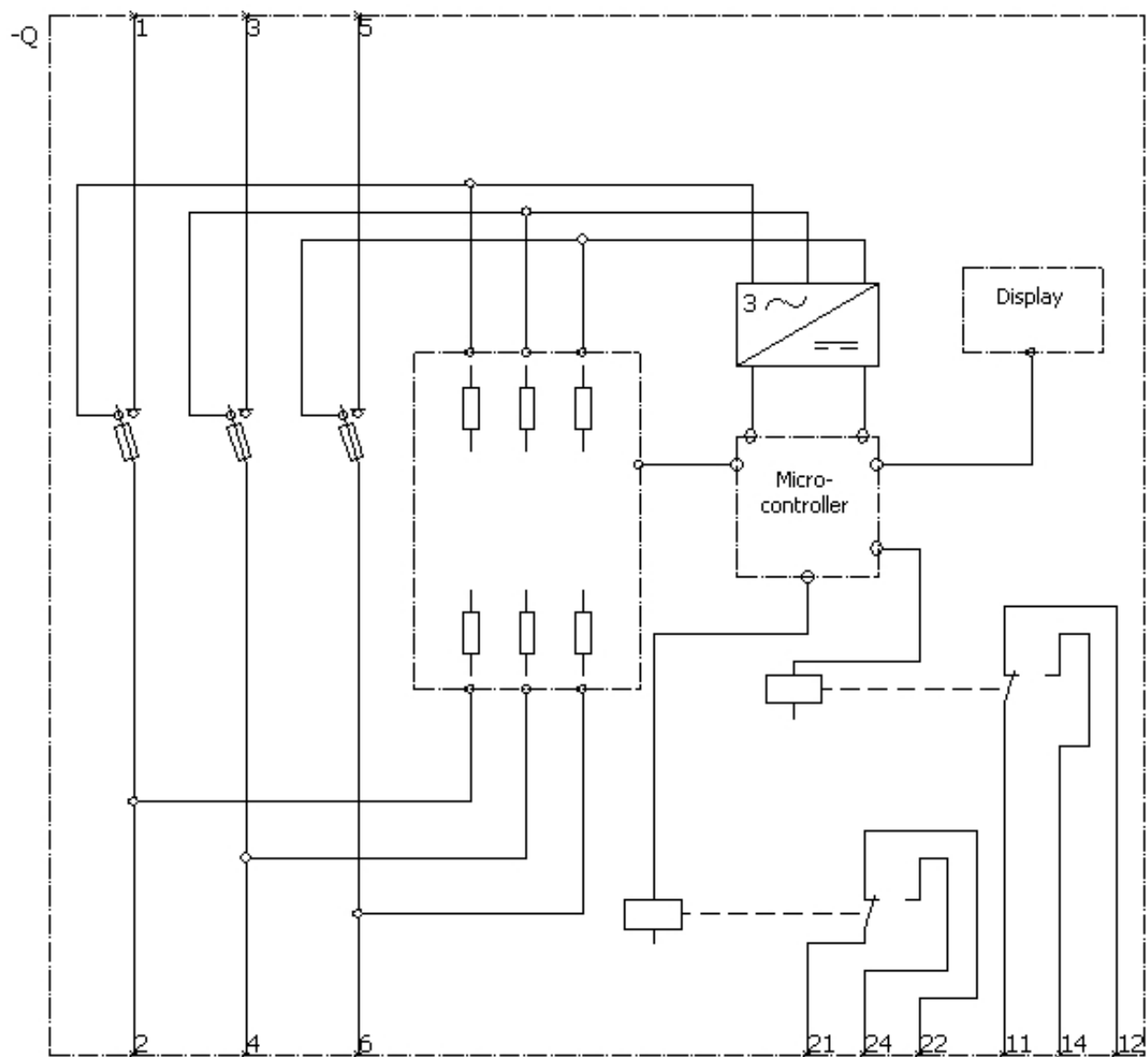

last change:

Mar 31, 2014