



CIRCUIT-BREAKER SZ S00,
FOR MOTOR PROTECTION, CLASS 10,
A-REL. 0.28...0.4A,
N-RELEASE5.2A SPRING-L. CONNECTION STANDARD
SW. CAPACITY W. TRANSVERSE AUX. SWITCH
1NO+1NC

General technical data:

| | | |
|--|----|----------------------|
| Product brand name | | SIRIUS |
| product designation | | 3RV2 circuit breaker |
| Size of the circuit-breaker | | S00 |
| Trip class | | CLASS 10 |
| Protection class IP / on the front | | IP20 |
| Degree of pollution | | 3 |
| Installation altitude / at a height over sea level / maximum | m | 2,000 |
| Ambient temperature | | |
| • during storage | °C | -50 ... 80 |
| • during operating | °C | -20 ... 60 |
| • during transport | °C | -50 ... 80 |
| Resistance against shock | | 25g / 11 ms |
| Impulse voltage resistance / rated value | kV | 6 |
| Insulation voltage / rated value | V | 690 |
| Active power loss / total / typical | W | 5.5 |
| Item designation | | |
| • according to DIN 40719 extendable after IEC 204-2 / according to IEC 750 | | F |
| • according to DIN EN 61346-2 | | F |

| | | |
|--|--|-----------------|
| Mechanical operating cycles as operating time | | |
| • of the main contacts / typical | | 100,000 |
| • of the auxiliary contacts / typical | | 100,000 |
| Design of the auxiliary switch | | transverse |
| Type of the driving mechanism / motor drive | | No |
| Design of the operating mechanism | | selector switch |
| Product function | | |
| • overload protection | | Yes |
| • phase disturbance recognition | | Yes |
| Product component | | |
| • auxiliary switch | | Yes |
| • undervoltage release mechanism | | No |
| • trip indicator | | No |
| Product extension / optional / motor drive | | No |

| | | |
|--|-----|----------------|
| Main circuit: | | |
| Number of poles / for main current circuit | | 3 |
| Operating voltage / at AC-3 / rated value / maximum | V | 690 |
| Operating current / at AC-3 / at 400 V / rated value | A | 0.3 |
| Service power / at AC-3 | | |
| • at 400 V / rated value | W | 90 |
| • at 500 V / rated value | W | 120 |
| • at 690 V / rated value | W | 180 |
| Frequency of operation / at AC-3 / according to IEC 60947-6-2 / maximum | 1/h | 15 |
| Arrangement of electrical connectors / for main current circuit | | Top and bottom |
| Adjustable response current | | |
| • of the non-delayed short-circuit release | A | 5.2 ... 5.2 |
| • of the current-dependent overload release | A | 0.28 ... 0.4 |
| Service power / at AC-3 / at 230 V / rated value | W | 60 |
| Continuous current / rated value | A | 0.4 |

| | | |
|---|---|-----|
| Auxiliary circuit: | | |
| Product extension / auxiliary switch | | Yes |
| Number of NC contacts / for auxiliary contacts / instantaneous switching | | 1 |
| Number of NO contacts / for auxiliary contacts / instantaneous switching | | 1 |
| Number of change-over switches / for auxiliary contacts | | 0 |
| Operating current / of the auxiliary contacts | | |
| • at AC-12 / maximum | A | 2.5 |

- at AC-15
 - at 24 V
 - at 230 V
- at DC-13
 - maximum
 - at 24 V
 - at 60 V

| | |
|---|------|
| A | 2 |
| A | 0.5 |
| A | 1 |
| A | 1 |
| A | 0.15 |

Inputs/ Outputs:

Number of digital inputs

0

Short-circuit:

Breaking capacity limit short-circuit current (Icu)

- at 400 V / rated value
- at 500 V / rated value
- at 690 V / rated value

| | |
|---|---------|
| A | 100,000 |
| A | 100,000 |
| A | 100,000 |

Design of the fuse link / for short-circuit protection of the auxiliary switch / required

Fuse gL/gG: 10 A, miniature circuit breaker C 6 A (short-circuit current I_k < 400 A)

Design of the overcurrent release and short-circuit release

thermomagnetic

Installation/mounting/dimensions:

Built in orientation

any

Type of mounting

screw and snap-on mounting onto 35 mm standard mounting rail according to DIN EN 60715

Width

mm 45

Height

mm 109

Depth

mm 91

Distance, to be maintained, to the ranks assembly

- forwards
- backwards
- upwards
- downwards
- sideways

| | |
|----|----|
| mm | 0 |
| mm | 0 |
| mm | 50 |
| mm | 50 |
| mm | 0 |

Distance, to be maintained, to earthed part

- forwards
- backwards
- upwards
- sideways
- downwards

| | |
|----|----|
| mm | 0 |
| mm | 0 |
| mm | 50 |
| mm | 30 |
| mm | 50 |

Distance, to be maintained, conductive elements

- forwards
- backwards

| | |
|----|---|
| mm | 0 |
| mm | 0 |

- upwards
- downwards
- sideways

| | |
|----|----|
| mm | 50 |
| mm | 50 |
| mm | 30 |

Connections:

Product function

- removable terminal for main circuit
- removable terminal for auxiliary and control circuit

No

No

Design of the electrical connection

- for main current circuit
- for auxiliary and control current circuit

spring-loaded terminals

spring-loaded terminals

Type of the connectable conductor cross-section

- for main contacts
 - solid
 - stranded
 - finely stranded
 - with conductor end processing
 - without conductor final cutting
- for AWG conductors / for main contacts
- for auxiliary contacts
 - solid
 - finely stranded
 - with conductor end processing
 - without conductor final cutting
- for AWG conductors / for auxiliary contacts

2x (0.5 ... 4 mm²)

2x (0.5 ... 4 mm²)

2x (0.5 ... 2.5 mm²)

2x (0.5 ... 2.5 mm²)

2x (20 ... 12)

2x (0.5 ... 2.5 mm²)

2x (0.5 ... 1.5 mm²)

2x (0.5 ... 1.5 mm²)

2x (20 ... 14)

Certificates/approvals:

Verification of suitability

- für Staubexplosionsschutz für Zone 21/22
- for gas explosion protection for zone 1/2

CE / UL / CSA

no

no

General Product Approval



CQC



CSA

[ROSTEST](#)



UL

For use in hazardous locations

[DEKRA EXAM,](#)
[DMT](#)

Test Certificates

[Manufacturer](#)

[other](#)

Shipping Approval



ABS



GL



LRS



PRS



RINA



RMRS

other

[Manufacturer](#)

[other](#)



VDE

UL/CSA ratings

Contact rating designation / for auxiliary contacts / according to UL

C300 / R300

Safety:

B10 value / with high demand rate

- according to SN 31920

50,000

T1 value / for proof test interval or service life

- according to IEC 61508

a

10

Failure rate (FIT value) / with low demand rate

- according to SN 31920

FIT

50

Proportion of dangerous failures

- with low demand rate / according to SN 31920
- with high demand rate / according to SN 31920

%

40

%

40

Protection against electrical shock

finger-safe

Further information:

Information- and Downloadcenter (Catalogs, Brochures,...)

<http://www.siemens.com/industrial-controls/catalogs>

Industry Mall (Online ordering system)

<http://www.siemens.com/industrial-controls/mall>

CAX-Online-Generator

<http://www.siemens.com/cax>

Service&Support (Manuals, Certificates, Characteristics, FAQs,...)

<http://support.automation.siemens.com/WW/view/en/3RV2011-0EA25/all>

Image database (product images, 2D dimension drawings, 3D models, device circuit diagrams, ...)

http://www.automation.siemens.com/bilddb/cax_en.aspx?mlfb=3RV2011-0EA25

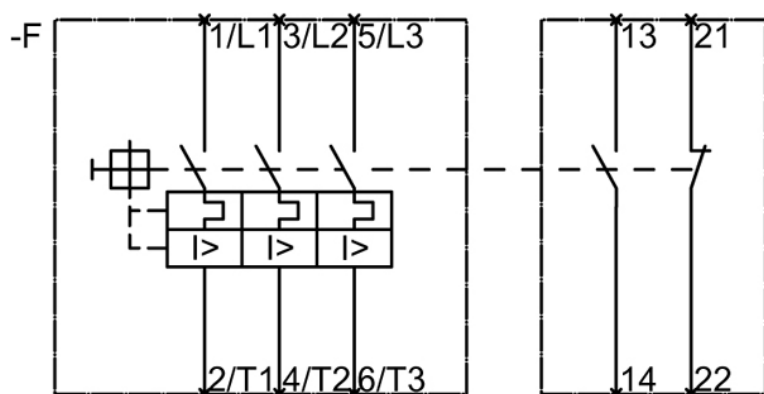
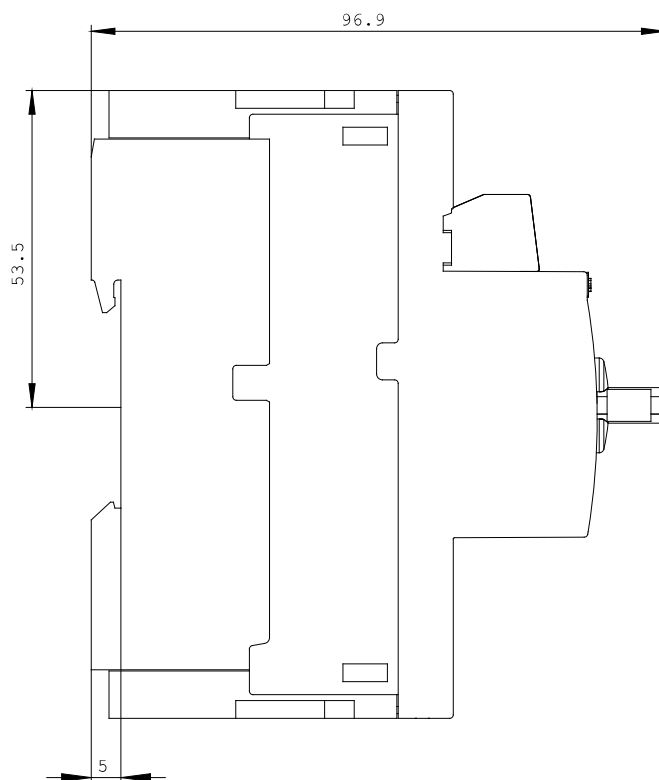
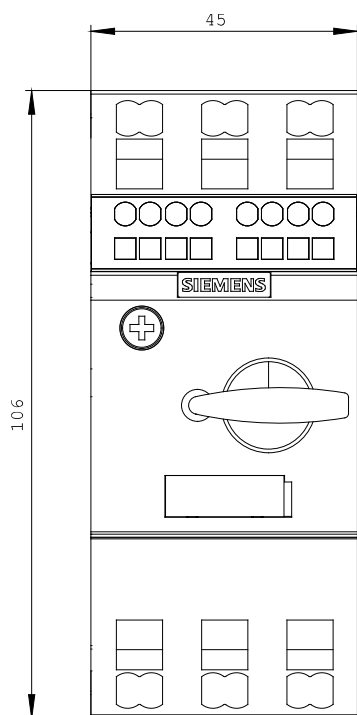

last change:

Oct 24, 2011