



LATERAL AUXILIARY SWITCH 1NO+1NC,
RING CABLE LUG CONNECTION FOR CIRCUIT-
BREAKERS,
SZ S00/S0

General technical data:

Product brand name		SIRIUS
product designation		auxiliary switch, lateral
Design of the product		lateral auxiliary switches
Size of the circuit-breaker		S00
Protection class IP / on the front		IP20
Ambient temperature		
• during storage	°C	-50 ... 80
• during operating	°C	-20 ... 60

Auxiliary circuit:

Number of NC contacts / for auxiliary contacts		
• instantaneous switching		1
Number of NO contacts / for auxiliary contacts		
• instantaneous switching		1
Number of changeover contacts / of the auxiliary contacts		
• instantaneous switching		0
Operating current / of the auxiliary contacts		
• at AC-12		
• at 24 V	A	10
• at 230 V	A	10

- at 400 V
- at 690 V
- maximum
- at AC-15
 - at 24 V
 - at 230 V
 - at 690 V
 - at 400 V
- at DC-13
 - at 24 V
 - at 110 V
 - at 125 V
 - at 220 V
 - at 250 V

A	10
A	10
A	10
A	6
A	4
A	1
A	3
A	2
A	0.5
A	0.5
A	0.25
A	0.25

Installation/mounting/dimensions:

Type of mounting		plug-in fixing
Width	mm	9.5
Height	mm	90
Depth	mm	68

Connections:

Design of the electrical connection		
• for auxiliary and control current circuit		ring cable connection

Certificates/approvals:

Verification of suitability		CE / UL / CSA / CCC
-----------------------------	--	---------------------

General Product Approval

Test Certificates



CQC



CSA



UL

[Manufacturer](#)

Shipping Approval



ABS



GL



LRS



PRS



RINA



RMRS

other

[Manufacturer](#)

[other](#)



VDE

Further information:

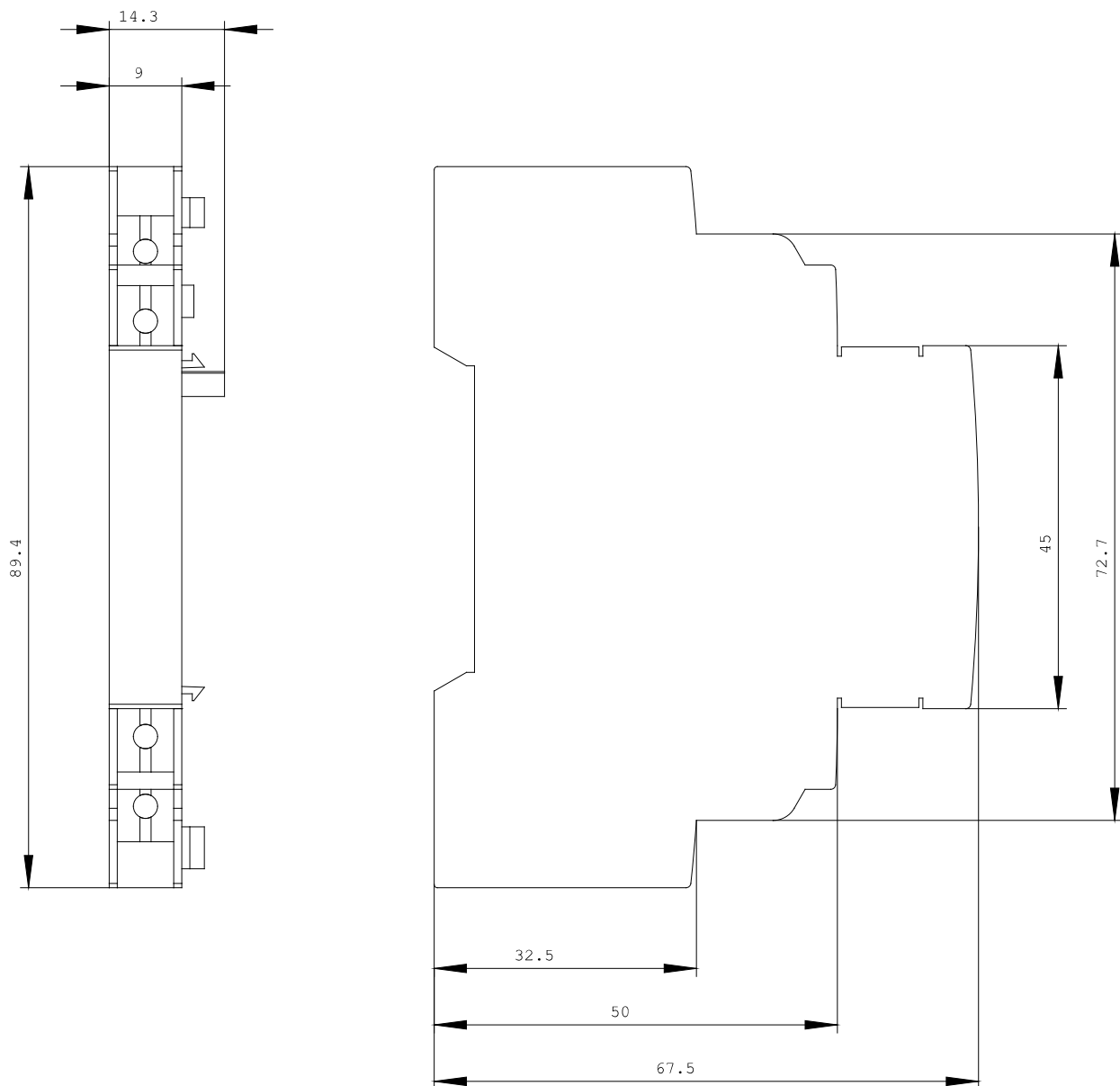

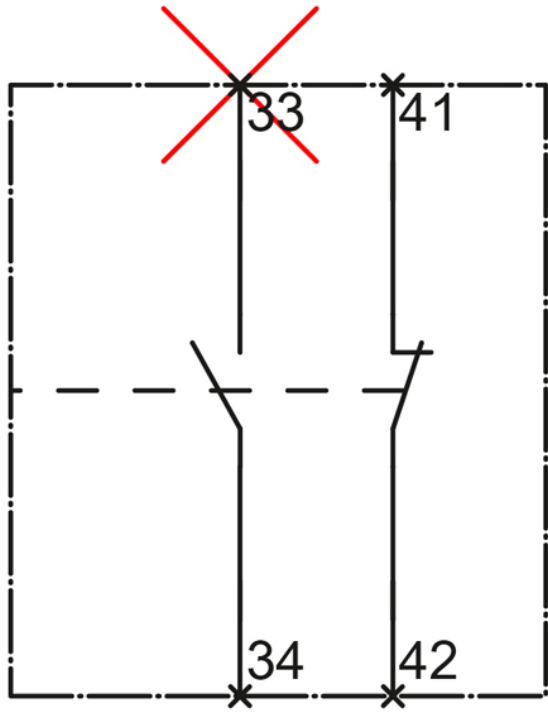

last change:

Aug 22, 2011