

TRANSVERSE AUX. SWITCH, 1NO+1NC,
SPRING-L. CONNECTION,
FOR CIRCUIT-BREAKERS, SZ S00/S0



General technical data:

Product brand name		SIRIUS
product designation		auxiliary switch, transverse on the front
Design of the product		transverse auxiliary switches
Size of the circuit-breaker		S00
Protection class IP / on the front		IP20
Ambient temperature		
• during storage	°C	-50 ... 80
• during operating	°C	-20 ... 60

Auxiliary circuit:

Number of NC contacts / for auxiliary contacts		
• instantaneous switching		1
Number of NO contacts / for auxiliary contacts		
• instantaneous switching		1
Number of changeover contacts / of the auxiliary contacts		
• instantaneous switching		0
Operating current / of the auxiliary contacts		
• at AC-12		
• at 24 V	A	2.5
• at 230 V	A	2.5

- maximum
- at AC-15
 - at 24 V
 - at 230 V
- at DC-13
 - at 24 V
 - at 48 V
 - at 60 V

A	10
A	2
A	0.5
A	1
A	0.3
A	0.15

Installation/mounting/dimensions:

Type of mounting

plug-in fixing

Width

mm

45

Height

mm

13

Depth

mm

17

Connections:

Design of the electrical connection

- for auxiliary and control current circuit

spring-loaded terminals

Type of the connectable conductor cross-section

- for auxiliary contacts
 - solid
 - finely stranded
 - with conductor end processing
 - without conductor final cutting
- for AWG conductors / for auxiliary contacts

2x (0.5 ... 1.5 mm²)

2x (0.5 ... 1.5 mm²)

2 x (0.5 ... 1.5 mm²)

2x (20 ... 14)

Certificates/approvals:

Verification of suitability

CE / UL / CSA / CCC

General Product Approval

Test Certificates



CQC



CSA



UL

[Manufacturer](#)

Shipping Approval



ABS



GL



LRS



PRS



RINA



RMRS

other

[Manufacturer](#)

[other](#)



VDE

Further information:

Information- and Downloadcenter (Catalogs, Brochures,...)

<http://www.siemens.com/industrial-controls/catalogs>

Industry Mall (Online ordering system)

<http://www.siemens.com/industrial-controls/mall>

CAX-Online-Generator

<http://www.siemens.com/cax>

Service&Support (Manuals, Certificates, Characteristics, FAQs,...)

<http://support.automation.siemens.com/WW/view/en/3RV2901-2E/all>

Image database (product images, 2D dimension drawings, 3D models, device circuit diagrams, ...)

http://www.automation.siemens.com/bilddb/cax_en.aspx?mlfb=3RV2901-2E

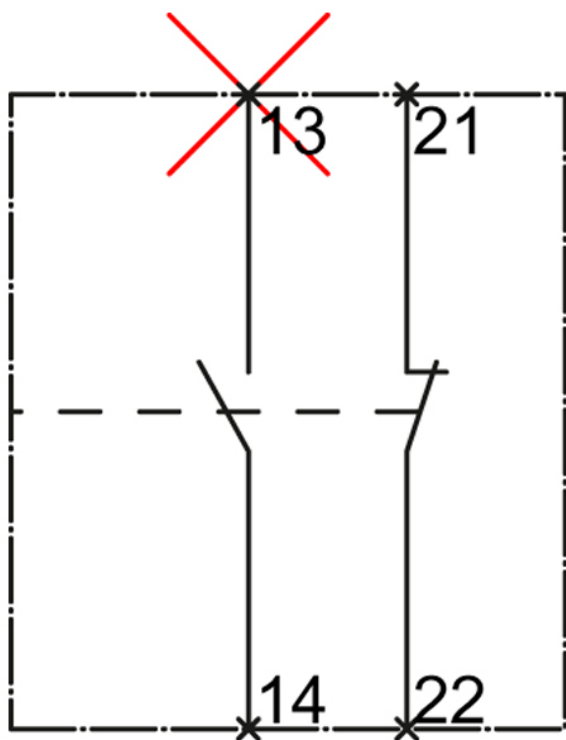
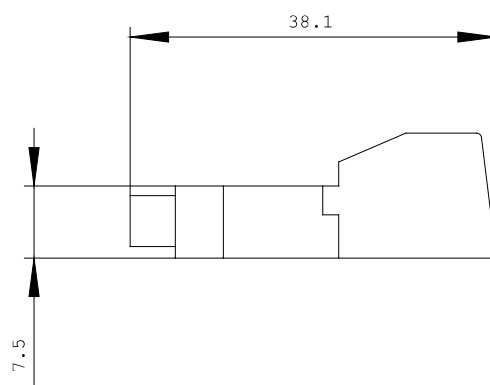
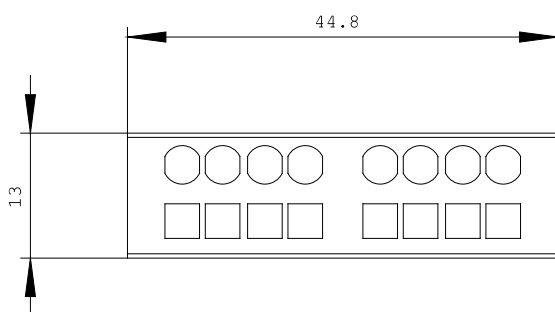

last change:

Aug 22, 2011