

TRANSVERSE AUX. SWITCH, 1CO,
SCREW CONNECTION, FOR CIRCUIT-BREAKERS,
SZ S00/S0



General technical data:

Product brand name		SIRIUS
product designation		auxiliary switch, transverse on the front
Design of the product		transverse auxiliary switches
Size of the circuit-breaker		S00
Protection class IP / on the front		IP20
Ambient temperature		
• during storage	°C	-50 ... 80
• during operating	°C	-20 ... 60

Auxiliary circuit:

Number of NC contacts / for auxiliary contacts		
• instantaneous switching		0
Number of NO contacts / for auxiliary contacts		
• instantaneous switching		0
Number of changeover contacts / of the auxiliary contacts		
• instantaneous switching		1
Operating current / of the auxiliary contacts		
• at AC-12		
• at 24 V	A	10
• at 230 V	A	10

- at 400 V
- at 690 V
- maximum
- at AC-15
 - at 24 V
 - at 230 V
 - at 690 V
 - at 400 V
- at DC-13
 - at 24 V
 - at 110 V
 - at 125 V
 - at 220 V
 - at 250 V

A	10
A	10
A	10
A	4
A	3
A	0.5
A	1.5
A	1
A	0.22
A	0.22
A	0.1
A	0.1

Installation/mounting/dimensions:

Type of mounting		plug-in fixing
Width	mm	45
Height	mm	12
Depth	mm	17

Connections:

Design of the electrical connection		screw-type terminals
<ul style="list-style-type: none"> • for auxiliary and control current circuit 		
Type of the connectable conductor cross-section		
<ul style="list-style-type: none"> • for auxiliary contacts <ul style="list-style-type: none"> • solid • finely stranded <ul style="list-style-type: none"> • with conductor end processing • for AWG conductors / for auxiliary contacts 		2x (0.5 ... 1.5 mm ²), 2x (0.75 ... 2.5 mm ²) 2x (0.5 ... 1.5 mm ²), 2x (0.75 ... 2.5 mm ²) 2x (20 ... 14)

Certificates/approvals:

Verification of suitability		CE / UL / CSA / CCC
-----------------------------	--	---------------------

General Product Approval



CQC



CSA



UL

Test Certificates

[Manufacturer](#)

Shipping Approval



ABS



GL



LRS



PRS



RINA



RMRS

other

[Manufacturer](#)

[other](#)



VDE

Further information:

Information- and Downloadcenter (Catalogs, Brochures,...)

<http://www.siemens.com/industrial-controls/catalogs>

Industry Mall (Online ordering system)

<http://www.siemens.com/industrial-controls/mall>

CAX-Online-Generator

<http://www.siemens.com/cax>

Service&Support (Manuals, Certificates, Characteristics, FAQs,...)

<http://support.automation.siemens.com/WW/view/en/3RV2901-1D/all>

Image database (product images, 2D dimension drawings, 3D models, device circuit diagrams, ...)

http://www.automation.siemens.com/bilddb/cax_en.aspx?mlfb=3RV2901-1D

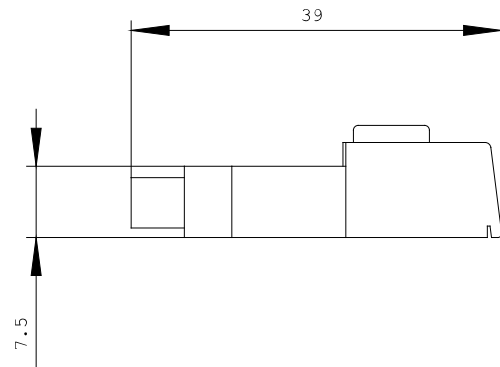
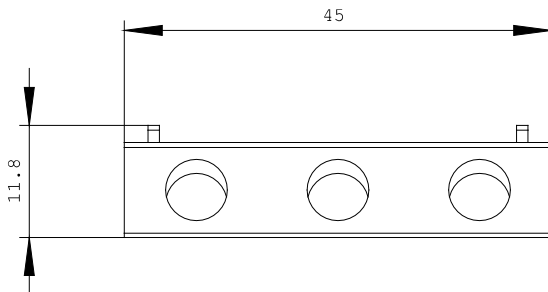

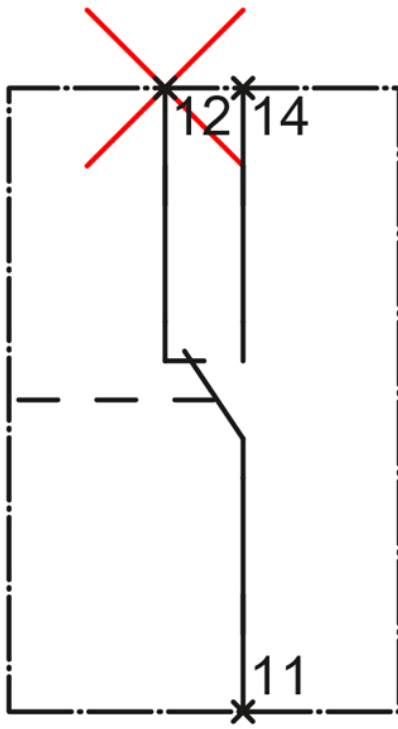

last change:

Aug 22, 2011