



ASISAFE BASIC SAFETY MONITOR 2 F-RO,  
2 ENABLING CIRCUITS, IP20,  
WITH SCREW-TYPE TERMINALS (REMOVABLE),  
SAFE OUTPUT RELAY RESPONSE TIME MAX. 50 MS,  
MONITOR TYPE 2, VERSION 3,  
APPLICABLE UP TO CATEGORY 4 (EN 954-1),  
UP TO PL E (EN ISO 13849-1),  
UP TO SIL 3 (IEC 61508),  
FOR AS-INTERFACE / AS-I SAFETY AT WORK

[illegible]

### Ambient conditions:

#### Ambient temperature

- during operating
- during storage

°C	60 ... -20
°C	70 ... -30

#### Protection class IP

IP20
------

### Mechanical design:

#### Width

mm	45
----	----

#### Height

mm	108
----	-----

#### Depth

mm	120
----	-----

#### Mounting type

screws / standard rail
------------------------

### Certificates/approvals:

#### General Product Approval

#### Functional Safety / Safety of Machinery



#### Declaration of Conformity



EG-Konf.

#### Shipping Approval



#### other

[Confirmation](#)

[Declaration of  
Conformity](#)

[Environmental  
Confirmations](#)

### Further information:

#### Information- and Downloadcenter (Catalogs, Brochures,...)

<http://www.siemens.com/industrial-controls/catalogs>

#### Industry Mall (Online ordering system)

<http://www.siemens.com/industrial-controls/mall>

#### CAX-Online-Generator

<http://www.siemens.com/cax>

#### Service&Support (Manuals, Certificates, Characteristics, FAQs,...)

<http://support.automation.siemens.com/WW/view/en/3RK1105-1BE04-1CA0/all>

#### Image database (product images, 2D dimension drawings, 3D models, device circuit diagrams, ...)

[http://www.automation.siemens.com/bilddb/cax\\_en.aspx?mlfb=3RK1105-1BE04-1CA0](http://www.automation.siemens.com/bilddb/cax_en.aspx?mlfb=3RK1105-1BE04-1CA0)

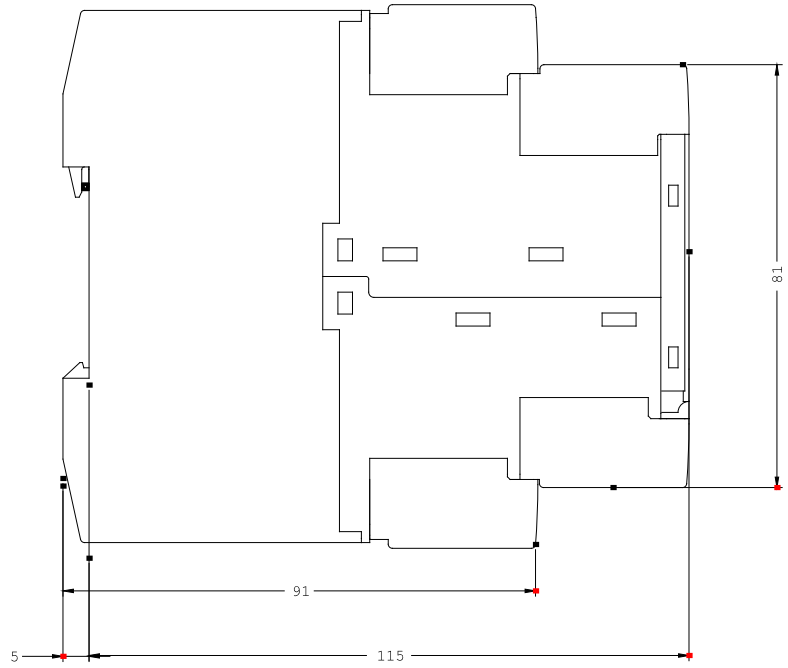
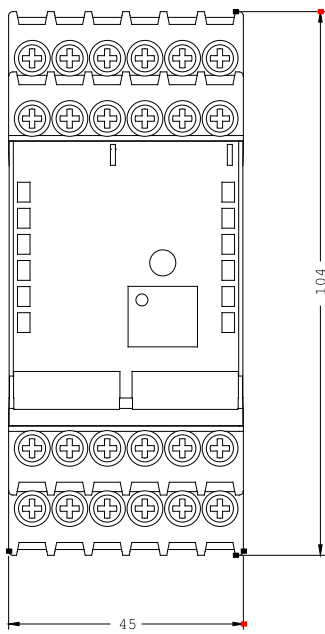

last change:

Mar 31, 2014