



SAFETY POS. SWITCH W. SEPARATE ACTUATOR,  
PLASTIC ENCLOSURE, 31MM;  
1X(M20X1.5) W/DEVICE M12 CONNECTOR,  
4-POLE SLOW-ACTION CONTACTS 2NC,  
5 DIRECTIONS OF APPROACH,  
THE MATCHING SEPARATE ACTUATOR 3SE5000-0AV0.  
IS TO BE ORDERED SEPARATELY

### General technical details:

<b>product designation</b>		position switch with separate actuator
<b>Insulation voltage</b>		
• rated value	V	250
<b>Degree of pollution</b>		class 3
<b>Thermal current</b>	A	4
<b>Operating current</b>		
• at AC-15		
• at 24 V / rated value	A	4
• at 125 V / rated value	A	4
• at 230 V / rated value	A	1.5
• at DC-13		
• at 24 V / rated value	A	3
• at 125 V / rated value	A	0.55
• at 230 V / rated value	A	0.27
<b>Continuous current</b>		
• of the slow DIAZED fuse link	A	4
• of the quick DIAZED fuse link	A	4
• of the C characteristic circuit breaker	A	1
<b>Mechanical operating cycles as operating time</b>		

• typical		1,000,000
<b>Electrical operating cycles as operating time</b>		
• at AC-15 / at 230 V / typical		100,000
<b>Electrical operating cycles in one hour</b>		
• with contactor 3RH11, 3RT1016, 3RT1017, 3RT1024, 3RT1025, 3RT1026		6,000
<b>Repeat accuracy</b>	mm	0.05
<b>Design of the contact element</b>		slow-action contacts
<b>Number of NC contacts</b>		
• for auxiliary contacts		2
<b>Design of the switching function</b>		positive opening
<b>Number of NO contacts</b>		
• for auxiliary contacts		0
<b>Resistance against vibration</b>		0.35 mm / 5g
<b>Resistance against shock</b>		30g / 11 ms
<b>Ambient temperature</b>		
• during operating	°C	-25 ... 85
• during storage	°C	-40 ... 90
<b>Product specification</b>		
• for dimensions		EN 50047
<b>Width of the sensor</b>	mm	31
<b>material</b>		
• of the housing		plastic
<b>Material / of the housing / of the switch head</b>		plastic
<b>Design of the operating mechanism</b>		5 directions of approach
<b>Actuating speed</b>	mm/s / m/s	0.4 ... 0.5
<b>Minimum actuating force / in activation direction</b>	N	20
<b>Protection class IP</b>		IP65
<b>Built in orientation</b>		any
<b>Cable gland version</b>		M12 plug
<b>Design of the electrical connection</b>		M12 plug, fixed
<b>Design of the plug-in connection</b>		M12 plug, 4-pole: Pin 1 = terminal 21, Pin 2 = 22, Pin 3 = 31, Pin 4 = 32
<b>Item designation</b>		
• according to DIN 40719 extendable after IEC 204-2		S
• according to DIN EN 61346-2		B

#### Certificates/approvals:

General Product Approval		Functional Safety / Safety of Machinery	Test Certificates
--------------------------	--	---	-------------------



CQC

[ROSTEST](#)



UL



VDE

[TÜV](#)

[Manufacturer](#)

other

[Manufacturer](#)

#### Further information:

**Information- and Downloadcenter (Catalogs, Brochures,...)**

<http://www.siemens.com/industrial-controls/catalogs>

**Industry Mall (Online ordering system)**

<http://www.siemens.com/industrial-controls/mall>

**CAX-Online-Generator**

<http://www.siemens.com/cax>

**Service&Support (Manuals, Certificates, Characteristics, FAQs,...)**

<http://support.automation.siemens.com/WW/view/en/3SE5234-0QV40-1AE0/all>

**Image database (product images, 2D dimension drawings, 3D models, device circuit diagrams, ...)**

[http://www.automation.siemens.com/bilddb/cax\\_en.aspx?mlfb=3SE5234-0QV40-1AE0](http://www.automation.siemens.com/bilddb/cax_en.aspx?mlfb=3SE5234-0QV40-1AE0)

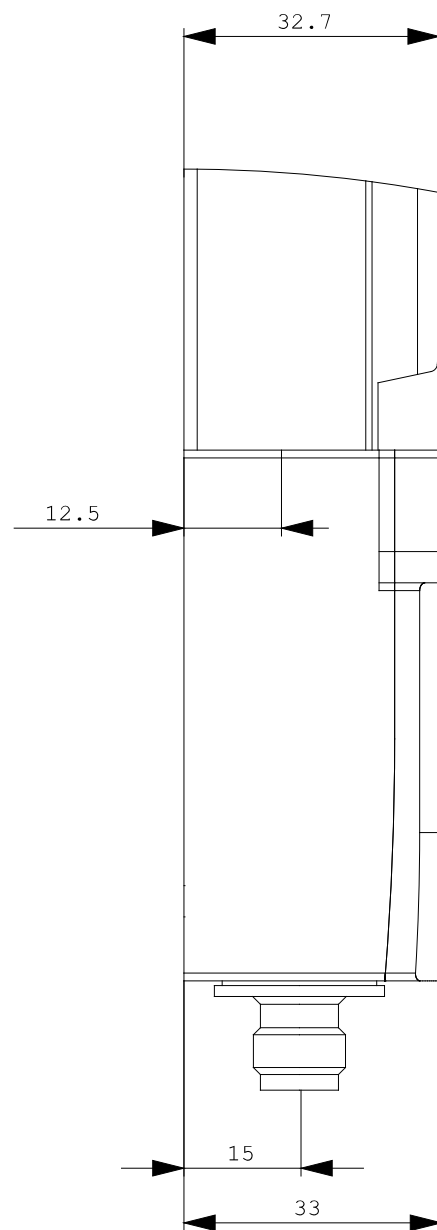
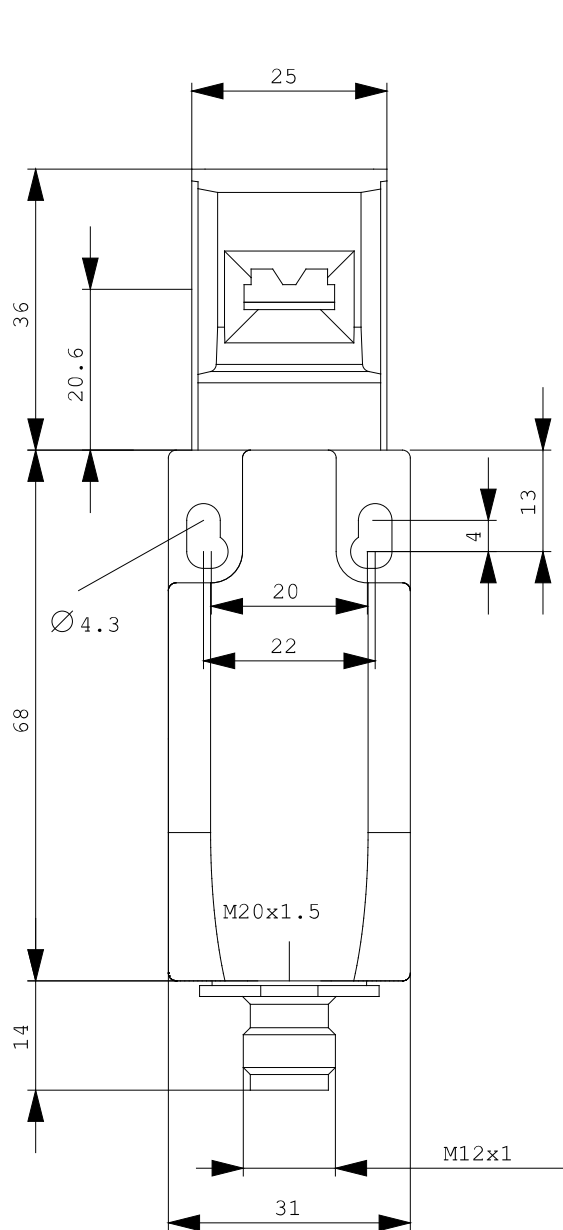

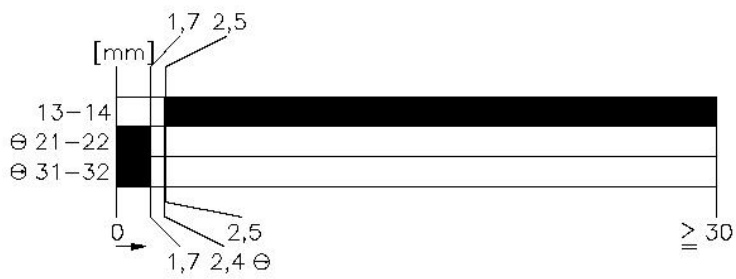

last change:

Nov 24, 2011