



SIRIUS POSITION SWITCH;  
PLASTIC HOUSING ACC. TO EN50047,  
31MM DEVICE CONNECTION 1X (M20X1.5);  
1NO/2NC SNAP-ACTION CONTACTS ROLLER LEVER,  
21MM LONG RIGHT/LEFT SIDE ADJUSTABLE W.  
PLASTIC ROLLER 19MM

Manufacturer article number		
	• of the basic unit included in the scope of supply	<a href="#">3SE5232-0LC05</a>
	• of the actuator head for position switches included in the scope of supply	<a href="#">3SE5000-0AK00</a>
	• of the operating lever included in the scope of supply	<a href="#">3SE5000-0AA21</a>

General technical details:

product designation	standard position switch	
Insulation voltage		
• rated value	V	400
Degree of pollution	class 3	
Thermal current	A	6
Operating current		
• at AC-15		
• at 24 V / rated value	A	6
• at 125 V / rated value	A	6
• at 230 V / rated value	A	1.5
• at DC-13		
• at 24 V / rated value	A	3
• at 125 V / rated value	A	0.55
• at 230 V / rated value	A	0.27
Continuous current		

• of the slow DIAZED fuse link	A	6
• of the quick DIAZED fuse link	A	10
• of the C characteristic circuit breaker	A	1
<b>Mechanical operating cycles as operating time</b>		
• typical		15,000,000
<b>Electrical operating cycles as operating time</b>		
• with contactor 3RH11, 3RT1016, 3RT1017, 3RT1024, 3RT1025, 3RT1026 / typical		10,000,000
• at AC-15 / at 230 V / typical		100,000
<b>Electrical operating cycles in one hour</b>		
• with contactor 3RH11, 3RT1016, 3RT1017, 3RT1024, 3RT1025, 3RT1026		6,000
<b>Repeat accuracy</b>	mm	0.05
<b>Design of the contact element</b>		snap-action contacts
<b>Number of NC contacts</b>		
• for auxiliary contacts		2
<b>Design of the switching function</b>		positive opening
<b>Number of NO contacts</b>		
• for auxiliary contacts		1
<b>Resistance against vibration</b>		0.35 mm / 5g
<b>Resistance against shock</b>		30g / 11 ms
<b>Ambient temperature</b>		
• during operating	°C	-25 ... 85
• during storage	°C	-40 ... 90
<b>Product specification</b>		
• for dimensions		EN 50047
<b>Width of the sensor</b>	mm	31
<b>material</b>		
• of the housing		plastic
<b>Material / of the housing / of the switch head</b>		plastic
<b>Design of the operating mechanism</b>		metal lever, 21 mm long, straight, plastic roller 19 mm
<b>Actuating speed</b>	mm/s / m/s	0.1 ... 1.5
<b>Protection class IP</b>		IP65
<b>Built in orientation</b>		any
<b>Cable gland version</b>		1x (M20 x 1.5)
<b>Design of the electrical connection</b>		screw-type terminals
<b>Item designation</b>		
• according to DIN 40719 extendable after IEC 204-2		S
• according to DIN EN 61346-2		B

## Certificates/approvals:

### General Product Approval

Functional Safety /  
Safety of  
Machinery



CQC



CSA

[ROSTEST](#)



UL



VDE

[TÜV](#)

### Test Certificates

other

[Manufacturer](#)

[other](#)

[Manufacturer](#)

## Further information:

### Information- and Downloadcenter (Catalogs, Brochures,...)

<http://www.siemens.com/industrial-controls/catalogs>

### Industry Mall (Online ordering system)

<http://www.siemens.com/industrial-controls/mall>

### CAX-Online-Generator

<http://www.siemens.com/cax>

### Service&Support (Manuals, Certificates, Characteristics, FAQs,...)

<http://support.automation.siemens.com/WW/view/en/3SE5232-0LK21/all>

### Image database (product images, 2D dimension drawings, 3D models, device circuit diagrams, ...)

[http://www.automation.siemens.com/bilddb/cax\\_en.aspx?mlfb=3SE5232-0LK21](http://www.automation.siemens.com/bilddb/cax_en.aspx?mlfb=3SE5232-0LK21)

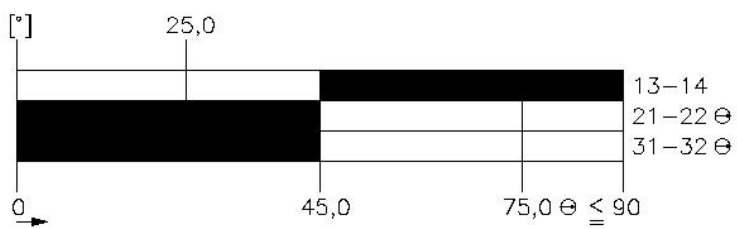
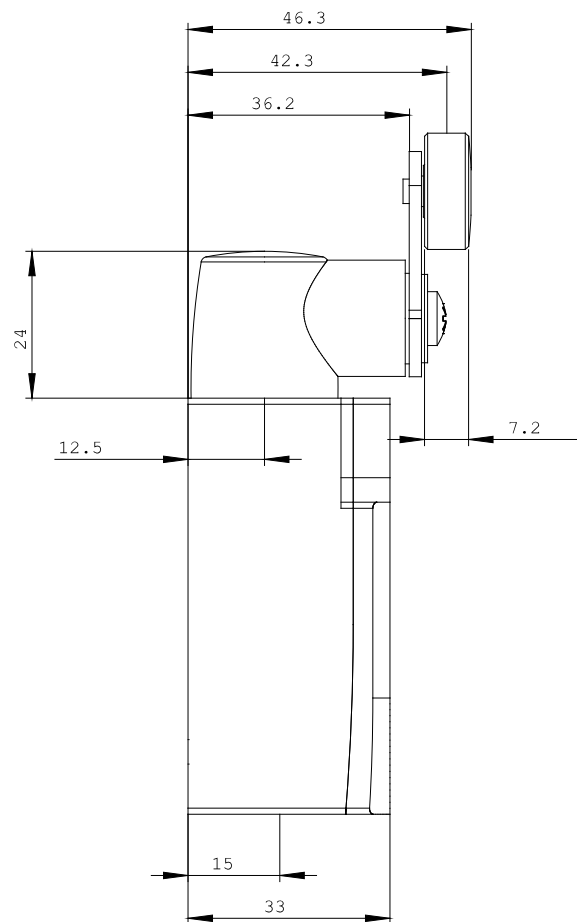
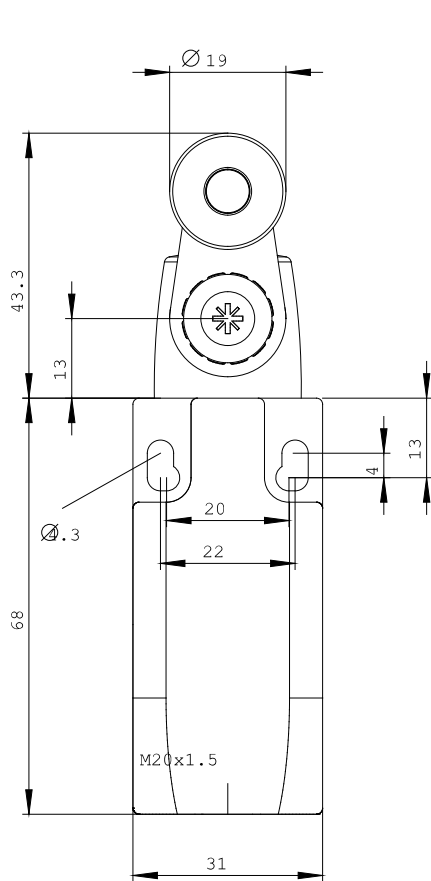

last change:

Nov 24, 2011