

CURRENT MEASURING MODULE;  
SET CURRENT 63...630A;  
OVERALL WIDTH 145MM;  
BUS BAR CONNECTION



### General technical data:

Product brand name		SIRIUS
product designation		current measuring module
Protection class IP		IP00
Built in orientation		any
EMC immunity to interference / according to IEC 60947-1		corresponds to degree of severity 3
Conductor-bound parasitic coupling BURST / according to IEC 61000-4-4		2 kV
Conductor-bound parasitic coupling conductor-earth SURGE / according to IEC 61000-4-5		2 kV
Conductor-bound parasitic coupling conductor-conductor SURGE / according to IEC 61000-4-5		1 kV
Field-bound parasitic coupling / according to IEC 61000-4-3		10 V/m
EMC emitted interference / according to IEC 60947-1		class A
Resistance against vibration		1-6 Hz / 15 mm; 6-500 Hz / 2 g
Impulse voltage resistance / rated value	V	8,000
Insulation voltage / rated value	V	1,000
Number of outputs / as contact-affected switching element		0
Adjustable response current		
<ul style="list-style-type: none"> <li>of the current-dependent overload release</li> <li>initial value</li> </ul>	A	63

• final value	A	630
<b>Product component</b>		
• input for thermistor connection		No
<b>Product function</b>		
• voltage detection		No
• current detection		Yes
<b>Item designation</b>		
• according to DIN EN 61346-2		F
• according to DIN 40719 extendable after IEC 204-2 / according to IEC 750		F

#### Communication:

##### Product function

- bus-communication

No

#### Main circuit:

##### Number of poles / for main current circuit

3

##### Operating frequency

- rated value

Hz

50 ... 60

##### Operating voltage

- at 50 Hz / at AC / rated value
- at 60 Hz / at AC / rated value

V

110 ... 690

V

110 ... 690

#### Control circuit:

##### Type of voltage

- of the controlled supply voltage

AC

#### Installation/mounting/dimensions:

##### Type of mounting

direct mounting / stand-alone installation

##### Width

mm

145

##### Height

mm

147

##### Depth

mm

148

#### Connections:

##### Product function

- removable terminal for auxiliary and control circuit

No

##### Design of the electrical connection

- for main current circuit

busbar connection

#### Ambient conditions:

##### Installation altitude / at a height over sea level / maximum

m

4,000

##### Ambient temperature

• during storage	°C	-40 ... 80
• during operating	°C	-25 ... 60
• during transport	°C	-40 ... 80
<b>Relative humidity / during operating phase</b>	%	5 ... 95

#### Certificates/approvals:

##### Verification of suitability

CE / UL / CSA / CCC / C-TICK / GOST / NOM / ATEX / NEPSI / ABS / DNV / GL / LRS / RoHS

#### Certificates/approvals:

##### General Product Approval

##### For use in hazardous locations



CQC



CSA

[ROSTEST](#)



UL

[CQST](#)

[DEKRA EXAM, DMT](#)

##### Test Certificates

##### Shipping Approval

[Manufacturer](#)



ABS



DNV



GL

##### other

[Manufacturer](#)

[PNO](#)

[other](#)

#### Safety:

##### Protection against electrical shock

finger-safe

#### Further information:

##### Information- and Downloadcenter (Catalogs, Brochures,...)

<http://www.siemens.com/industrial-controls/catalogs>

##### Industry Mall (Online ordering system)

<http://www.siemens.com/industrial-controls/mall>

##### CAX-Online-Generator

<http://www.siemens.com/cax>

##### Service&Support (Manuals, Certificates, Characteristics, FAQs,...)

<http://support.automation.siemens.com/WW/view/en/3UF7104-1BA00-0/all>

##### Image database (product images, 2D dimension drawings, 3D models, device circuit diagrams, ...)

[http://www.automation.siemens.com/bilddb/cax\\_en.aspx?mlfb=3UF7104-1BA00-0](http://www.automation.siemens.com/bilddb/cax_en.aspx?mlfb=3UF7104-1BA00-0)

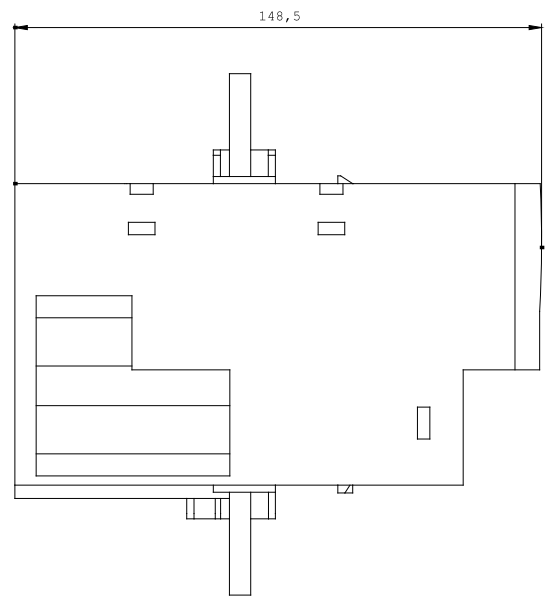
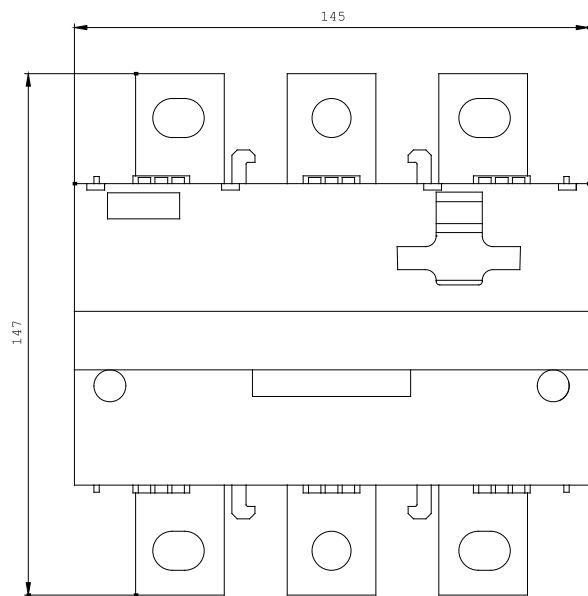

**last change:**

Oct 24, 2011