



CONTACTOR, 90KW/400V/AC-3,  
AC(40...60HZ)/DC OPERATION UC 200...220V AUXIL.  
CONTACTS 2NO+2NC 3-POLE,  
SIZE S6 BAR CONNECTIONS CONVENT. OPERATING  
MECHANISM SCREW TERMINAL

### General details:

|   |    |                                       |
|---|----|---------------------------------------|
| Product brand name  |    | SIRIUS                                |
| product designation   |    | power contactor                       |
| Size of the contactor   |    | S6                                    |
| Protection class IP / on the front  |    | IP00                                  |
| Degree of pollution   |    | 3                                     |
| Installation altitude / at a height over sea level / maximum  | m  | 2,000                                 |
| Ambient temperature / during operating  | °C | -25 ... 60                            |
| Active power loss / per conductor / typical   | W  | 13                                    |
| Item designation  |    |                                       |
| <ul style="list-style-type: none"> <li>• according to DIN EN 61346-2</li> <li>• according to DIN 40719 extendable after IEC 204-2 / according to IEC 750</li> </ul>   |    | Q<br>K                                |
| Mechanical operating cycles as operating time   |    |                                       |
| <ul style="list-style-type: none"> <li>• of the contactor / typical</li> <li>• of the contactor with added auxiliary switch block / typical</li> <li>• of the contactor with added electronics-compatible auxiliary switch block / typical</li> </ul> |    | 10,000,000<br>10,000,000<br>5,000,000 |

### Main circuit:

|  |  |   |
|--|--|---|
| Number of poles / for main current circuit |  | 3 |
|--|--|---|

|  |    |               |
|--|----|---------------|
| <b>Number of NC contacts / for main contacts</b>   |    | 0             |
| <b>Number of NO contacts / for main contacts</b>   |    | 3             |
| <b>Operating current / at AC-1 / at 400 V / at 40 °C ambient temperature / rated value</b> | A  | 215           |
| <b>Operating current / at AC-1 / at 400 V / at 60 °C ambient temperature / rated value</b> | A  | 185           |
| <b>Operating current</b>   |    |               |
| • at AC-3 / at 400 V / rated value   | A  | 185           |
| • with 1 current path  |    |               |
| • at DC-1  |    |               |
| • at 24 V / rated value  | A  | 160           |
| • at 110 V / rated value   | A  | 18            |
| • at DC-3 / at DC-5  |    |               |
| • at 24 V / rated value  | A  | 160           |
| • at 110 V / rated value   | A  | 2.5           |
| • with 2 current paths in series   |    |               |
| • at DC-1  |    |               |
| • at 24 V / rated value  | A  | 160           |
| • at 110 V / rated value   | A  | 160           |
| • at DC-3 / at DC-5  |    |               |
| • at 24 V / rated value  | A  | 160           |
| • at 110 V / rated value   | A  | 160           |
| • with 3 current paths in series   |    |               |
| • at DC-1  |    |               |
| • at 24 V / rated value  | A  | 160           |
| • at 110 V / rated value   | A  | 160           |
| • at DC-3 / at DC-5  |    |               |
| • at 24 V / rated value  | A  | 160           |
| • at 110 V / rated value   | A  | 160           |
| <b>Service power</b>   |    |               |
| • at AC-1 / at 400 V / rated value   | kW | 121           |
| • at AC-2 / at 400 V / rated value   | kW | 104           |
| • at AC-3  |    |               |
| • at 400 V / rated value   | kW | 90            |
| • at 500 V / rated value   | kW | 132           |
| • at 690 V / rated value   | kW | 167           |
| <b>Control circuit:</b>  |    |               |
| <b>Design of activation</b>  |    | conventional  |
| <b>Design of the surge suppressor</b>  |    | with varistor |
| <b>Type of voltage / of the controlled supply voltage</b>                                  |    | AC/DC         |

|   |    |     |
|---|----|-----|
| <b>Control supply voltage frequency</b> |    |     |
| • 1 / rated value                       | Hz | 40  |
| • 2 / rated value                       | Hz | 60  |
| <b>Control supply voltage / 1</b>       |    |     |
| • for DC                                |    |     |
| • initial rated value                   | V  | 200 |
| • final rated value                     | V  | 220 |
| • at 50 Hz / for AC                     |    |     |
| • initial rated value                   | V  | 200 |
| • final rated value                     | V  | 220 |
| • at 60 Hz / for AC                     |    |     |
| • initial rated value                   | V  | 200 |
| • final rated value                     | V  | 220 |

|  |   |   |
|--|---|---|
| <b>Auxiliary circuit:</b>                              |   |   |
| <b>Contact reliability / of the auxiliary contacts</b> |   | 1 faulty switching per 100 million (17 V, 1 mA) |
| <b>Number of NC contacts / for auxiliary contacts</b>  |   |   |
| • instantaneous switching                              |   | 2   |
| • lagging switching                                    |   | 0   |
| <b>Number of NO contacts / for auxiliary contacts</b>  |   |   |
| • instantaneous switching                              |   | 2   |
| • leading switching                                    |   | 0   |
| <b>Operating current / of the auxiliary contacts</b>   |   |   |
| • at AC-12 / maximum                                   | A | 10  |
| • at AC-15   |   |   |
| • at 230 V   | A | 6   |
| • at 400 V   | A | 3   |
| • at DC-12   |   |   |
| • at 60 V  | A | 6   |
| • at 110 V   | A | 3   |
| • at 220 V   | A | 1   |
| • at DC-13   |   |   |
| • at 24 V  | A | 10  |
| • at 60 V  | A | 2   |
| • at 110 V   | A | 1   |
| • at 220 V   | A | 0.3   |

|   |  |                  |
|---|--|------------------|
| <b>Short-circuit:</b>   |  |                  |
| <b>Design of the fuse link</b>                                    |  |                  |
| • for short-circuit protection of the auxiliary switch / required |  | fuse gL/gG: 10 A |
| • for short-circuit protection of the main circuit                |  |                  |

- with type of assignment 1 / required
- at type of coordination 2 / required

fuse gL/gG: 355 A  
fuse gL/gG: 315 A

#### Installation/mounting/dimensions:

|  |    |              |
|--|----|--------------|
| Type of mounting                                       |    | screw fixing |
| series installation                                    |    | Yes          |
| Width  | mm | 120          |
| Height   | mm | 172          |
| Depth  | mm | 180          |
| Distance, to be maintained, to earthed part / sideways | mm | 10           |

#### Connection type:

|   |  |                      |
|---|--|----------------------|
| Design of the electrical connection                     |  |                      |
| • for main current circuit                              |  | screw-type terminals |
| • for auxiliary and control current circuit             |  | screw-type terminals |
| Identification number and letter for switching elements |  | 22 E                 |

#### Certificates/approvals:

##### General Product Approval

##### Functional Safety / Safety of Machinery



CQC



CSA

[KETI](#)

[ROSTEST](#)



UL

[SUVA](#)

##### Test Certificates

##### Shipping Approval

##### other

[Manufacturer](#)



ABS



DNV



GL

[Manufacturer](#)

[other](#)

#### Further information:

##### Information- and Downloadcenter (Catalogs, Brochures,...)

<http://www.siemens.com/industrial-controls/catalogs>

##### Industry Mall (Online ordering system)

<http://www.siemens.com/industrial-controls/mall>

##### CAX-Online-Generator

<http://www.siemens.com/cax>

##### Service&Support (Manuals, Certificates, Characteristics, FAQs,...)

<http://support.automation.siemens.com/WW/view/en/3RT1056-6AM36/all>

##### Image database (product images, 2D dimension drawings, 3D models, device circuit diagrams, ...)

[http://www.automation.siemens.com/bilddb/cax\\_en.aspx?mlfb=3RT1056-6AM36](http://www.automation.siemens.com/bilddb/cax_en.aspx?mlfb=3RT1056-6AM36)

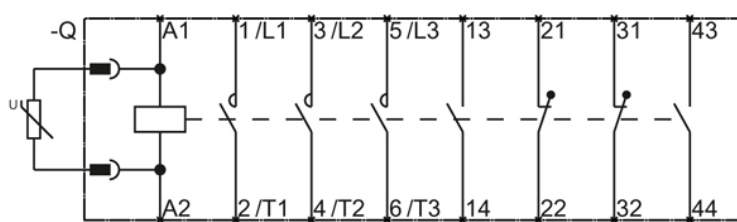
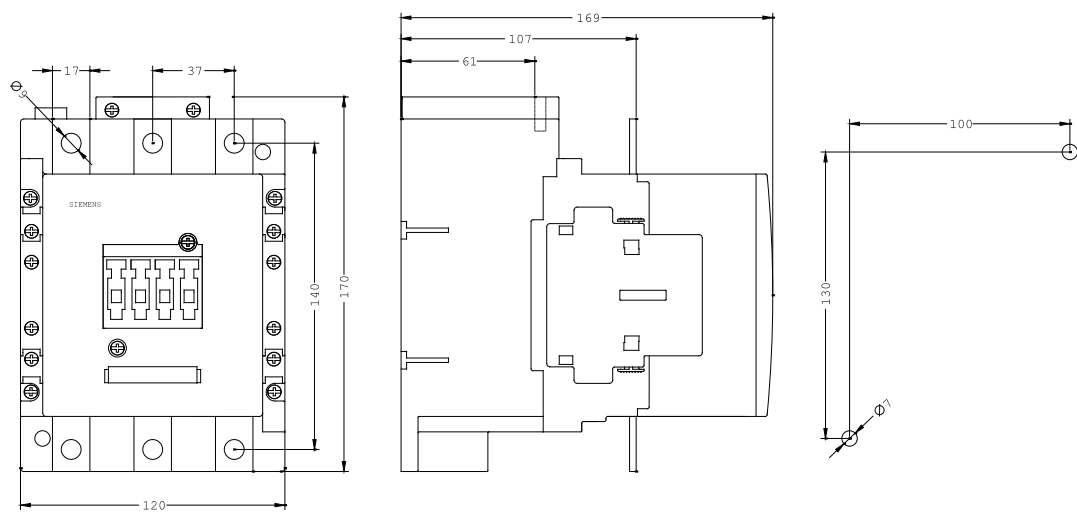

last change:

Sep 30, 2011