



CONTACTOR, 90KW/400V/AC-3,
AC(40...60HZ)/DC OPERATION UC 23...26V AUXIL.
CONTACTS 2NO+2NC 3-POLE,
SIZE S6 BAR CONNECTIONS CONVENT. OPERATING
MECHANISM SCREW TERMINAL

General details:

| | | |
|---|----|---------------------------------------|
| Product brand name | | SIRIUS |
| product designation | | power contactor |
| Size of the contactor | | S6 |
| Protection class IP / on the front | | IP00 |
| Degree of pollution | | 3 |
| Installation altitude / at a height over sea level / maximum | m | 2,000 |
| Ambient temperature / during operating | °C | -25 ... +60 |
| Active power loss / per conductor / typical | W | 13 |
| Item designation | | |
| <ul style="list-style-type: none"> • according to DIN EN 61346-2 • according to DIN 40719 extendable after IEC 204-2 / according to IEC 750 | | Q K |
| Mechanical operating cycles as operating time | | |
| <ul style="list-style-type: none"> • of the contactor / typical • of the contactor with added auxiliary switch block / typical • of the contactor with added electronics-compatible auxiliary switch block / typical | | 10,000,000 10,000,000 5,000,000 |

Main circuit:

| | | |
|--|--|---|
| Number of poles / for main current circuit | | 3 |
|--|--|---|

| | | |
|--|----|---------------|
| Number of NC contacts / for main contacts | | 0 |
| Number of NO contacts / for main contacts | | 3 |
| Operating current / at AC-1 / at 400 V / at 40 °C ambient temperature / rated value | A | 215 |
| Operating current / at AC-1 / at 400 V / at 60 °C ambient temperature / rated value | A | 185 |
| Operating current | | |
| • at AC-3 / at 400 V / rated value | A | 185 |
| • with 1 current path | | |
| • at DC-1 | | |
| • at 24 V / rated value | A | 160 |
| • at 110 V / rated value | A | 18 |
| • at DC-3 / at DC-5 | | |
| • at 24 V / rated value | A | 160 |
| • at 110 V / rated value | A | 2.5 |
| • with 2 current paths in series | | |
| • at DC-1 | | |
| • at 24 V / rated value | A | 160 |
| • at 110 V / rated value | A | 160 |
| • at DC-3 / at DC-5 | | |
| • at 24 V / rated value | A | 160 |
| • at 110 V / rated value | A | 160 |
| • with 3 current paths in series | | |
| • at DC-1 | | |
| • at 24 V / rated value | A | 160 |
| • at 110 V / rated value | A | 160 |
| • at DC-3 / at DC-5 | | |
| • at 24 V / rated value | A | 160 |
| • at 110 V / rated value | A | 160 |
| Service power | | |
| • at AC-1 / at 400 V / rated value | kW | 121 |
| • at AC-2 / at 400 V / rated value | kW | 104 |
| • at AC-3 | | |
| • at 400 V / rated value | kW | 90 |
| • at 500 V / rated value | kW | 132 |
| • at 690 V / rated value | kW | 167 |
| Control circuit: | | |
| Design of activation | | conventional |
| Design of the surge suppressor | | with varistor |
| Type of voltage / of the controlled supply voltage | | AC/DC |

| | | |
|---|----|----|
| Control supply voltage frequency | | |
| • 1 / rated value | Hz | 40 |
| • 2 / rated value | Hz | 60 |
| Control supply voltage / 1 | | |
| • for DC | | |
| • initial rated value | V | 23 |
| • final rated value | V | 26 |
| • at 50 Hz / for AC | | |
| • initial rated value | V | 23 |
| • final rated value | V | 26 |
| • at 60 Hz / for AC | | |
| • initial rated value | V | 23 |
| • final rated value | V | 26 |

| | | |
|--|---|---|
| Auxiliary circuit: | | |
| Contact reliability / of the auxiliary contacts | | 1 faulty switching per 100 million (17 V, 1 mA) |
| Number of NC contacts / for auxiliary contacts | | |
| • instantaneous switching | | 2 |
| • lagging switching | | 0 |
| Number of NO contacts / for auxiliary contacts | | |
| • instantaneous switching | | 2 |
| • leading switching | | 0 |
| Operating current / of the auxiliary contacts | | |
| • at AC-12 / maximum | A | 10 |
| • at AC-15 | | |
| • at 230 V | A | 6 |
| • at 400 V | A | 3 |
| • at DC-12 | | |
| • at 60 V | A | 6 |
| • at 110 V | A | 3 |
| • at 220 V | A | 1 |
| • at DC-13 | | |
| • at 24 V | A | 10 |
| • at 60 V | A | 2 |
| • at 110 V | A | 1 |
| • at 220 V | A | 0.3 |

| | | |
|---|--|------------------|
| Short-circuit: | | |
| Design of the fuse link | | |
| • for short-circuit protection of the auxiliary switch / required | | fuse gL/gG: 10 A |
| • for short-circuit protection of the main circuit | | |

- with type of assignment 1 / required
- at type of coordination 2 / required

fuse gL/gG: 355 A

fuse gL/gG: 315 A

Installation/mounting/dimensions:

Type of mounting

screw fixing

series installation

Yes

Width

mm 120

Height

mm 172

Depth

mm 180

Distance, to be maintained, to earthed part / sideways

mm 10

Connection type:

Design of the electrical connection

- for main current circuit
- for auxiliary and control current circuit

screw-type terminals

screw-type terminals

Identification number and letter for switching elements

22 E

Certificates/approvals:

General Product Approval

Functional Safety / Safety of Machinery



CQC



CSA

[ROSTEST](#)



UL

[SUVA](#)

Test Certificates

Shipping Approval

[Manufacturer](#)

[other](#)



ABS



DNV



GL

other

[Manufacturer](#)

[other](#)

Further information:

Information- and Downloadcenter (Catalogs, Brochures,...)

<http://www.siemens.com/industrial-controls/catalogs>

Industry Mall (Online ordering system)

<http://www.siemens.com/industrial-controls/mall>

CAX-Online-Generator

<http://www.siemens.com/cax>

Service&Support (Manuals, Certificates, Characteristics, FAQs,...)

<http://support.automation.siemens.com/WW/view/en/3RT1056-6AB36/all>

Image database (product images, 2D dimension drawings, 3D models, device circuit diagrams, ...)

http://www.automation.siemens.com/bilddb/cax_en.aspx?mlfb=3RT1056-6AB36

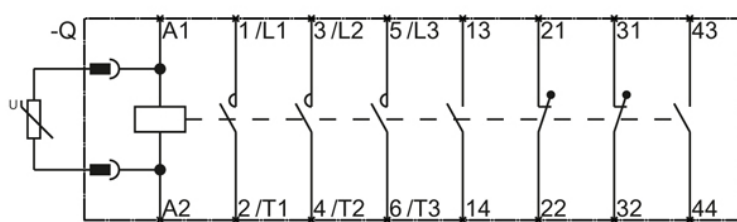
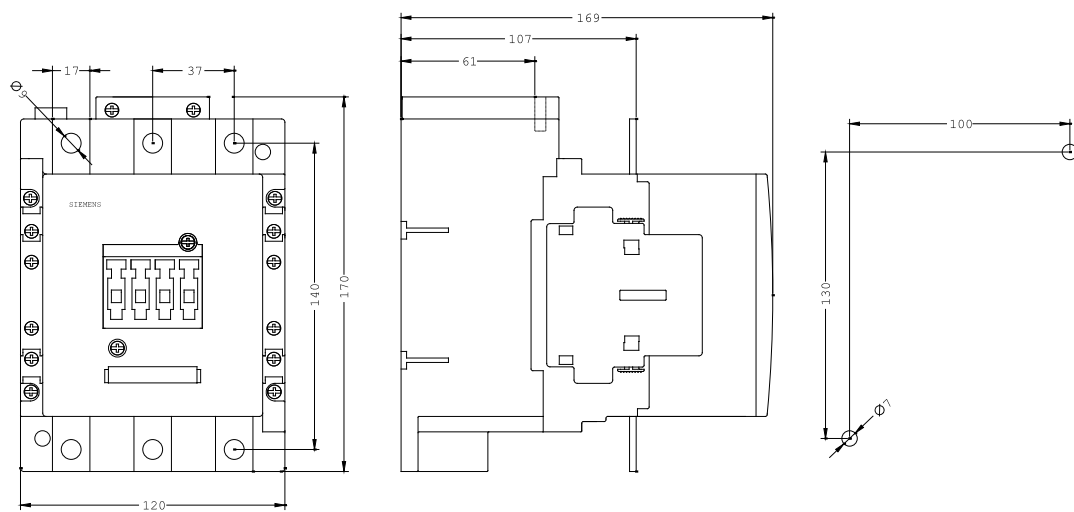

last change:

Sep 30, 2011