

Bolted lug BLMT 25/95-13

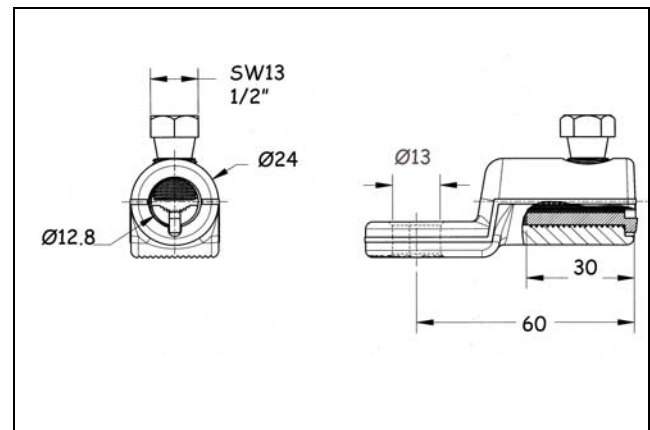

Application:

- Designed for use in underground cables terminations up to 36 kV

Description: The bolted lug is made of:

- A tin plated forged aluminium alloy body with barrel having an axial centralised bore, its inner threaded entries providing good electrical contact with wires to be connected. The blocked barrel feature prevents moisture between palm and barrel.
- 1 aluminium alloy clamping bolt with a shear head in order to control the nominal optimum tightening torque.
- 1 aluminium insert fitted on the connector and to be used on the small sizes of conductors

Features and benefits:

Conductor sizes: 25 to 95 mm ² Aluminium or copper conductor	Range taking
<i>Material:</i> Body: high strength tin plated al-alloy Bolts: aluminium alloy with special treatment	Good electrical performance Connection on aluminium or copper cable
Solid moisture block between palm and barrel	Prevents water passing through the palm to the barrel
Equipped with shear bolts (13mm head)	No special tool
Compliance with IEC 61238-1 class A	Reliable
Centralised bore and insert	Reduced step down of the cable
2 shear points	Shear bolts do not stand proud more than 2mm after shear off
Grooves on the bottom of the palm	Improvement of contact
Distance between bottom of the palm and barrel of minimum 3mm	Allows room for insulation
Width of palm same as width of barrel	Suitable for any type of terminations
Large sealing length	Improves water tightness

Energy Division

<http://energy.tycoelectronics.com>

All of the above information, including drawings, illustrations and graphic designs, reflects our present understanding and is to the best of our knowledge and belief correct and reliable. Users, however, should independently evaluate the suitability of each product for the desired application. Under no circumstances does this constitute an assurance of any particular quality or performance. Such an assurance is only provided in the context of our product specifications or explicit contractual arrangements. Our liability for these products is set forth in our standard terms and conditions of sale.

ALR, AMP, AXICOM, B&H, Bowthorpe EMP, Critchley, Dorman Smith, Dulmison, Hellstern, La Prairie, Morlynn, Raychem, SIMEL and SUCOFIT are trademarks.

Bolted lug BLMT 25/95-13

Characteristics:

Description	Palm hole D (mm)	Pn	RPN	Cross Section mm ²	PPQ	Weight (g)
BLMT 25/95-13	13	7-1201353-9	E44865-000	95-240	3	205

Application - Diameter range table:

	AL			CU		
	RM ROUND STRANDED	RE ROUND SOLID	SM SECTOR STRANDED	RM ROUND STRANDED	RE ROUND SOLID	SM SECTOR STRANDED
Conductor cross section in Sqmm Querschnittsbereich	25-95	25-95	25-70 (95 gerundet) (95 with rounding)	16-95	10-50	25-70 (95 gerundet) (95 with rounding)
Conductor Ø in mm Leiterdurchmesser	Ø 5.7 - Ø 12.5	Ø 5,5 - Ø 11	-	Ø 4,8 - Ø 12.5	Ø 3,6 - Ø 8	-

Patents:

PCT/GB/00311 and GB2281599

Energy Division

<http://energy.tycoelectronics.com>

All of the above information, including drawings, illustrations and graphic designs, reflects our present understanding and is to the best of our knowledge and belief correct and reliable. Users, however, should independently evaluate the suitability of each product for the desired application. Under no circumstances does this constitute an assurance of any particular quality or performance. Such an assurance is only provided in the context of our product specifications or explicit contractual arrangements. Our liability for these products is set forth in our standard terms and conditions of sale.

ALR, AMP, AXICOM, B&H, Bowthorpe EMP, Critchley, Dorman Smith, Dulmison, Hellstern, La Prairie, Morlynn, Raychem, SIMEL and SUCOFIT are trademarks.

SIMEL

Tyco Electronics SIMEL S.A.S. – Energy Division

Route de Saulon · F-21220 Gevrey-Chambertin · Tel. (033) 3.80.58.32.00 · Fax (033) 3.80.34.10.15