

Tube end plugs for round tubes

Item description/product images



Description

Material:
Polyethylene

Version:
black.

Note:
These plugs are for corner protection and plugging the tube ends. They can be pushed in by hand or tapped in with a plastic hammer.

Drawings

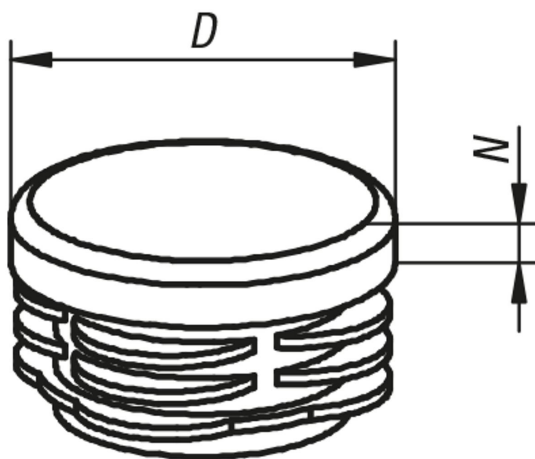

Overview of items

Order No.	Version 2	D	N	Suitable for
K0494.018150	for round tubes	18	5	Ø18X1,5
K0494.020200	for round tubes	20	5	Ø20X2
K0494.025200	for round tubes	25	5	Ø25X2
K0494.030200	for round tubes	30	5	Ø30X2
K0494.040300	for round tubes	40	5	Ø40X3
K0494.040400	for round tubes	40	5	Ø40X4
K0494.050400	for round tubes	50	5	Ø50X3 / Ø50X4