

Area of Application:  
Table mounted  
Water

Max. working pressure 10 bar  
Temperature range 5°C-90°C

Details:  
Ceramic non-closing mixing valve  
3-Zone colour, acc. to EN13792:2002

Materials in media contact:  
Brass  
Rubber, EPDM  
Silicone based lubricant  
Ceramic  
POM

Mounting:  
M40x1,5 nut with o-ring and washer

Inlet / outlet connection:  
ISO228/1-G1/2  
UniFlex

Metal handle

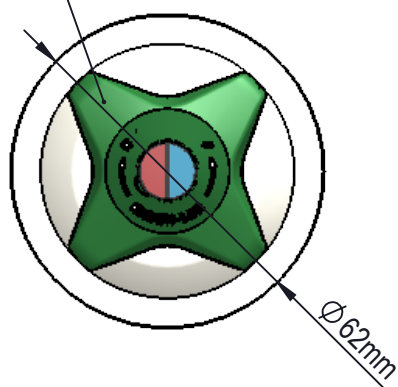

Length of UniFlex connection hose 700mm

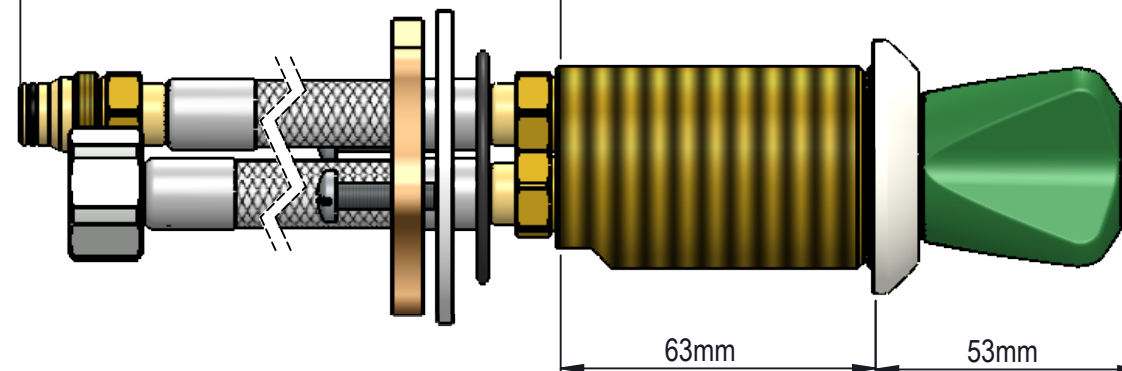

Hot inlet

Cold inlet

Connection hose to sensortap  
Standard SPX hose 700mm

Built-in check valves  
for hot and cold inlet

M40x1

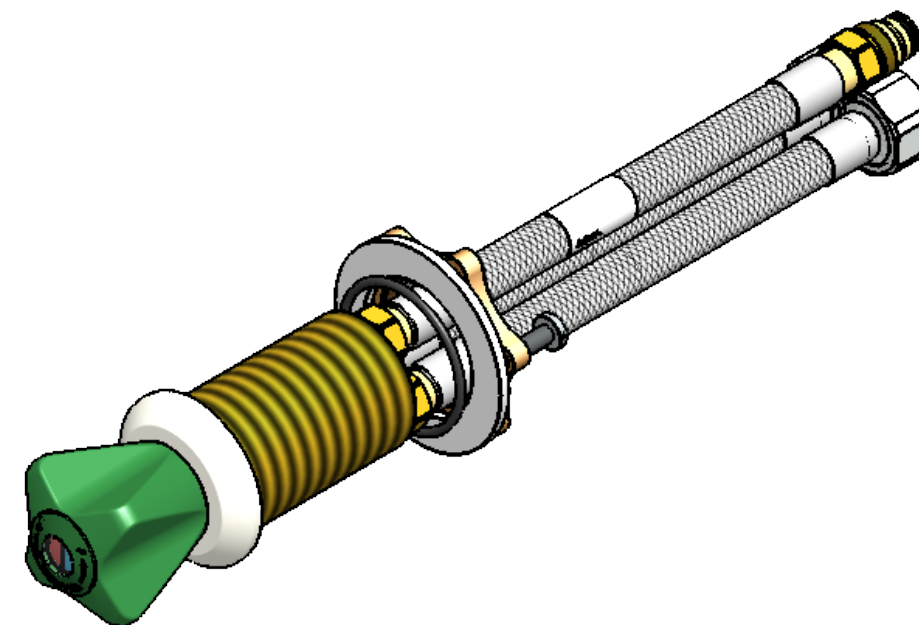

Description: 1-Hand.Mix, Table mounted, M40x1,5 nut with o-ring and washer, , ISO228/1-G1/2

							Media:	Water		
							Comments:	Temperature regulating valve		
							Drawing type:	Customer drawing	Weight:	1.278 Kg
B		04-12-19			roe		Designed by:	SJE	Released on TM No.	7176
Rev.	Pos.	Date	TM No.	Design by	Drawn by:	Change:	Drawn by:	SJE	Date:	23-08-18
<b>BROEN-LAB</b>						This drawing is our property and cannot be given to a third party, copied or otherwise used without our permission. BROEN-LAB A/S.	Format:	Drawing No.: 26020021035E		
							A3			