

ZONE 1,21&2,22

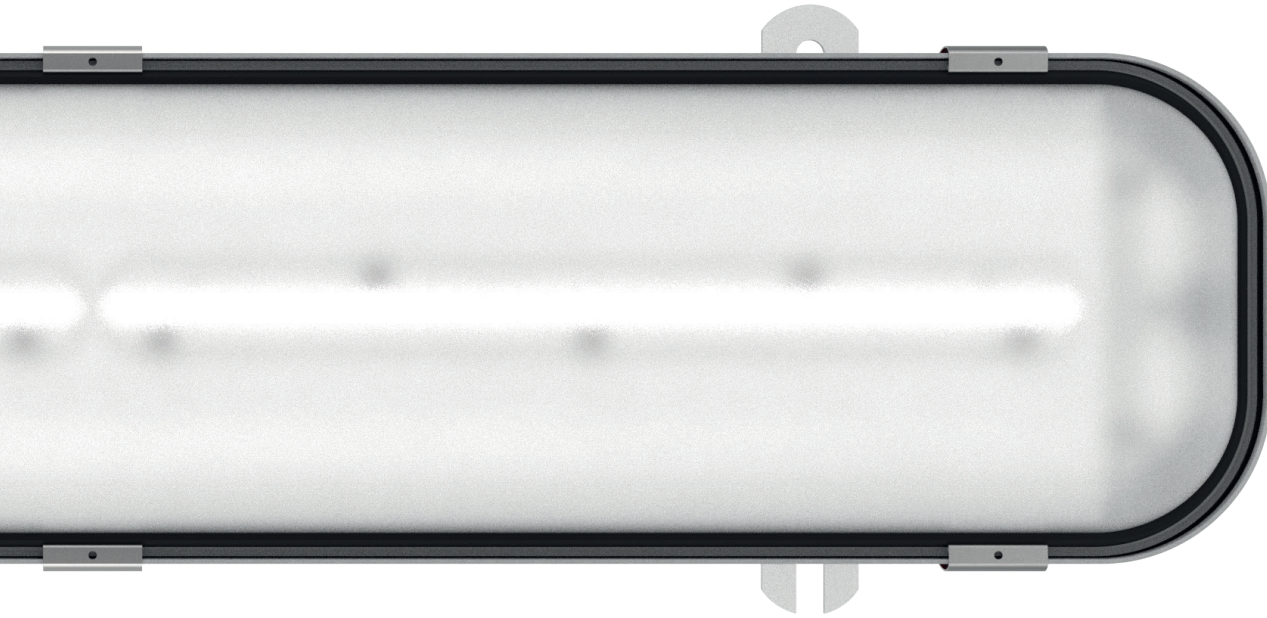

EXF250LED

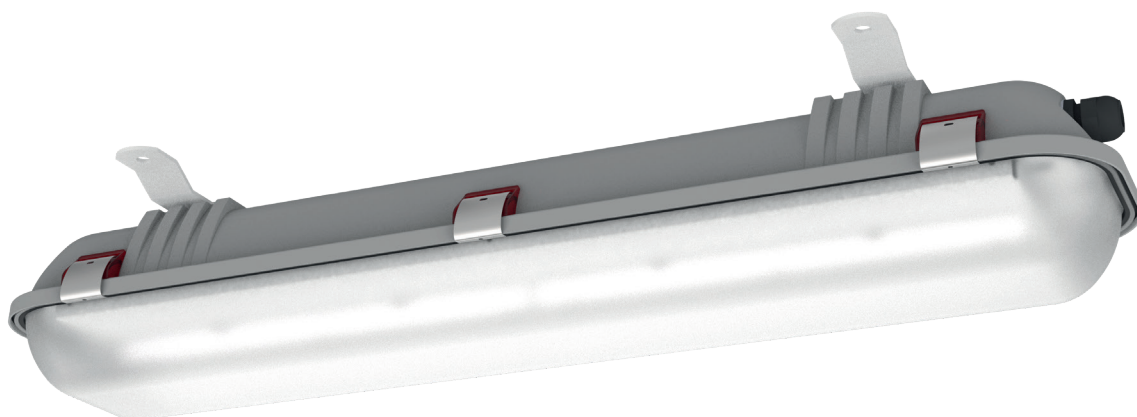



KDB 15ATEX0049X  
IECEX KDB 20.0003X

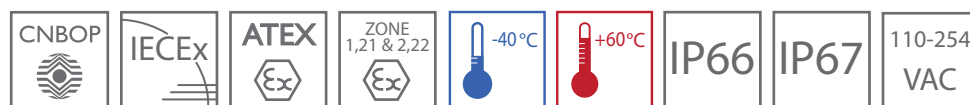

EX MARKING:

Ex II 2G Ex eb mb op is IIC T5 Gb  
Ex II 2D Ex tb op is IIIC T55°C Db or T70°C Db

## EXEMPLARY APPLICATIONS



REFINERIES



OFFSHORE



CHEMICAL  
PLANTS



CHEMICAL  
WAREHOUSES



PASSAGEWAYS  
IN EX ZONES







Explosionproof light fitting with **LED modules** for suspended coffered ceilings or to be mounted on the ceiling surface. Designed to work in the zone **1.21 & 2.22** of the explosion hazard of gases, vapors and mists of flammable liquids with air, as well as of flammable dusts and fibers. The housing is made of powder coated steel or stainless steel.

Optional version with autonomous **A3** power source or **ZB** central battery.







## FEATURES





## MECHANICAL PARAMETERS

	housing	glass fibre reinforced polyester (GRP)
	diffuser	polymethyl methacrylate (PMMA) or UV stabilised polycarbonate
	ingress protection	IP66, IP67
	protection class	I
	mounting	on the surface or with connections
	accessories	mounting accessories

## ELECTRICAL PARAMETERS

2,5 mm <sup>2</sup>	connection terminals	
110-254 VAC (50-60Hz), 220-250 VDC	input voltage	
intrinsically safe LED modules	light source	
>0,97	power factor	
Ø20	cable inlets	
2 kV	overvoltage protection	

## WORK PARAMETERS

	ambient temperature	-40°C to +60°C <i>check: types comparison</i>
	lifetime	>70.000h L <sub>80</sub> B <sub>10</sub>

## PHOTOMETRICAL PARAMETERS

>80	CRI	
6500K 4000K - option	colour temperature	

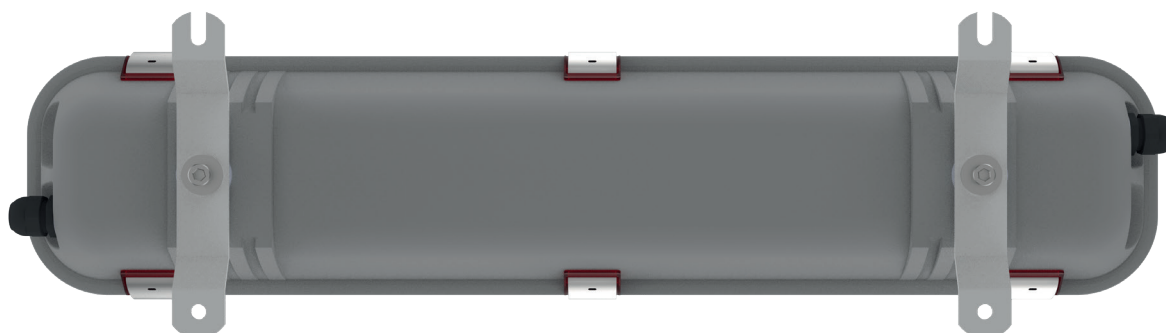

## DIMENSIONS

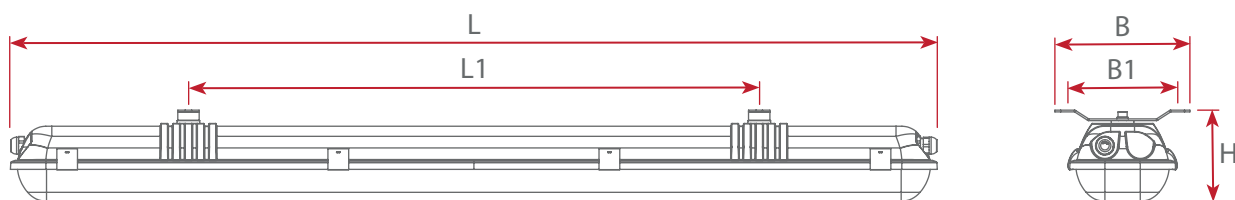

TYPES	L [mm]	L1 [mm]	B [mm]	B1 [mm]	H [mm]
EXF250LED-0600	700	450	190	160	129
EXF250LED-1200	1300	800	190	160	129

## TYPES COMPARISON

## VERSION HIGH OUTPUT (HO) +45°C

TYPE OF THE LIGHTING	LUMINOUS FLUX [lm]	POWER SUPPLY [W]	EFFICIENCY [lm/W]	MAX. AMB. TEMP. [°C]
EXF250LED-0600-F1	1869	21,2	87	45
EXF250LED-0600-F2	3816	38,6	100	45
EXF250LED-1200-F2	4104	38,6	104	45
EXF250LED-1200-F4	7753	78,1	100	45

## VERSION HIGH TEMPERATURE (HT) +55°C

TYPE OF THE LIGHTING	LUMINOUS FLUX [lm]	POWER SUPPLY [W]	EFFICIENCY [lm/W]	MAX. AMB. TEMP. [°C]
EXF250LED-1200-G4	4840	47,0	106	55

## VERSION HIGH TEMPERATURE (HT) +60°C

TYPE OF THE LIGHTING	LUMINOUS FLUX [lm]	POWER SUPPLY [W]	EFFICIENCY [lm/W]	MAX. AMB. TEMP. [°C]
EXF250LED-0600-G2	2566	25,3	102	60
EXF250LED-1200-G2	2468	25,3	98	60



Luminous flux tolerance +/- 10%

Power tolerance +/- 10%

The parameters given in the following data sheet has been determined for the temperature  $T_a=25^{\circ}\text{C}$ .

Luminous flux, light intensity distribution and efficiency has been tested on the basis of the standards EN ISO 17025:2005, norm series EN13032 and LM-79.

The actual data and General Warranty Conditions are available on our website [www.atmlighting.pl](http://www.atmlighting.pl)

## OPTIONAL VERSIONS



Emergency power module:

Version with 3h emergency power module. The possibility of work above  $0^{\circ}\text{C}$ .

## MEAN EMERGENCY MODE LUMINOUS FLUX

TYPE OF THE FITTING	VERSION A3 [lm]
EXF250LED-0600-F1	88
EXF250LED-0600-F2	179
EXF250LED-0600-G2	121
EXF250LED-1200-F2	193
EXF250LED-1200-F4	193
EXF250LED-1200-G2	116
EXF250LED-1200-G4	227



Central battery:

Version with a driver for central battery.

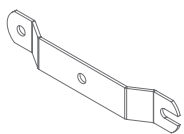

## MOUNTINGS

**AMO1**

standard mounting bracket made of 1.5mm thick steel, mounting hole spacing 190mm

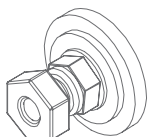
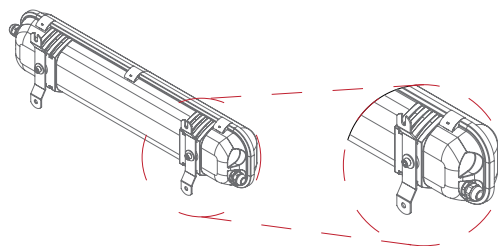
**BK**

standard bolt kit made to install the light fitting on the thin surfaces or the cable trays

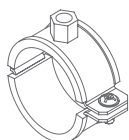
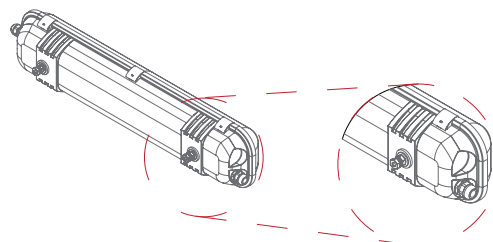
**AMO3**

stainless steel hoop for pipe of diameter 60-63mm

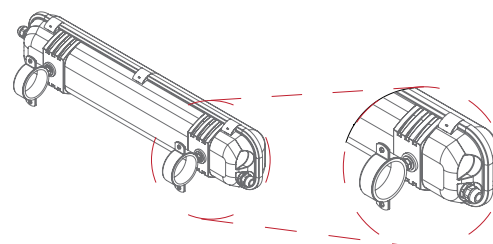
**AMO4**

bracket for installation at 45°

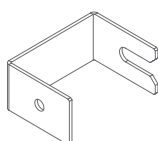
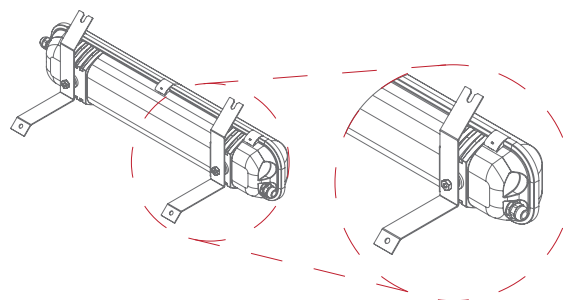
**AMO5**

68mm distance bracket

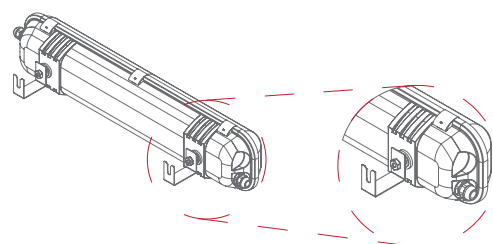

PHOTOMETRY

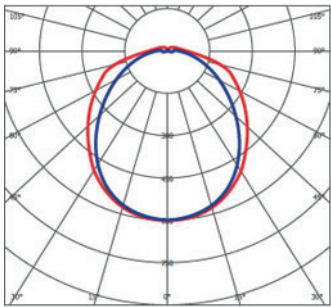

CONFIGURATIONS

E X F 2 5 0 L E D														- 3 5 E -				20		GRP							
<b>group</b> explosionproof light fittings										0 6 0 0		F 1		30		10		M		25				PM		A3	
<b>type</b> type 250										1 2 0 0		G 2		33		11		P						PC		ZB	
<b>source of light</b> LED modules												4		40		20*											
<b>approximate length</b> ~ 600mm, 1200mm														44		21*											
<b>LED module type</b>																22*											
<b>LED module quantity</b>																											
<b>power supply</b> 35E - 230V, 0/50÷60Hz																											
<b>wiring</b>																											
30 - single 3-pole terminal										→		3															
33 - double 3-pole terminal										→		3		3		←											
40 - single 4-pole terminal										→		4															
44 - double 4-pole terminal										→		4		4		←											
<b>cable inlets - quantity</b>																											
10 - one cable inlet at one side										→		1		0													
11 - one cable inlet at both sides										→		1		1		←											
20 - two cable inlets at one side										→		2		0													
21 - two cable inlets at one side and one at the another										→		2		1		←											
22 - two cable inlets at both sides										→		2		2		←											
<b>cable inlets - material</b>																											
M - metal																											
P - plastic																											
<b>cable inlets - size</b>																											
20 - Ø20																											
25 - Ø25																											
<b>housing material</b>																											
GRP - glass fiber reinforced polyester																											
<b>diffuser material</b>																											
PM - polymethyl methacrylate (PMMA)																											
PC - UV stabilised polycarbonate																											
<b>emergency versions</b>																											
A3 - version with 3h emergency power module available only with 34E power supply (250V, 50-60Hz). Works in the temperature above 0°C.																											
Configuration 11P20 is NOT available for the emergency version 0600...-A3																											
ZB - version with driver for central battery																											

DOWNLOADS

