

Mechanical Splice

1 Strip for 250 um cable:

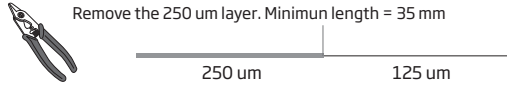

Strip for 900um cable:

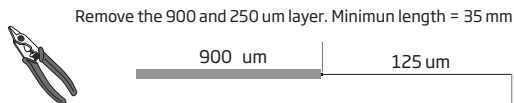

Use wipes and alcohol (isopropilic) to clean.

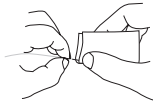

Clean fibre. Wipe shouldn't be completely wet.

Drawing: Locking-buttons

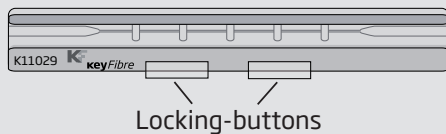

Locking-buttons

4a Push the appropriate locking-button (the closest to the fibre) to fix cable.

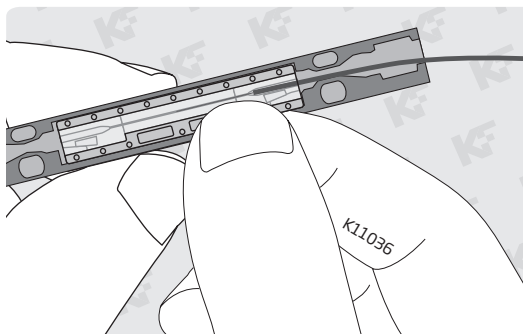

2 Using the KeyCleave® ruler, cleave fibre to the required length

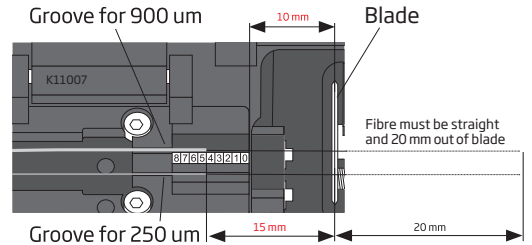

Final measures:

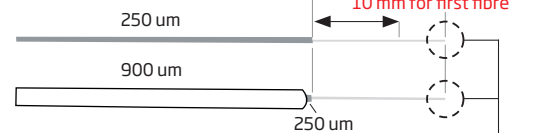

! Fibre must enter directly inside without touching anything.

3 Using the fibre cleaved to 15mm, insert it to the end.

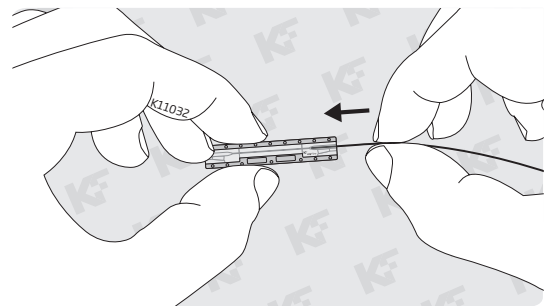

4b Locking-button completely pressed to hold fibre.

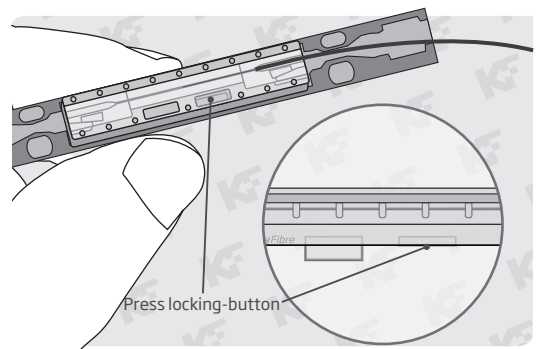

Mechanical Splice

- 5** Repeat on the other side with the fibre cleaved to 10mm.

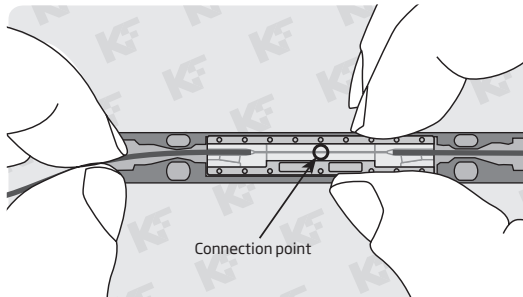

*Make sure to push locking-buttons to the end.

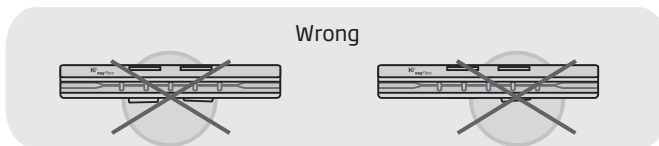

Wrong



Right



Form a curve and press two locking-buttons completely.

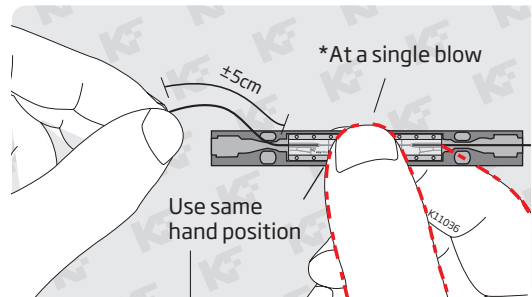

Please take note about the importance of a correct handling of the mechanical splice to press MS buttons

- 7** Job is done.

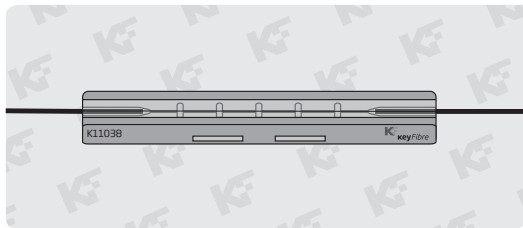

Release Method

Use KeyFibre® Release Key to push locking-buttons up.

Release key

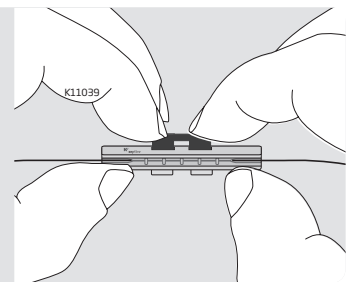

- B1** If you connect a pigtail, use Visual Fault Locator.

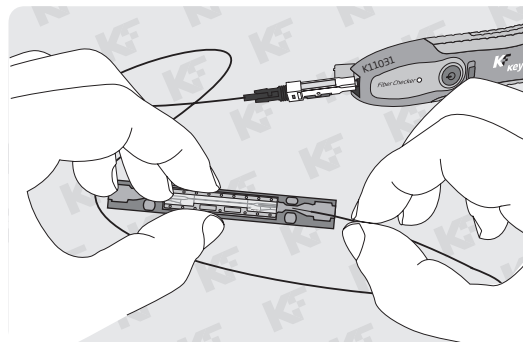

- B2** Form a curve on the fibre and press locking-buttons. Light disappears → perfect connection.

