



Cód. 50121535

Audio and Video  
door entry system

(Mechanical assembly  
of the door panel)

# Nexa Modular

Assembly manual

**Tnexa Modular ML** rev.0112

First of all we would like to thank and congratulate you for the purchase of this product manufactured by Golmar.

The commitment to reach the satisfaction of our customers is stated through the ISO-9001 certification and for the manufacturing of products like this one.

Its advanced technology and exacting quality control will do that customers and users enjoy with the legion of features this system offers. To obtain the maximum profit of these features and a properly wired installation, we kindly recommend you to expend a few minutes of your time to read this manual.

## INDEX

Introduction .....	21	Assembly the electronic modules .....	24
Index.....	21	Hold the frame .....	25
<b>Important</b> .....	21	<b>Connection and configuration</b> .....	25
Door panel description .....	21-22	Close the frame.....	25
Door panel installation .....		Door panel assembly .....	26
Embedding box positioning .....	23	Double door panel assembly.....	27
Embedding box installation .....	23-24	Close the door panel.....	28

## IMPORTANT

➡ **See user manual corresponding for details of connection, configuration and programming system (it is supplied with the sound module).**

➡ **User manual reference:**

    ➡ **4+ N system, user manual T655.**

    ➡ **Vista system, user manual T631/R5.**

    ➡ **Plus system, user manual T631/Plus.**

## DOOR PANEL DESCRIPTION

**D**oor panel description.

General detail of parts, for assembly the door panel.

Embedding boxes

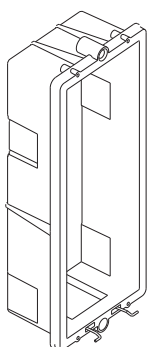

Frame modules

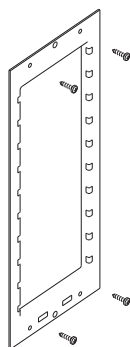

Electronic modules

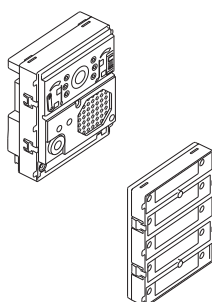

Aluminium door panel

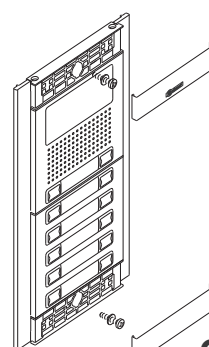

**Continue**

**Coming from previous page**

Door panel description.

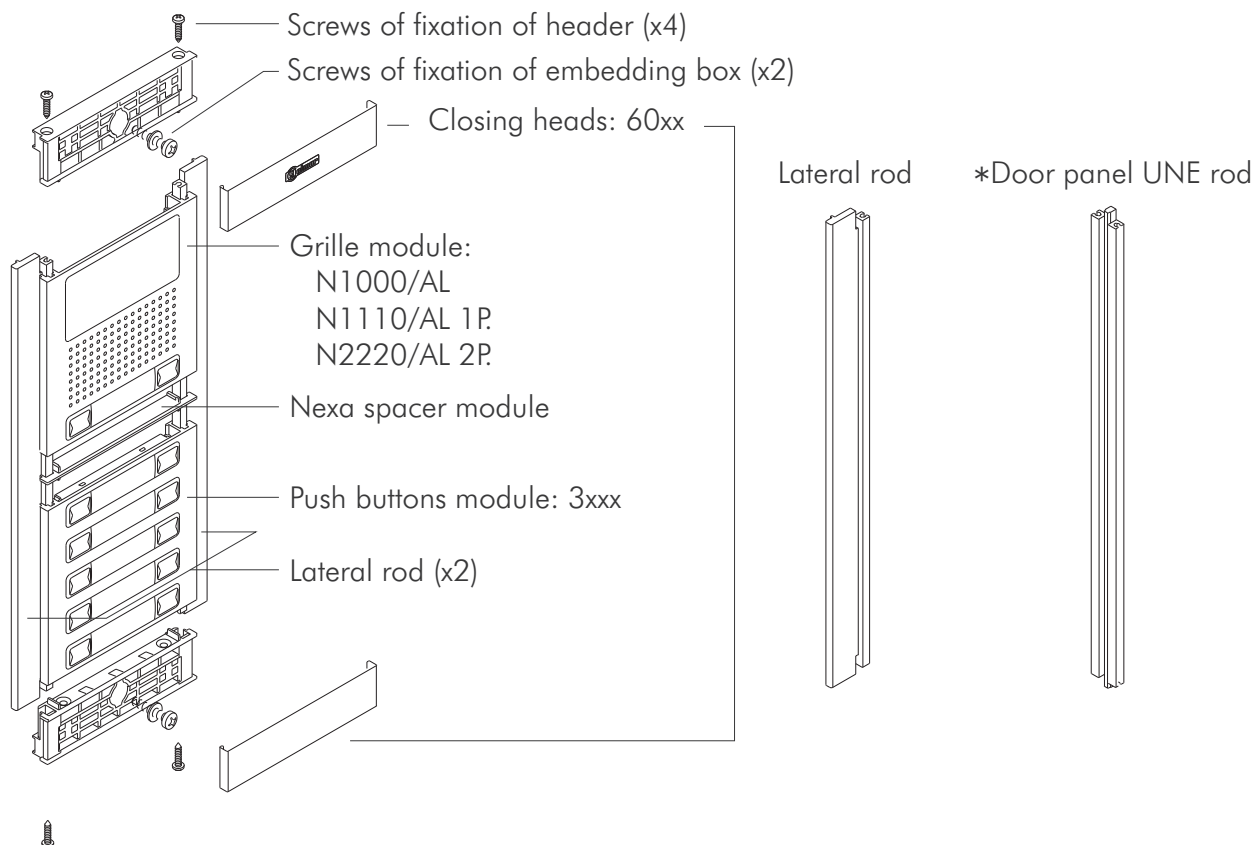

\* Door panel UNE rod: It allows to join 2 door panels, (see page 27).

**Sound module**

EL655 , sound module (4+N installation).

EL631/R5 , sound module with color camera (Vista installation).

EL631/Plus, sound module with color camera (Plus installation).

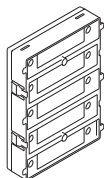
**Push buttons electronic module**

EL610A, for 5 single or 10 double push buttons (4+N installation).

EL610D, for 5 single or 10 double push buttons (Vista and Plus installation).

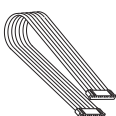
**Short connection cable**

It is supplied with EL610A module "length: 8 cm" (4+N installation).

It is supplied with EL610D module "length: 16 cm" (Vista and Plus installation).

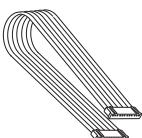
**Connection cable**

RAP-610A "code: 11895610, length: 55 cm" (4+N installation).

RAP-610D "code: 11895710, length: 27 cm" (Vista and Plus installation).

## E mbedding box positioning.

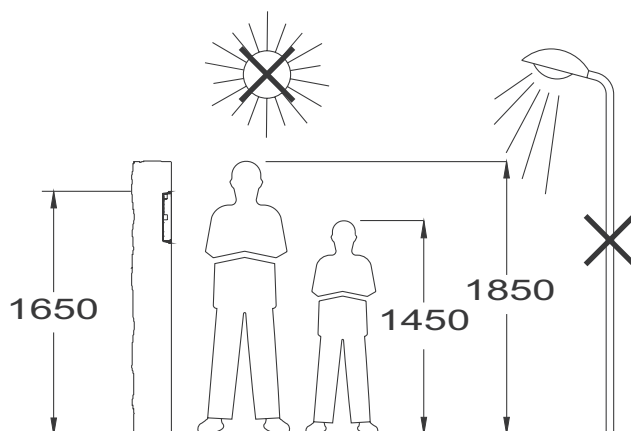

The upper part of the door panel should be placed at 1,65m. height roughly. The hole dimensions will depend on the type of door panel.

Modules	1	2	3
Model	NCEV90CS	NCEV90C	CEV90
An	99	99	99 mm.
Al	135,5	238	328 mm.
P	40	56	56 mm.

The door panel has been designed to be placed under most of the environmental conditions. However it's recommended to take additional cautions like covered places. To obtain a good quality picture on video door entry systems, avoid direct incidence from light sources.

## P reparing the cables entry.

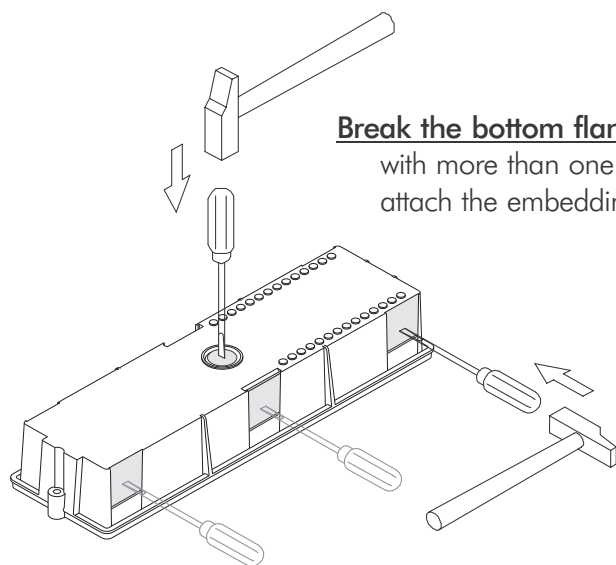

**Break the bottom flange** to pass the cables through. In case of door panels with more than one embedding box, break the side flanges and attach the embedding boxes using UC junctions.

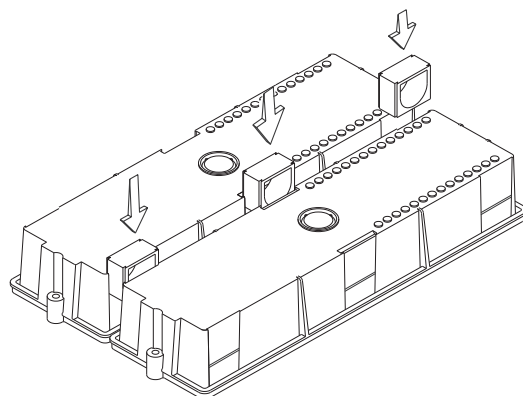

**P**lace the embedding box.

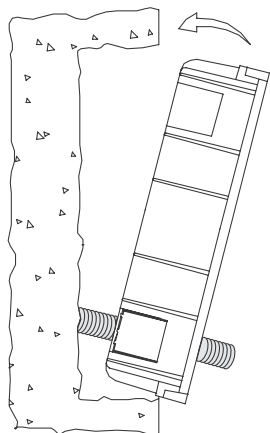

Pass the wiring through the hole made in the bottom part of the embedding box. Level and flush the embedding box. Once the embedding box is placed, remove the protective labels from the attaching door panel holes.

**A**ssemble the electronic modules.

Insert the sound module in the top part of the module frame.

Align the tabs on the sound module in their respective housings of the module frame and then exercise a light pressure until correct placement.

If there is push buttons module repeat the above process, locating under the sound module, as shown in the drawing.

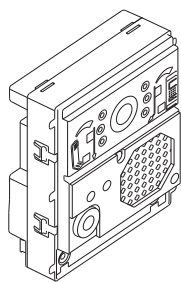
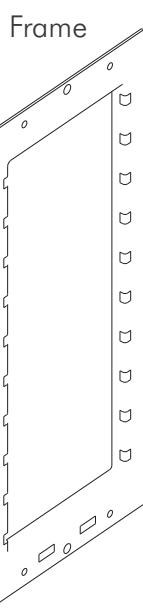
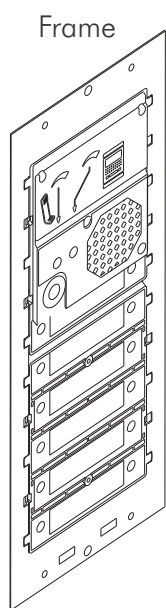

Sound module:  
EL655 (4+N).  
EL631/R5 (Vista).  
EL631/Plus (Plus).

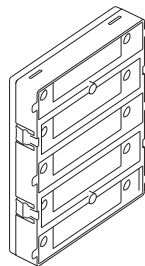

Push buttons electronic module:  
EL610A (4+N).  
EL610D (Vista and Plus).

**H**old the frame on the embedding box.

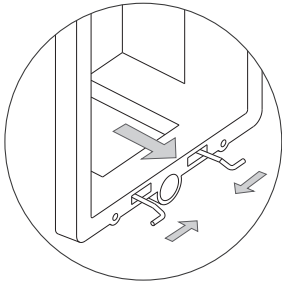

Insert the hinge that it is supplied with the product in the embedding box, as shown in the drawing.

To hold the frame on the embedding box, insert the hinge in the housings arranged for this purpose in the frame, as shown in the drawing.

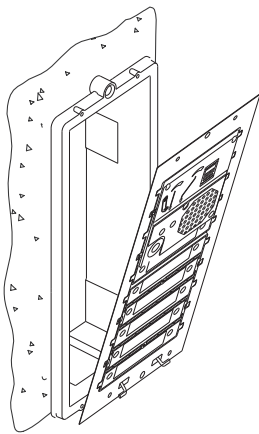

The frame can now be folded horizontally facilitating the connection and adjustments in the sound module and push buttons electronic module.

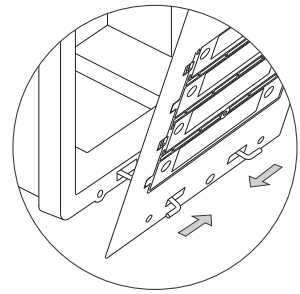

**C**onnection and configuration.

For connection push buttons, nameplate labels, configuration, adjustments and programming, see the manual supplied with the sound module.

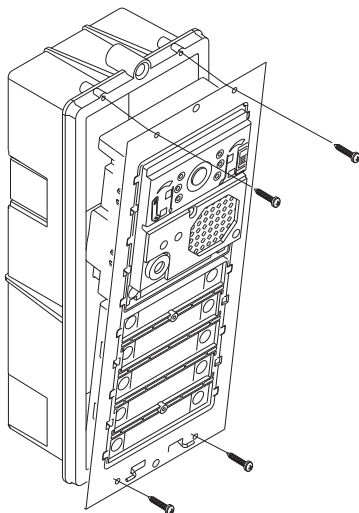

**C**lose the frame.

Once finished the works of wiring, configuration and final adjustments, fix the frame in the embedding box with the supplied screws.

## Door panel assembly.

Insert a header in the lateral rods (at the bottom part) and fix it with the supplied screws (step 1), then insert the module (step 2). If the door panel is more than one module insert first the lower module, see picture (A).

Place the spacer module (step 3) and insert the next module (step 4) see picture (B). Repeat this procedure in case of door panels with one more module (the maximum number of modules placed vertically is three).

To finish insert the second header (step 5) in the lateral rods (at the top part) and fix it with the supplied screws, see picture (C).

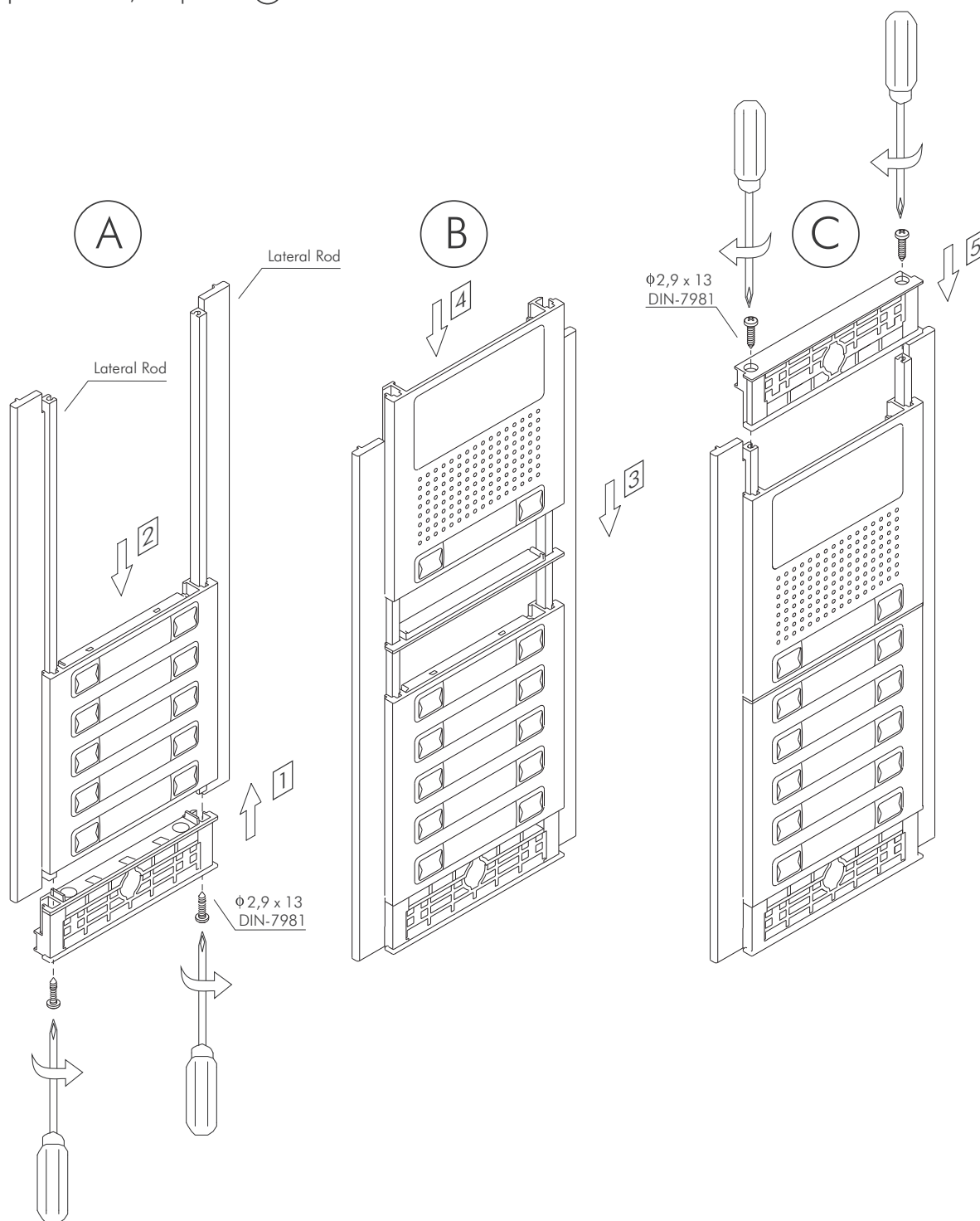

## Double door panel assembly.

Assembly the door panel (A) (step 1), as it is described in page 26 "Door panel assembly". Bear in mind that the rod that will join the door panel (A) and door panel (B) have to be of the type door panel UNE rod, see picture below.

Insert a header between door panel UNE rod and the second lateral rod (at the bottom part) and fix it with the supplied screws (step 2) then insert the module (step 3). If the door panel is more than one module insert first the lower module.

Place the spacer module (step 4) and insert the next module (step 5). Repeat this procedure in case of door panels with one more module (the maximum number of modules placed vertically is three).

To finish insert the last header between door panel UNE rod and the second lateral rod (at the top part) and fix it with the supplied screws (step 6).

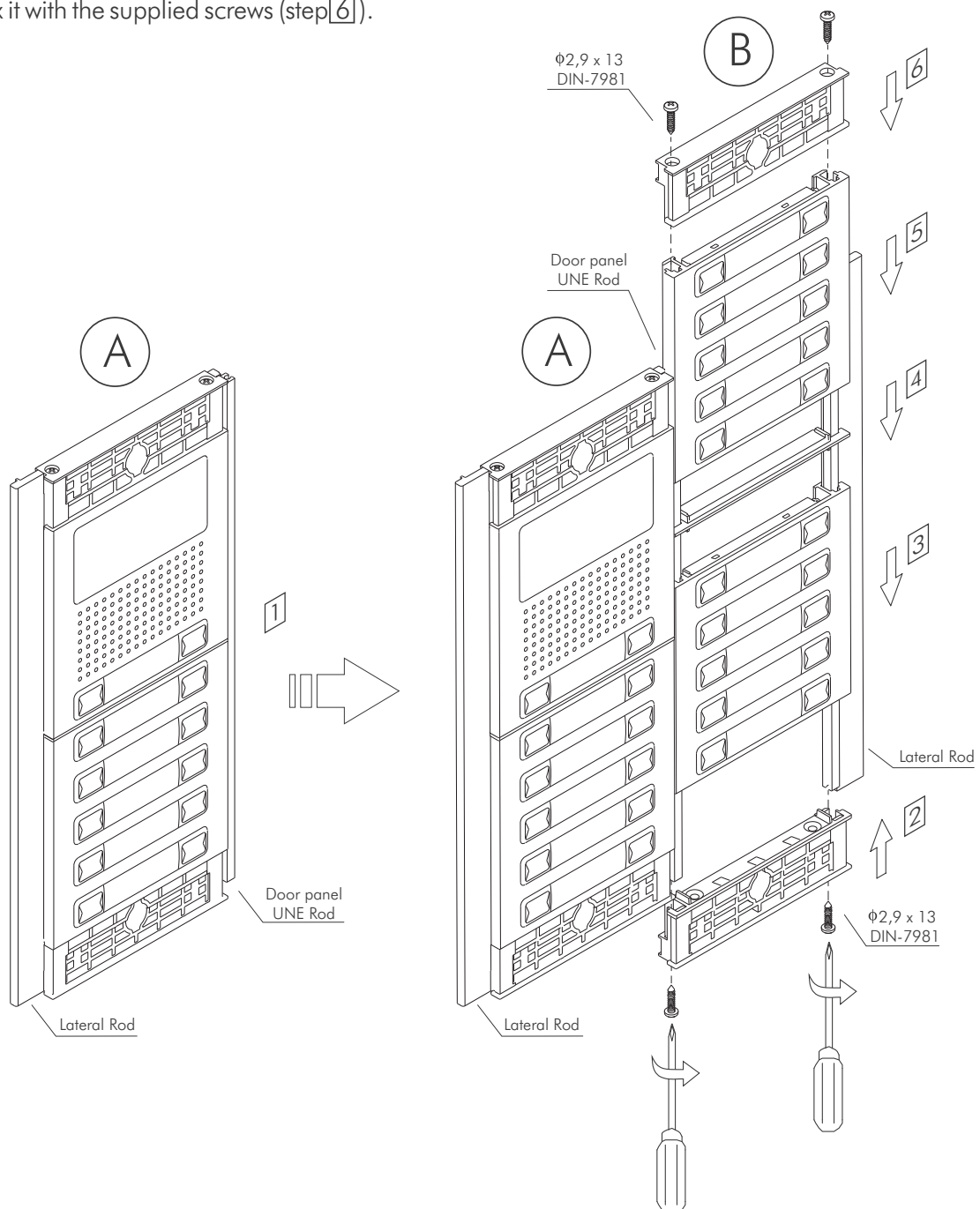

**IMPORTANT:** Once finished the adjustments, stick the adhesive gasket (that it is supplied with the set of closing heads N60XX CMPL) in the door panel UNE rod.



**C**lose the door panel.

fix the door panel in the embedding box with the supplied screws.

Finish the door panel assembly by placing the closing heads, put the head on one side and then make a slight pressure on the other end, to its correct placement.

**Door panel:**

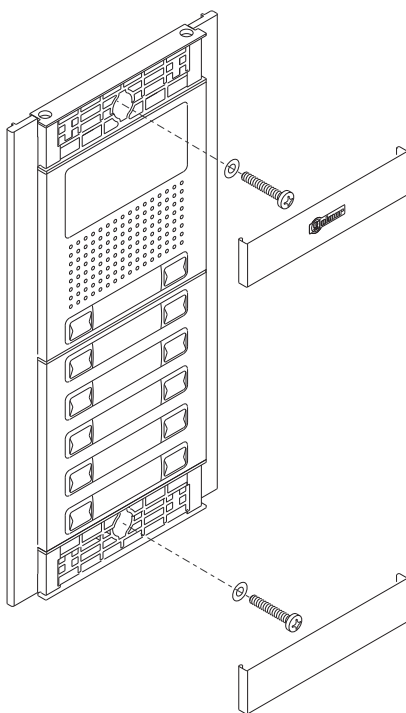

**Double door panel:**

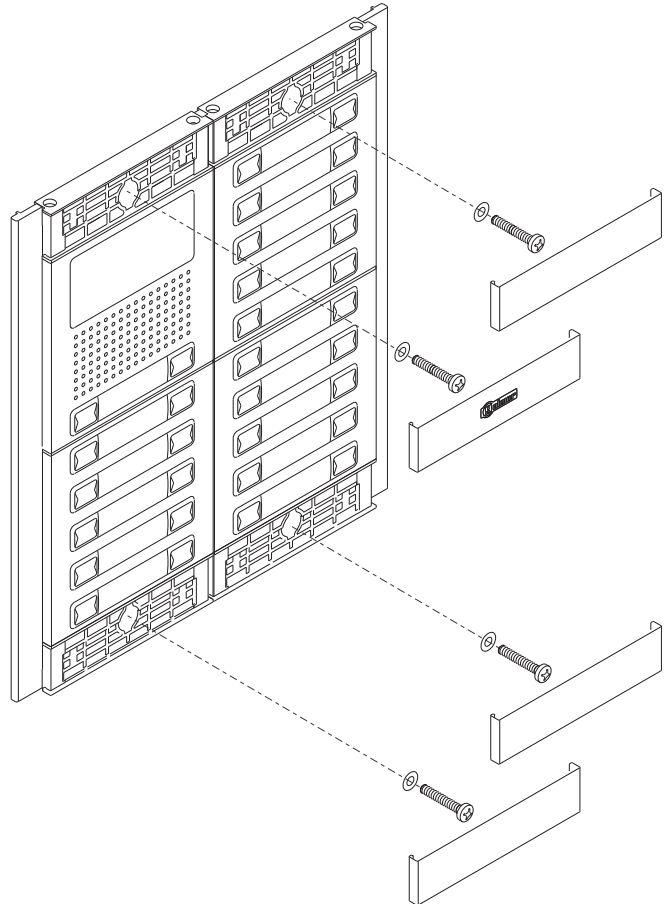

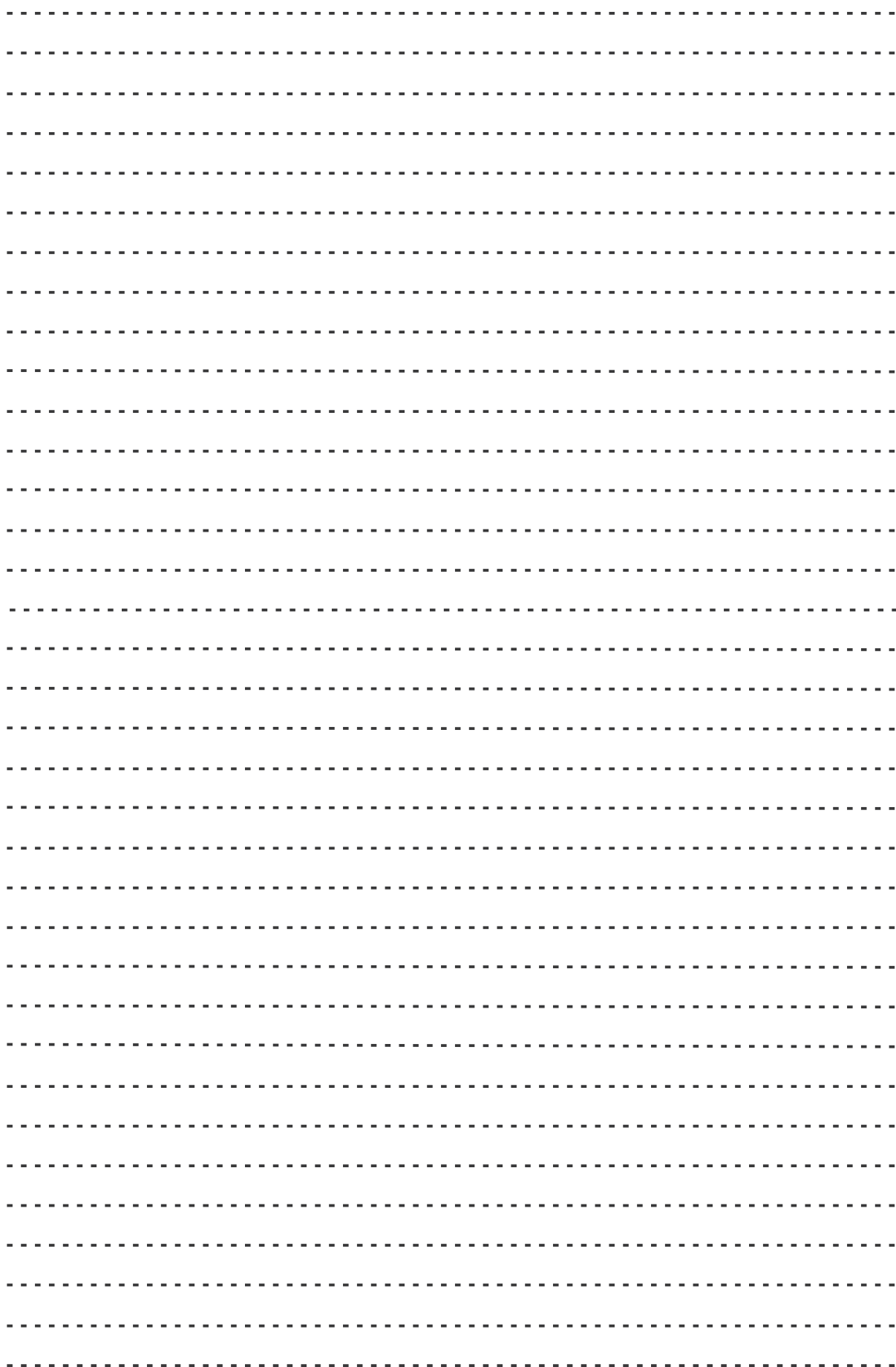
A large rectangular box with a thin black border, containing 30 horizontal dotted lines for writing notes. The lines are evenly spaced and extend across the width of the box.

Handwriting practice area with 30 horizontal dotted lines.



[golmar@golmar.es](mailto:golmar@golmar.es)  
[www.golmar.es](http://www.golmar.es)



Golmar se reserva el derecho a cualquier modificación sin previo aviso.

Golmar se réserve le droit de toute modification sans préavis.

Golmar reserves the right to make any modifications without prior notice.