

# CERAMIC BLADE NO. 65232C

NOW AVAILABLE!

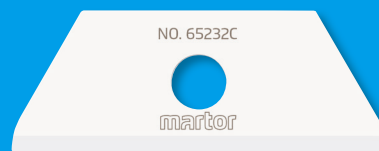

Order number	1765232.25
Blade size (L x W)	49.9 x 19 mm
Material thickness	0.65 mm
Material	High-quality zirconium oxide



LONGER SERVICE  
LIFE THAN STEEL



EXCEPTIONALLY  
SHARP



VERSATILE  
USABLE



SAFE BECAUSE  
OF THE HANDLE

## MARTOR CERAMIC BLADES. TEST FLEXIBLY NOW!

### DURABLE AND SHARP

The new MARTOR ceramic blade impresses with its long service life and long-lasting sharpness. This makes it easier for you to cut a wide variety of materials. Blade changes are rarely necessary.

### VERSATILE USABLE

In addition to its sharpness, the ceramic blade has special chemical and physical properties. This means your MARTOR safety knife is well equipped, even in special situations.

### FLEXIBLE AND SAFE

You can use the ceramic blade flexibly in existing MARTOR handles – as an alternative to the mounted steel blade. The reliable safety technology of your safety knife protects you when cutting. You will also benefit from its comfort and ergonomics.

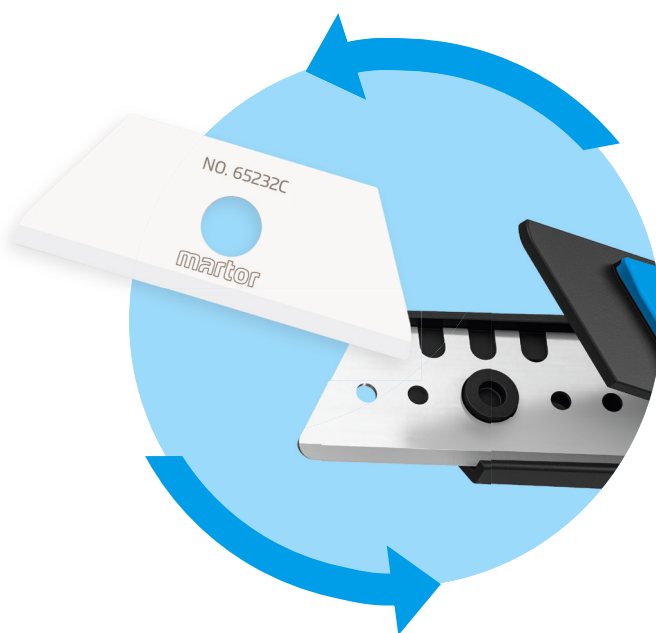

ENJOY SAFETY  
MADE IN SOLINGEN

**martor**

# CERAMIC BLADE NO. 65232C

## TECHNICAL FEATURES



**2-cutting edge blade:**  
for a double period of use



**Rounded-tip trapezoid blade:**  
more protection against  
stab wounds



**2-sided ground-edge:**  
less cutting resistance



**Non-rusting:**  
ideal also in a damp  
cutting environment



**Non-conductive:**  
no transmission of  
electrical potential



**Non-magnetic:**  
no adhesion of  
magnetic particles



**Chemically inert:**  
no reaction with  
other substances



**Non-oiled:**  
no contamination of  
the material to be cut

## SUITABLE FOR THESE MARTOR SAFETY KNIVES



SECUNORM 500



SECUNORM 300



SECUNORM PROFI

## WIDE RANGE OF APPLICATIONS – EXAMPLES



## FLEXIBLE PACKAGING

**+ Suspensible**  
thanks to the practical  
eyelet

**+ Bendable**  
for better storage



Packaging unit (PU)	2 on self-service card
Size PU	84.5 x 5 x 160 mm
Weight PU	16.5 g
EAN Code PU	4002632801747
Customs tariff number	69149000

**+ Separable**  
for a targeted  
distribution

**+ Sustainable**  
made of 100% recyclable  
material

## PLEASE NOTE



**Attention:** The blade is sharp. It may break under extreme pressure. Wear safety glasses. Replace damaged blade immediately. Observe the safety instructions for the knife.

For further information please contact us: MARTOR KG | Lindgesfeld 28 | 42653 Solingen | Germany  
T +49 212 73870-0 | F +49 212 73870-90 | [info@martor.de](mailto:info@martor.de) | [www.martor.com](http://www.martor.com)